



Back Street, North Kilworth, LE17 6HG



Part of
**SHELDON
BOSLEY
KNIGHT**
LAND AND
PROPERTY
PROFESSIONALS

Property Description

An extended five bedroom detached property occupying a corner plot, located in this popular residential village of North Kilworth, offering flexible living accommodation across two floors. .





Key Features

- A Five Bedroomed Detached Property
- Occupying A Corner Position In Popular Village
- Sitting Room With Wood Burning Stove
- Principal & Guest Bedrooms With En-Suites
- Gardens To Front, Side And Rear, Two Garages

Price Guide
£575,000



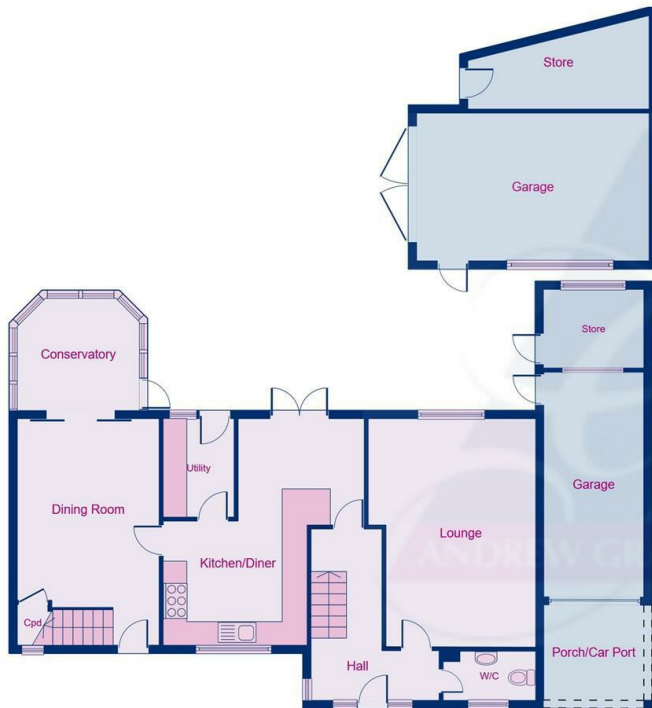

Ground Floor

Floor Area (Gross Internal) 92.6 sq.m. (997 sq.ft.) approx (Excluding garages/stores)



First Floor

Floor Area (Gross Internal) 74.5 sq.m. (802 sq.ft.) approx

Created using Vision Publisher™

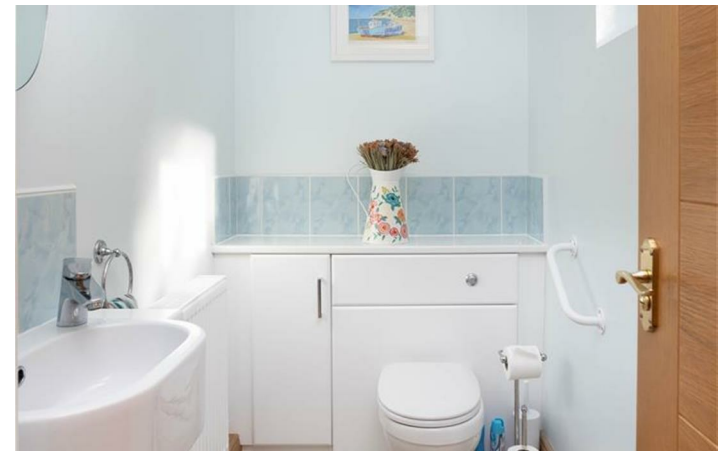

EPC Rating - C

Tenure - Freehold

Council Tax Band - F

Local Authority
Harborough



To view this property please contact our Market Harborough office on 01858 431315



Part of
**SHELDON
BOSLEY
KNIGHT**
LAND AND
PROPERTY
PROFESSIONALS