



FOR SALE
0116 242 9922

VIEW BY
APPOINTMENT
ONLY

Sandhurst Road, Leicester, LE3 9RX



Part of
**SHELDON
BOSLEY
KNIGHT**
LAND AND
PROPERTY
PROFESSIONALS

Property Description

A two bedroom semi-detached house in need of some cosmetic updating. The property benefits from having a gas central heating system and double glazing. The accommodation comprises of entrance hall with stairs off, breakfast kitchen, sitting room. First floor landing, two double bedrooms and family bathroom. Outside: The property has a garden to front, driveway to side and enclosed rear garden. This property must be viewed in person to fully appreciate the accommodation available. There is no upward chain.





Key Features

- Two Bedroom Semi Detached
- Lounge and Breakfast Kitchen
- Off Road Parking
- No Chain
- Close to Local Amenities
- Gas Central Heating
- UPVC Double Glazing
- EPC - D

**Offers In Excess Of
£180,000**



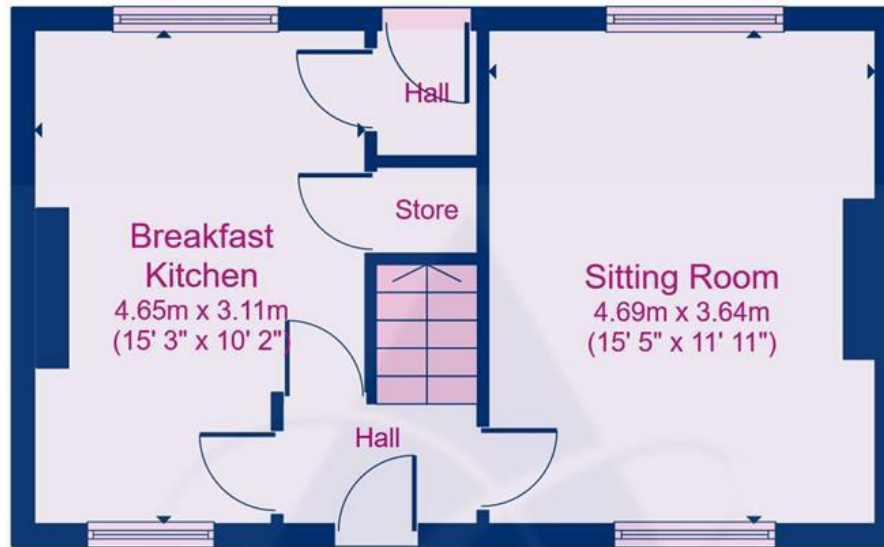

Ground Floor

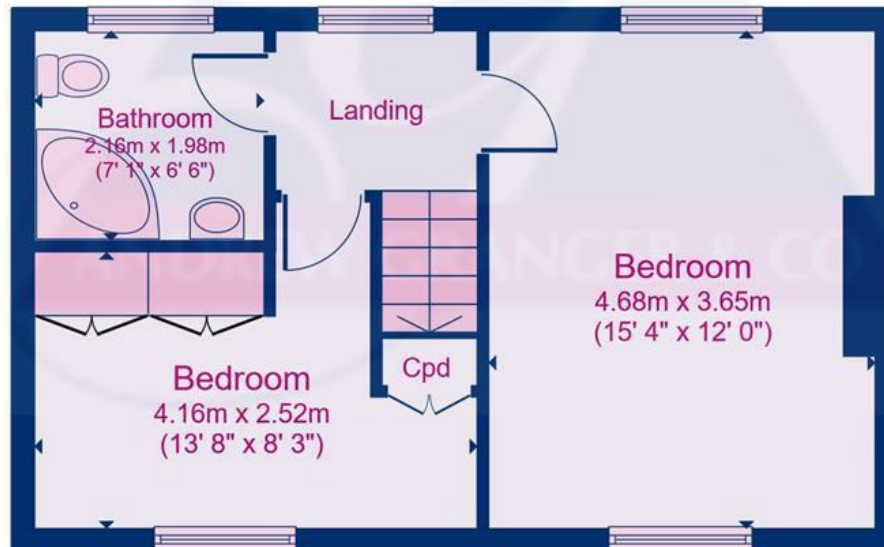

First Floor

Floor plans are for identification purposes only. All measurements are approximate.
Created using Vision Publisher™

Energy Efficiency Rating

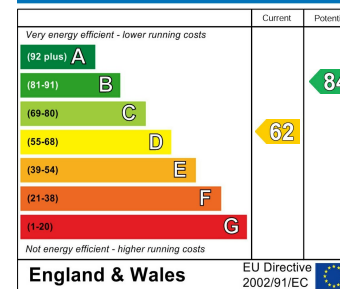

Environmental Impact (CO₂) Rating

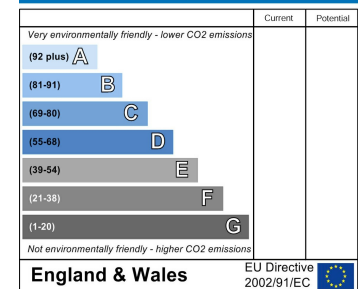

- EPC Rating - D
- Tenure - Freehold
- Council Tax Band - B
- Local Authority
Leicester City Council



To view this property please contact our Oadby office on 01162 429922



Part of
**SHELDON
BOSLEY
KNIGHT**
LAND AND
PROPERTY
PROFESSIONALS