



Beeby Road, Scraptoft, Leicester, LE7 9SH



Part of
**SHELDON
BOSLEY
KNIGHT**
LAND AND
PROPERTY
PROFESSIONALS

Property Description

Located on Beeby Road in the picturesque village of Scraptoft, Leicester. Situated in an elevated position, this extended semi-detached family home presents a fantastic opportunity for those looking to add their personal touch. With the potential for improvement, you can truly make this house your own and create the home of your dreams in the heart of Scraptoft village.

Don't miss out on the chance to own a property in this desirable location with great potential. Contact us today to arrange a viewing and take the first step towards making this house your new home.





Key Features

- EXTENDED 3/4 BEDROOM SEMI-DETACHED FAMILY HOUSE
- THREE FIRST FLOOR BEDROOMS
- GROUND FLOOR BEDROOM FOUR / SNUG
- CLOAKS / W.C & FIRST FLOOR BATHROOM
- THROUGH LOUNGE / DINER & GARDEN ROOM
- LOW MAINTENANCE REAR GARDEN WITH SIZEABLE WORKSHOP
- GARDEN TO FRONT WITH DRIVEWAY
- ELEVATED POSTION
- GAS CENTRAL HEATING WITH COMBINATION BOILER
- SOME COSMETIC WORK REQUIRED

Guide Price
£290,000



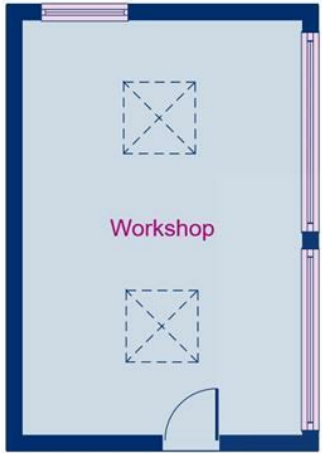

Ground Floor

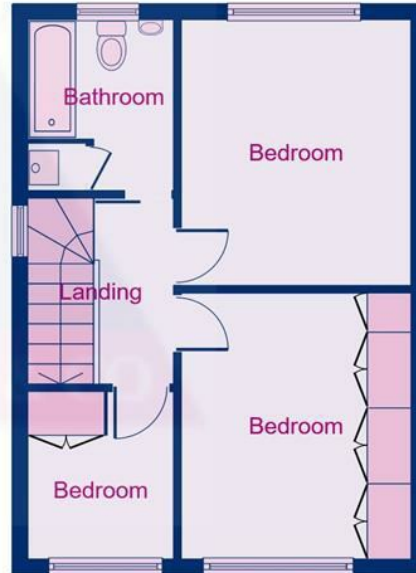

First Floor



EPC Rating - D

Tenure - Freehold

Council Tax Band - C

Local Authority
Harborough District Council



To view this property please contact our Leicester (AG) office on 0116 242 9922



Part of
**SHELDON
BOSLEY
KNIGHT**
LAND AND
PROPERTY
PROFESSIONALS