



20 Kirkwood Grove
Milton Keynes, MK5 6FP



William Coulson
Partnered With
Simpsons
Property Experts

"The Perfect Opportunity..."

...to purchase this impressive one bedroom, top floor apartment, situated just a short walk from local amenities boasting generous proportions, off road parking and the added benefit of a 107 year-remaining lease!

Entrance through the timber front door leading into the inviting entrance hall with access to the airing cupboard.

Kitchen comprising laminate flooring, eye and base level fitted units, work surfaces, a stainless steel one and a half bowl sink, gas hob, oven, washing machine and fridge/freezer.

Open plan living room with a window overlooking Shenley Wood and ample space for a large three seater sofa.

Double sized bedroom with a spacious fitted wardrobe and access to the loft via a hatch

Bathroom comprising continued laminate flooring, ceramic tiled walls and a white three-piece suite to include a low-level WC, a wash hand basin and a panel bath with shower over.

Neatly tucked away within Kirkwood Grove, the property offers an off-road parking space for one car and a well-maintained paved path leads up to the front door.

£159,950



1



1



1



GROUND FLOOR

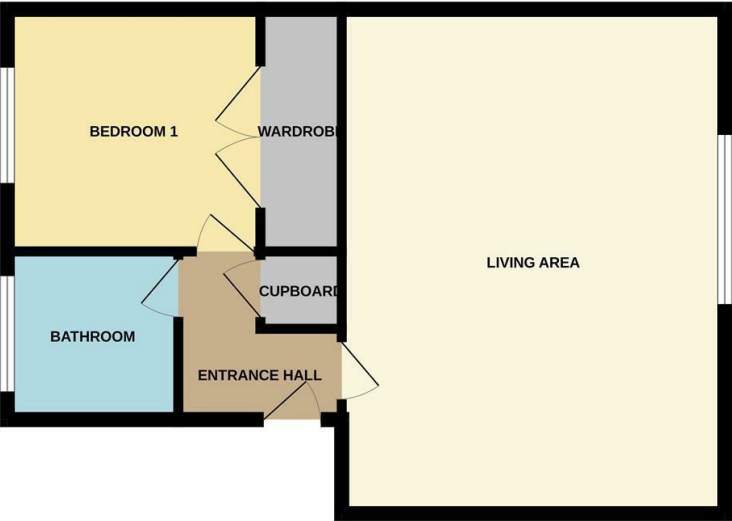

Whilst every attempt has been made to ensure the accuracy of the floor plan contained herein, measurements of doors, windows, rooms and any other items are approximate and no responsibility is taken for any error, omission, or mis-statement. The plan is copyright to Simpson and Partners and is for illustrative purposes and should only be used as such by any prospective purchaser. The services, systems and appliances shown have not been tested and no guarantee as to their operability can be given.
Made with Metreone ©2025.

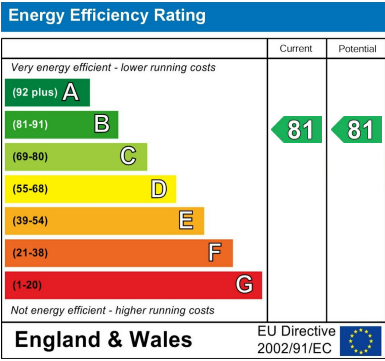



William Coulson
In Partnership With

Simpsons
Property Experts

Tel: 01908 040289

Email: william.coulson@simpsonspropertyexperts.co.uk

Web: <https://simpsonspropertyexperts.co.uk/our-locations/milton-keynes>

