



18 Lawrence Walk
Newport Pagnell, MK16 8RF



William Coulson
Partnered With
Simpsons
Property Experts

"Attention First Time Buyers & Downsizers"

Situated in the popular market town of Newport Pagnell, just a short walk from local amenities, this, this delightful three-bedroom semi-detached house offers a perfect blend of comfort and practicality. The property boasts both front and rear gardens, providing ample outdoor space for relaxation and recreation. Off-road parking and a garage add to the convenience, making this home an ideal choice for families or those seeking extra storage.

Upon entering, you will find a spacious kitchen/dining room that has been thoughtfully refitted. It features modern appliances, including a gas and electric oven, as well as space for a washing machine and dishwasher. The kitchen is designed for both cooking and entertaining, with French doors that open out to a large rear garden, seamlessly connecting indoor and outdoor living.

The well-presented living room is in excellent decorative order, featuring a large window that floods the space with natural light. This inviting area offers plenty of room for your living room furniture, making it a perfect spot for family gatherings or quiet evenings.

The property comprises two generously sized double bedrooms and a good-sized single bedroom, providing ample space for family or guests. The fully tiled family bathroom is equipped with a three-piece suite and a vanity unit with storage, ensuring functionality and style.

The large rear garden is a standout feature, with a substantial lawn area perfect for children to play or for hosting summer barbecues. Gated side access enhances the practicality of the outdoor space, while the garage located in a block, with parking in front, adds further convenience.

This lovely home in Newport Pagnell is not to be missed, offering a wonderful opportunity for comfortable living in a desirable location.

£325,000



3



1



1



GROUND FLOOR

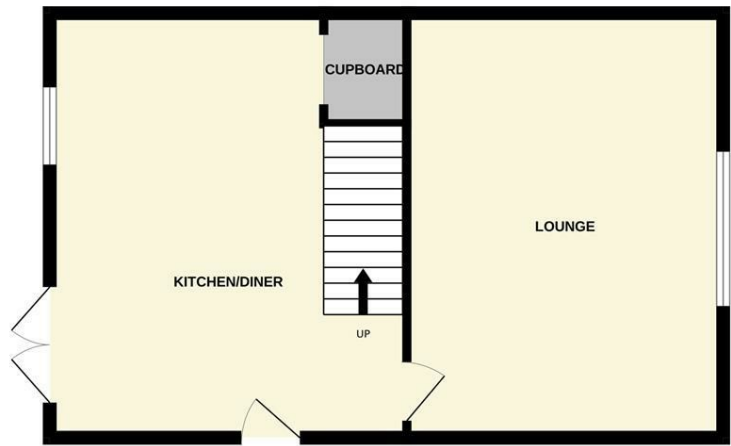

1ST FLOOR

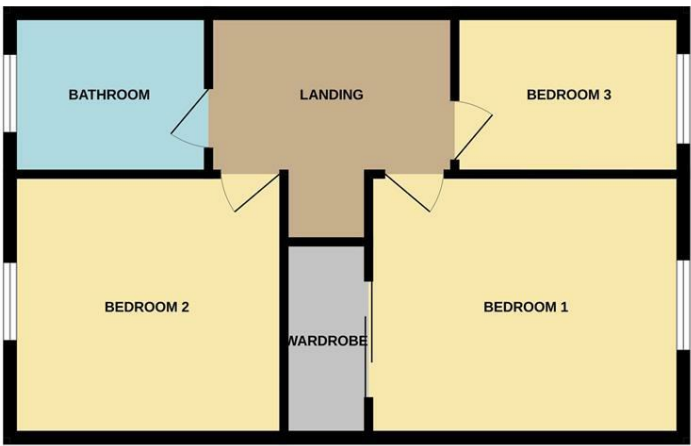

Whilst every attempt has been made to ensure the accuracy of the floor plan contained here, measurements of doors, windows, rooms and any other items are approximate and no responsibility is taken for any error, omission, or mis-statement. The plan is copyright to Simpson and Partners and is for illustrative purposes and should only be used as such by any prospective purchaser. The services, systems and appliances shown have not been tested and no guarantee as to their operability can be given
Made with Metropix ©2025

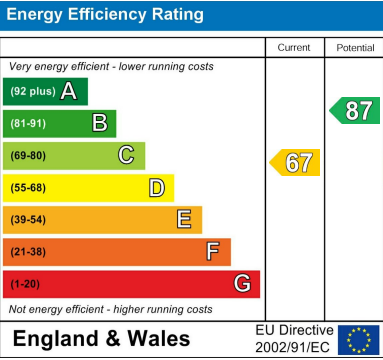



William Coulson
In Partnership With

Simpsons
Property Experts

Tel: 01908 040289

Email: william.coulson@simpsonspropertyexperts.co.uk

Web: <https://simpsonspropertyexperts.co.uk/our-locations/milton-keynes>

