



9 Kings Grove
Bedford, MK43 1AJ



William Coulson
Partnered With
Simpsons
Property Experts

"A Warm Welcome..."

... to this fantastic four bedroom detached home boasting a well presented interior throughout, generous proportions and a delightful south facing rear garden!

As you step inside this lovely detached property, you are greeted by an inviting entrance hall with a convenient utility cupboard and under stairs storage, perfect for keeping everything organised. The living room boasts a beautiful bay window that fills the room with natural light, creating a cosy and welcoming atmosphere for relaxing evenings or entertaining guests.

The kitchen/dining room is a versatile space, complete with integrated appliances, providing the perfect setting for family meals or hosting gatherings with friends. The layout is ideal for those who enjoy cooking and socialising at the same time.

Upstairs, you will find four good-sized bedrooms, offering plenty of space for a growing family or accommodating guests. The master bedroom features an ensuite, providing a private retreat for the lucky homeowner.

Outside, the landscaped garden is a tranquil oasis, offering a peaceful escape where you can unwind and enjoy the fresh air. Whether you have a green thumb or just enjoy outdoor relaxation, this outdoor space is sure to delight.

This property also features a single garage, providing convenient parking or additional storage space for your belongings. Located close to local amenities in Cranfield, you'll enjoy easy access to shops, restaurants, and other services right at your doorstep. For commuters, the nearby A422 offers convenient access to the M1, making travel to nearby cities a breeze.

This delightful property is perfect for those seeking a comfortable and modern lifestyle in a charming town setting. Don't miss the opportunity to make this house your new home sweet home. Contact us today to schedule a viewing and experience the warmth and charm of this wonderful property for yourself.

Offers over £440,000



GROUND FLOOR

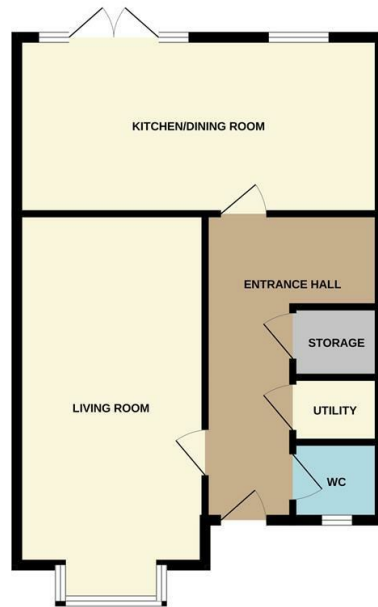

1ST FLOOR



Whilst every attempt has been made to ensure the accuracy of the floor plan contained here, measurements of doors, windows, rooms and any other items are approximate and no responsibility is taken for any error, omission, or mis-statement. The plan is copyright to Simpson and Partners and is for illustrative purposes and should only be used as such by any prospective purchaser. The services, systems and appliances shown have not been tested and no guarantee as to their operability can be given.
Made with Metrease ©2024

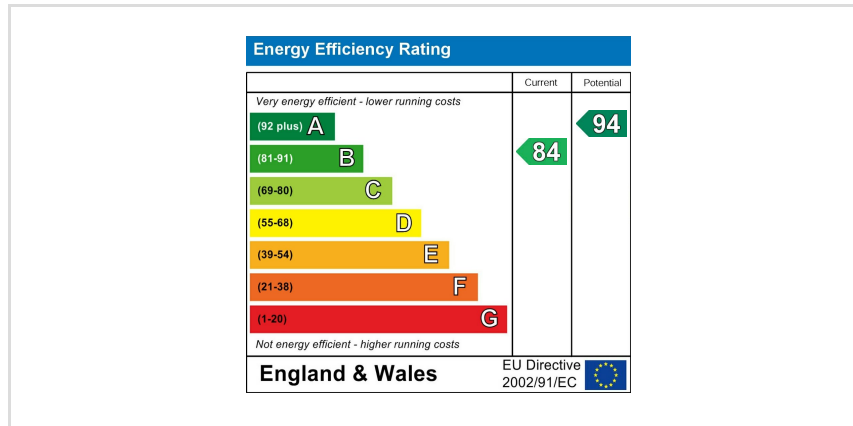



William Coulson

In Partnership With

Simpsons
Property Experts



Tel: 01908 040289

Email: william.coulson@simpsonspropertyexperts.co.uk

Web: <https://simpsonspropertyexperts.co.uk/our-locations/milton-keynes>

