

CHISWICK STUDIOS

9 POWER ROAD, CHISWICK, W4 5PY

STUDIO STYLE OFFICES FROM 530 sq ft up to 11,500 sq ft



Gallery

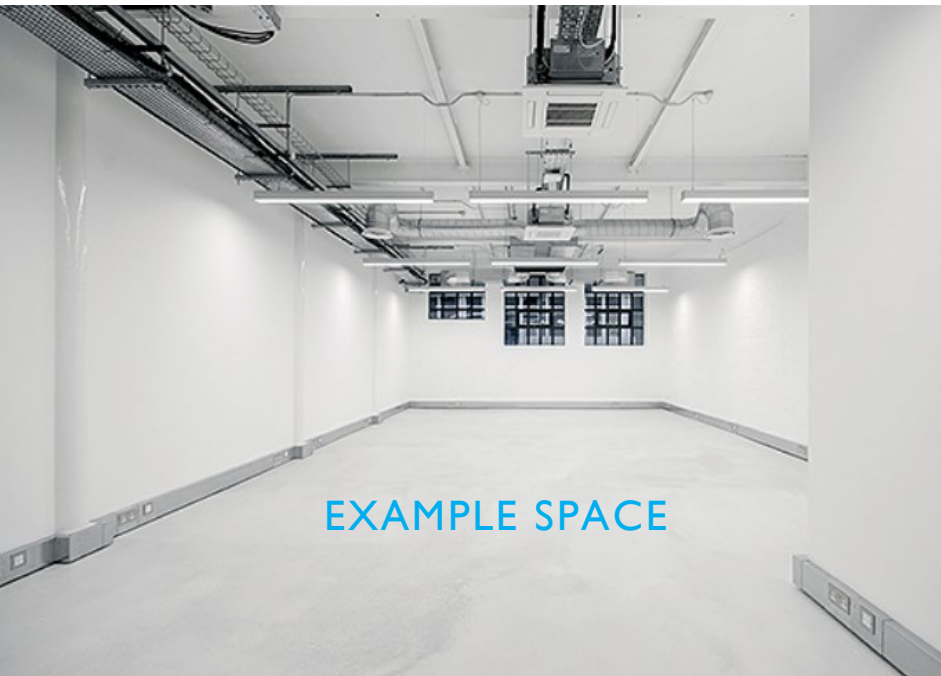

EXAMPLE SPACE

Amenities

- Bureau facilities
- Parking
- Centre manager
- 24 hr access
- Wi-Fi
- Recycling facilities
- Showers
- Meeting rooms

Misrepresentation Act 1967: These particulars are believed to be correct but their accuracy is not guaranteed and they do not form part of any contract. Unless otherwise stated, all prices and rents are quoted exclusive of VAT



Local amenities

- | | |
|----------------|--------------------------------|
| 4. Cooperative | 1. Bills Restaurant |
| 5. Sainsburys | 2. Marks & Spencer's |
| 6. Waitrose | 3. High Road House - Brasserie |

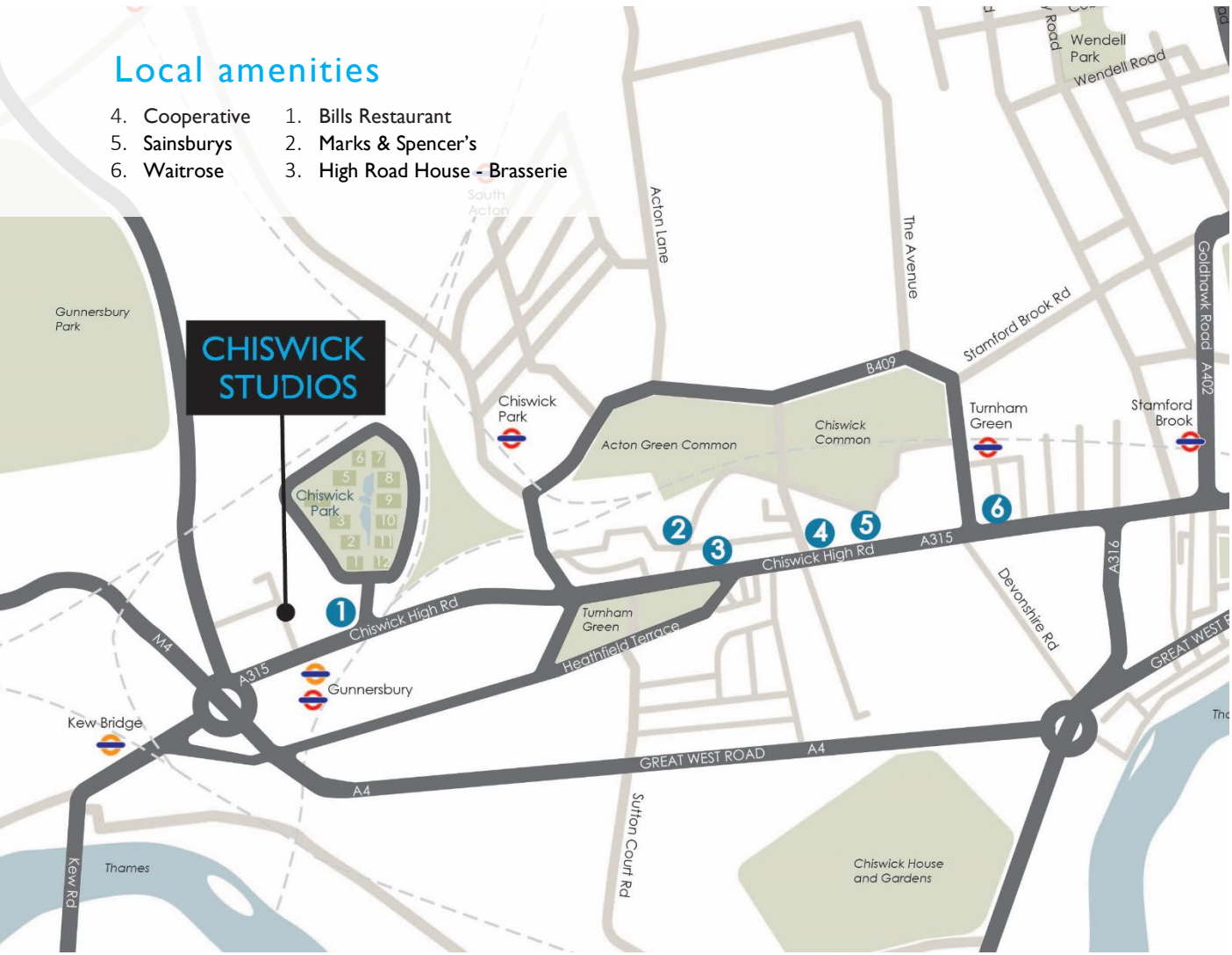

A Great Space & Location

Chiswick Studios is known for its art-deco façade and striking building design, with the interior boasting spacious modern lofty studios.

Benefitting from 24-hour access, parking and on-site showers, and being just a 3-minute drive from Chiswick Roundabout and the M4 with great links to central London, Chiswick Studios is an ideal base for your business. Also situated close to the TV and production studios of West London, Chiswick Studios has a broad range of entrepreneurial talent right on its doorstep.

Close to the Thames, as well as the many open spaces in the area, such as Gunnersbury Park and the prestigious Royal Botanic Gardens at Kew, Gunnersbury boasts a desirable location for fitness fanatics and food lovers alike, with incredible coffeshops, bars, and restaurants on nearby Chiswick High Road.

Accommodation

LARGE STUDIO STYLE UNIT

FLOOR	SIZE	Desks	Rent pcm
Ground	4,370 sq ft	50 - 75 people	£13,610
Ground	4,402 sq ft	55- 75 people	£13,700
Ground	2,876 sq ft	35 - 50 people	£9,790

*Rent: inclusive of rent, electricity, service charge Rates, to be confirmed with local authority.

SMALL STUDIO STYLE UNIT

The office space ranges from 530 sq ft (up to 12 people) contact agent for current availability and upcoming spaces.

Terms

Studios are available on a 2 year lease with rolling break options subject to 6 months' notice.

Contact

Jack Realey / Giles Harker
jrealey@frostmeadowcroft.com
gharker@frostmeadowcroft.com
www.frostmeadowcroft.com

Public transport connections include

Gunnersbury Underground & Overground Station (Hammersmith & City and Circle lines)	11 mins walk
Kew Bridge Overground Station (National rail)	18 mins walk

**frost
meadowcroft**
020 8748 1200

