



Paddockhall Road

Haywards Heath, RH16 1HL

Asking price £375,000

This first floor property is a spacious two bedroom, two bathroom apartment with parking and is situated at the back of the development. The Oaks is conveniently located in the much sought after Paddockhall Road, within short walking distance to both Haywards Heath railway station and town centre. It comes with one allocated off-road parking space.

A wide choice of restaurants can be found nearby in The Broadway. The Dolphin Centre provides excellent leisure facilities with its swimming pool, badminton, squash courts and gym. Victoria Park has an outside gym, children’s play area, skateboard park and tennis courts.



- Long Lease
- Two Bathrooms
- Close To Train Station
- First Floor
- Parking
- EPC = B

Energy Efficiency Rating		
	Current	Potential
Very energy efficient - lower running costs		
(92 plus) A		
(81-91) B		
(69-80) C		
(55-68) D		
(39-54) E		
(21-38) F		
(1-20) G		
Not energy efficient - higher running costs		
	85	85
England & Wales		
EU Directive 2002/91/EC		

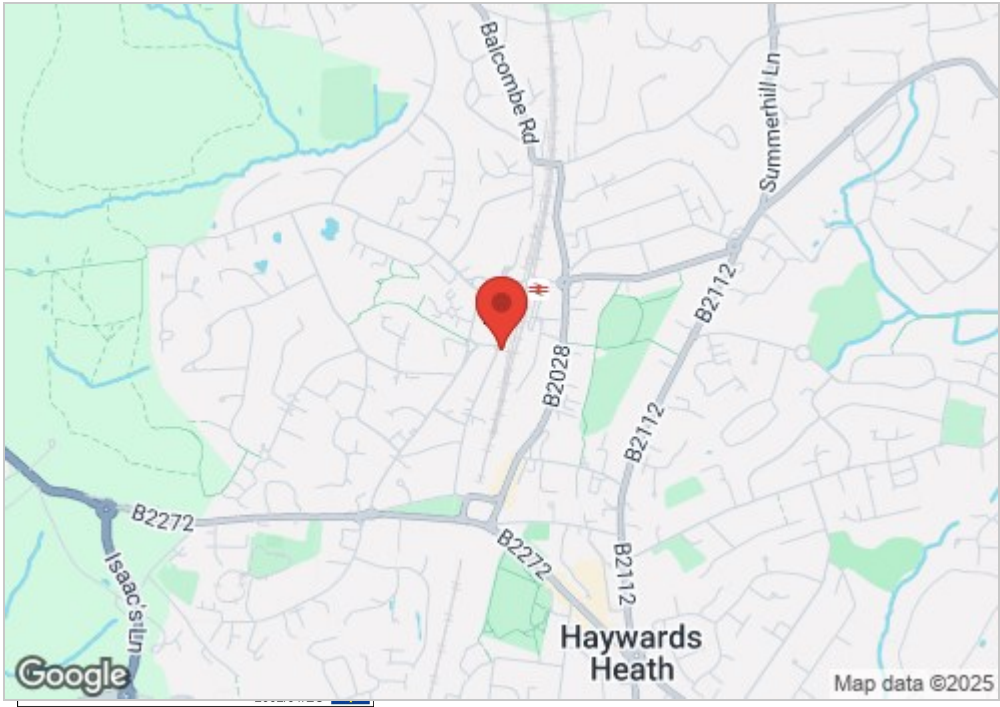

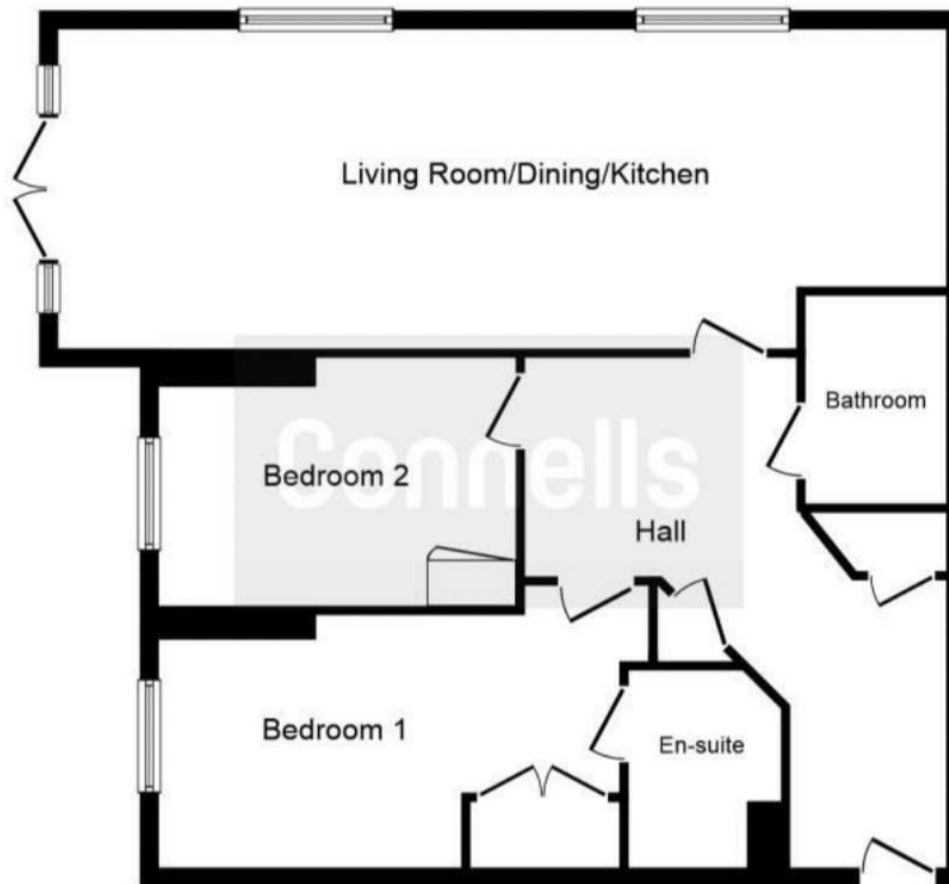

Floor Plan

Foster & Co and their clients give notice that:

These sales particulars do not constitute any part of an offer of contract and are for guidance for prospective purchases only and should be not relied upon as a statement of fact.

We are not to be held responsible for material information that has not been given to us by our client at the time of marketing.

All measurements are approximate

