



2, Trimbush Way | | Market Harborough | LE16 7YH

Price £96,000

FAULKNER MADDEN

FM Residential | SO Moves

## Key features

- Shared Ownership 60%
- Monthly Rent £353.95
- Monthly Service Charge £751.00
- Assisted Living and Support
- Exclusively Available for Aged Over 70 (60 if one party is over 70)
- Prime Location

## Description

Discover your perfect retirement sanctuary in Market Harborough through shared ownership. This delightful ground-floor apartment at 2 Trimbush Way is exclusively designed for those aged 60 and above, blending modern comforts with a vibrant, supportive community. Constructed in 2019 by the reputable McCarthy & Stone, this 591-square-foot residence boasts a contemporary layout, newly decorated interiors, and is ready to move into straight away.

Step inside to find a bright and airy reception room, where double doors open onto a private, covered terrace—perfect for enjoying your morning coffee or relaxing in the fresh air. The spacious double bedroom offers a peaceful retreat, while the well-appointed bathroom caters to all your daily needs.

Nestled in a convenient location with easy access to local amenities, shops, and transport links, this thoughtfully designed home is the perfect choice for those seeking comfort, companionship, and convenience in retirement.

## Directions

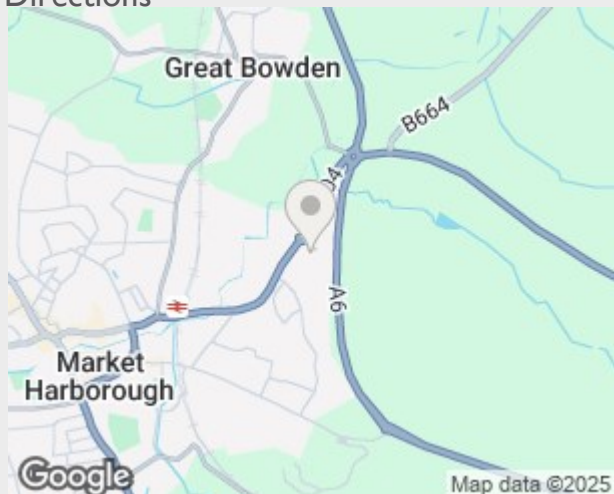



## Shared Ownership Eligibility Criteria

To qualify for a Shared Ownership home, you must:

Be at least 18 years old.

Have an annual household income below £80,000 (outside London) or £90,000 (in London).

Not own another home or be in the process of selling one.

Be unable to afford a suitable home on the open market.

Not be in mortgage or rent arrears.

Have a good credit history and be able to afford the regular payments and costs involved.

### Heylo Housing Application Requirements

When applying to Heylo Housing, you must provide:

A Budget Planner completed by an Independent Financial Advisor (IFA).

Photo ID (passport, driving licence, or national ID) for all applicants.

A recent utility bill, bank, or credit card statement (dated within the last 3 months) for all applicants.

3 months of payslips.

3 months of bank statements.

Proof of deposit funds.

A mortgage decision in principle or a completed Independent Mortgage Advisor (IMA) form.

Permission for Heylo Housing to run a hard credit search on your file.



Elizabeth Place, Trimbush Way, Market Harborough, LE16

Approximate Area = 592 sq ft / 55 sq m  
For identification only - Not to scale

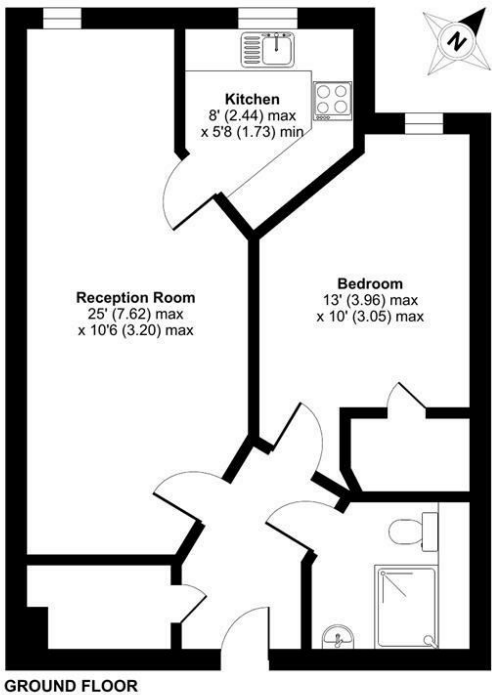

Floor plan produced in accordance with RICS Property Measurement Standards incorporating International Property Measurement Standards (IPMS2 Residential). © nichecom 2024. Produced for So Moves. REF: 1209900

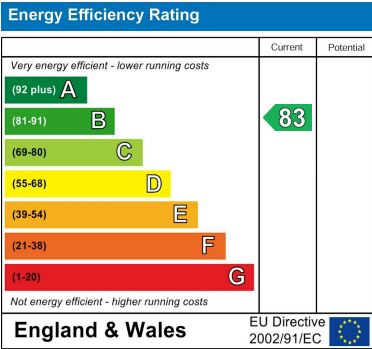

FAULKNER MADDEN

FM Residential | SO Moves

85 Great Portland Street  
London  
W1W 7LT  
02045 519027  
contact@somoves.co.uk  
somoves.co.uk