



A three bedroom penthouse apartment set within an exclusive development
Uxbridge Road, Pinner, HA5 3LW

ROBSONS

Asking Price: £2,400 pcm

A three bedroom penthouse apartment set within an exclusive development

Uxbridge Road, Pinner, HA5 3LW

• VIDEO ENTRY SYSTEM • LIVING ROOM • KITCHEN • THREE BEDROOMS - MAIN WITH ENSUITE SHOWER • STUDY/THIRD BEDROOM • FAMILY BATHROOM • PRIVATE BALCONY • SECURE ALLOCATED PARKING • UNFURNISHED

Description

A three bedroom two bathroom penthouse apartment set within an exclusive development of 26 luxury apartments situated in a commanding central location and conveniently located between Pinner and Hatch End. The property comprises of entrance hallway, two bedrooms, master with ensuite shower room, study/third bedroom, open plan kitchen, dining area & lounge with access to a private balcony. The property is offered unfurnished with secure allocated parking.

**** An advance reservation payment of one weeks rent is required to secure the property ****

Location

Both Pinner and Hatch End can be found within a few moments from the development offering a variety of boutique shops, restaurants, coffee houses and popular supermarkets. Transport facilities include local bus links, the underground Metropolitan Line at Pinner station and the overground line at Hatch End Station, providing a fast and frequent service into Central London and beyond. The area is also well served for Schooling and recreational facilities.





Additional Information

- Local Authority: London Borough of Harrow
- Council Tax Band: F
- Deposit Amount: £2,769.00
- Reservation Payment: One weeks rent
- Energy Efficiency Rating: Band B
- Available Date: 06/02/2026



Pinner Green, Pinner
Approximate Gross Internal Area
1095 Sq Ft/102 Sq M
Balcony external area = 81 Sq Ft/8 Sq M

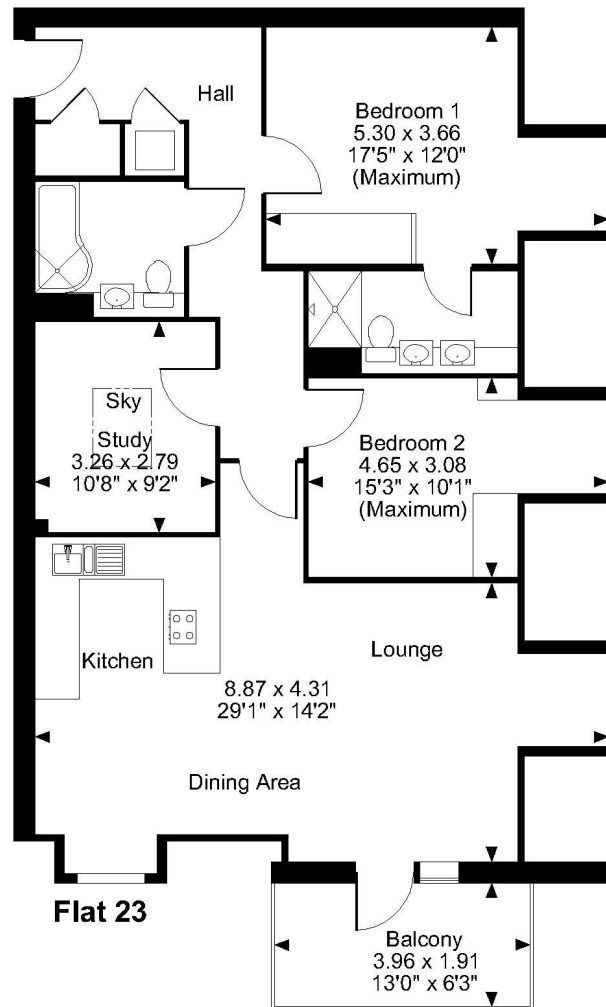

FOR ILLUSTRATIVE PURPOSES ONLY - NOT TO SCALE

The position & size of doors, windows, appliances and other features are approximate only.
© ehouse. Unauthorised reproduction prohibited. Drawing ref. dig/8478777/SS

