



A two bedroom ground floor apartment set within an exclusive development
Uxbridge Road, Pinner, HA5 3LW

ROBSONS

Asking Price: £1,800 pcm

A two bedroom ground floor apartment set within an exclusive development

Uxbridge Road, Pinner, HA5 3LW

• GROUND FLOOR APARTMENT • OPEN PLAN KITCHEN/LOUNGE • TWO BEDROOMS • BATHROOM • VIDEO ENTRY SYSTEM • PRIVATE PATIO • FITTED WARDROBES • SECURE ALLOCATED PARKING • UNFURNISHED

Description

A two bedroom ground floor apartment set within an exclusive development situated in a commanding central location and conveniently located between Pinner and Hatch End. The property comprises of hallway with storage cupboard, two bedrooms, bathroom and open plan kitchen/lounge area. The property is offered unfurnished with private patio & secure allocated parking.

**** An advance reservation payment of one weeks rent is required to secure this property****

Location

Both Pinner and Hatch End can be found within a few moments from the development offering a variety of boutique shops, restaurants, coffee houses and popular supermarkets. Transport facilities include local bus links, the underground Metropolitan Line at Pinner station and the overground line at Hatch End Station, providing a fast and frequent service into Central London and beyond. The area is also well served for Schooling and recreational facilities.





Additional Information

- Local Authority: London Borough of Harrow
- Council Tax Band: E
- Deposit Amount: £2,076.00
- Reservation Payment: One weeks rent
- Energy Efficiency Rating: Band B
- Available Date: 19/04/2024

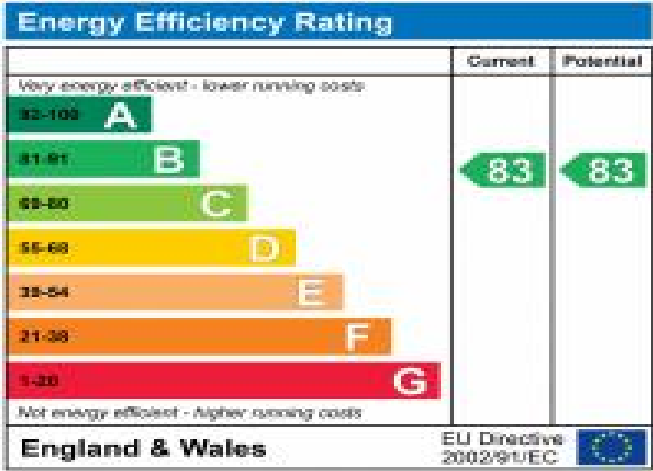

Pinner Green, Pinner
Approximate Gross Internal Area
705 Sq Ft/66 Sq M

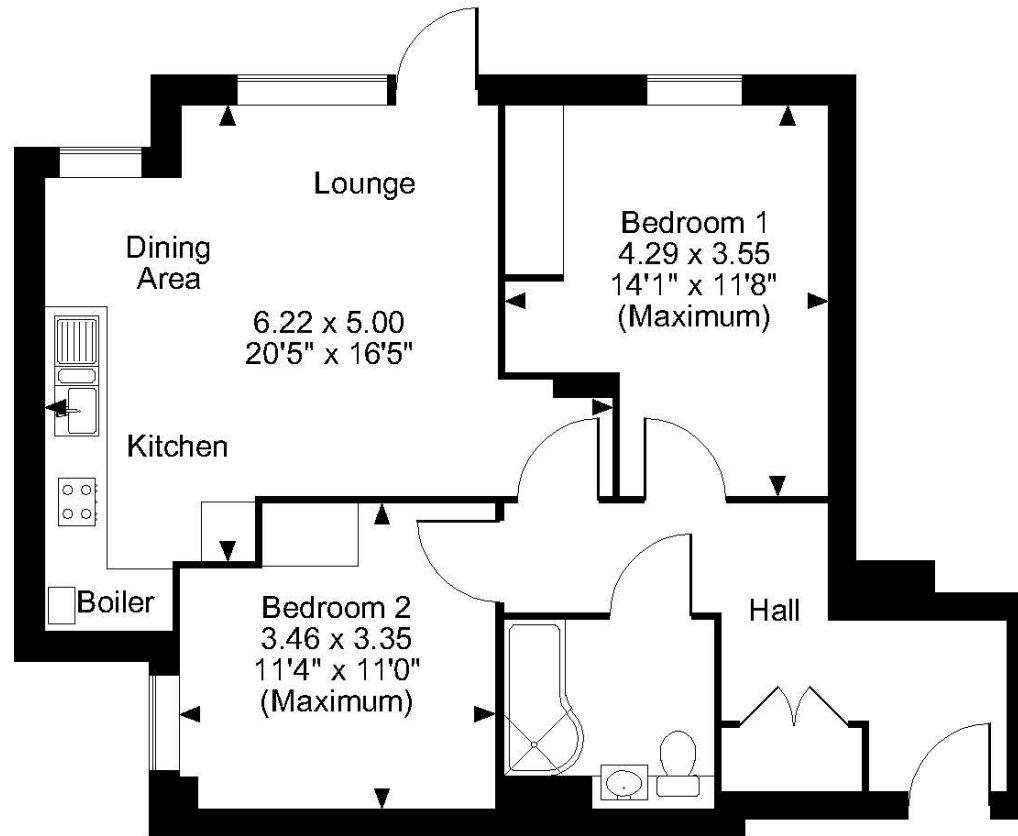

Flat 4

FOR ILLUSTRATIVE PURPOSES ONLY - NOT TO SCALE

The position & size of doors, windows, appliances and other features are approximate only.

© ehouse. Unauthorised reproduction prohibited. Drawing ref. dig/8478777/SS

