



Plantation Drive, Sutton Coldfield - B75 7JQ

£250,000



MOORHOUSE



Plantation Drive

Sutton Coldfield

Tucked away in a highly popular modern development, this impeccably presented two bedroom end-of-terrace property offers a perfect blend of comfort and style. Ideal for first-time buyers seeking a charming home in a sought-after location, this residence is a true gem.

A fantastic location with Withy Hill Park on your doorstep and close to the excellent shopping of both Mere Green and Sutton Coldfield town centre.

THE PROPERTY....

Upon entering, one is greeted by a generously proportioned living room, exuding warmth and character. The heart of the home, a full-width kitchen/diner, awaiting culinary and entertaining adventures. The ground floor also feature a guest WC, providing utmost convenience.

Moving upstairs, two well-appointed bedrooms offer serene retreats, while the bathroom promises relaxation after a long day. Completing the home's appeal, a driveway ensures parking convenience for homeowners and visitors alike.





Plantation Drive

Sutton Coldfield

The allure of this property extends beyond its interiors to the enchanting outside space that surrounds it. The rear garden, a private oasis of greenery, offers a canvas for outdoor living, be it relaxing moments on a sunny day or alfresco gatherings under the stars. Imagine starting your day with a cup of coffee in the fresh air or unwinding in the evenings surrounded by the calming beauty of your own garden. The peace and privacy that this outside space provides make it a true sanctuary in the midst of a modern urban setting.

Lovely interiors and outdoor appeal, this home is waiting to be discovered. To fully appreciate this property, viewing is highly recommended.





FEATURES:

- Two bedrooms & Bathroom
- Highly popular modern development
- Well presented throughout
- Spacious living room & guest Wc
- Full width kitchen/diner
- Driveway
- Rear garden
- Ideal first time buyer purchase
- Viewing recommended

INTERESTED?

fouroaks@moorhouse-property.co.uk

0121 308 3355



GROUND FLOOR
30.8 sq.m. (331 sq.ft.) approx.

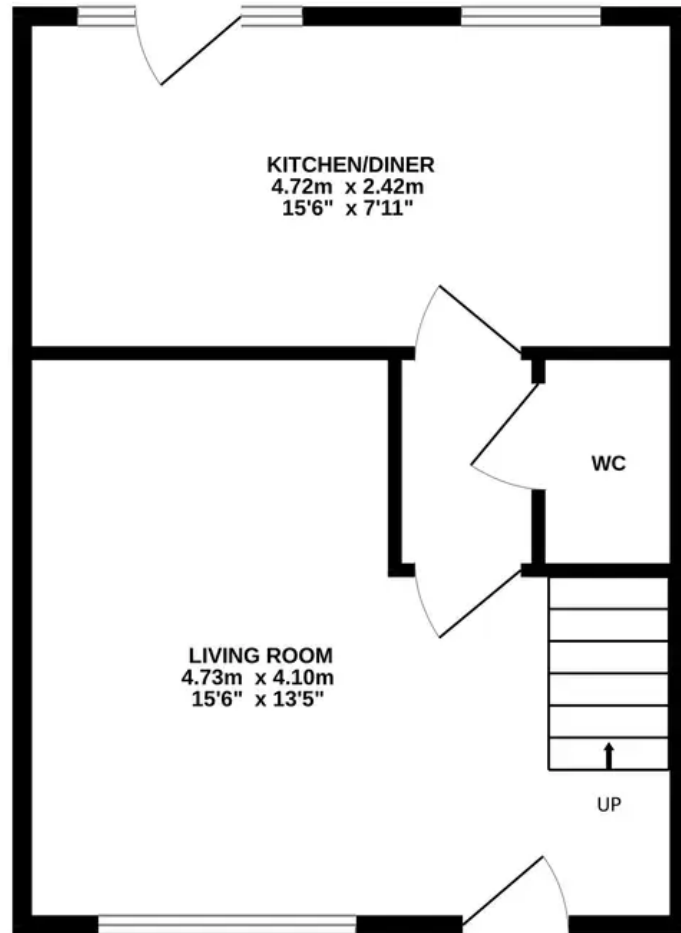

1ST FLOOR
30.8 sq.m. (331 sq.ft.) approx.

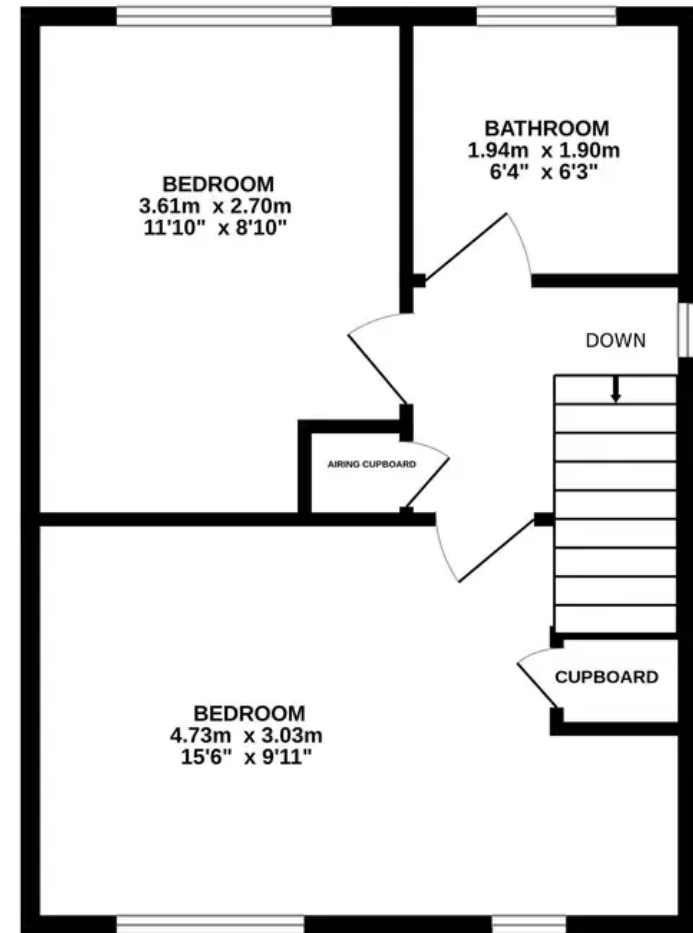

TOTAL FLOOR AREA : 61.5 sq.m. (662 sq.ft.) approx.

Whilst every attempt has been made to ensure the accuracy of the floorplan contained here, measurements of doors, windows, rooms and any other items are approximate and no responsibility is taken for any error, omission or mis-statement. This plan is for illustrative purposes only and should be used as such by any prospective purchaser. The services, systems and appliances shown have not been tested and no guarantee as to their operability or efficiency can be given.

Made with Metropix ©2024

