



Plantation Drive, Sutton Coldfield - B75 7JQ

£250,000

 **MOORHOUSE**



19 Plantation Drive

Sutton Coldfield

This superb two bedroom mid-terraced property presents a wonderful opportunity for first-time buyers looking for a stylish and comfortable home and is situated in a highly sought after modern development.

A wonderful location with Withy Hill Park on your doorstep and close to the excellent shopping of both Mere Green and Sutton Coldfield town centre.

THE PROPERTY....

Upon entering, you are greeted by a welcoming entrance hall that leads to the beautifully presented and spacious living room, ideal for relaxation or entertaining guests, while the full-width kitchen/diner offers a perfect setting for family meals or dinner parties. The ground floor also features a convenient WC, enhancing the practicality of the living space.



Moving upstairs, the property showcases two inviting bedrooms that promise peaceful nights' rest. A luxurious bathroom completes the upper level, offering a touch of elegance to the residence. Additionally, a driveway provides off-road parking, ensuring convenience for homeowners and visitors alike.



Plantation Drive

Sutton Coldfield

Stepping outside, the property reveals a delightful rear garden with a decked seating area, perfect for soaking up the sunshine with a morning coffee or enjoying al fresco dining with loved ones. This outdoor space offers a retreat from the hustle and bustle of daily life. With the garden presenting an opportunity for green-fingered enthusiasts to exercise their gardening skills, the property truly offers a well-rounded living experience.

Boasting a harmonious blend of interior comfort and outdoor appeal, this home is a true gem waiting to be discovered. To truly appreciate the unique charm and character of this property, viewing is highly recommended.







FEATURES:

- Two bedroom home
- Highly popular modern development
- Beautifully presented
- Spacious living room
- Full width kitchen/diner
- Luxury bathroom
- Driveway
- Rear Garden
- Perfect first time buyer purchase
- Viewing recommended

INTERESTED?

fouroaks@moorhouse-property.co.uk

0121 308 3355



GROUND FLOOR
30.6 sq.m. (330 sq.ft.) approx.

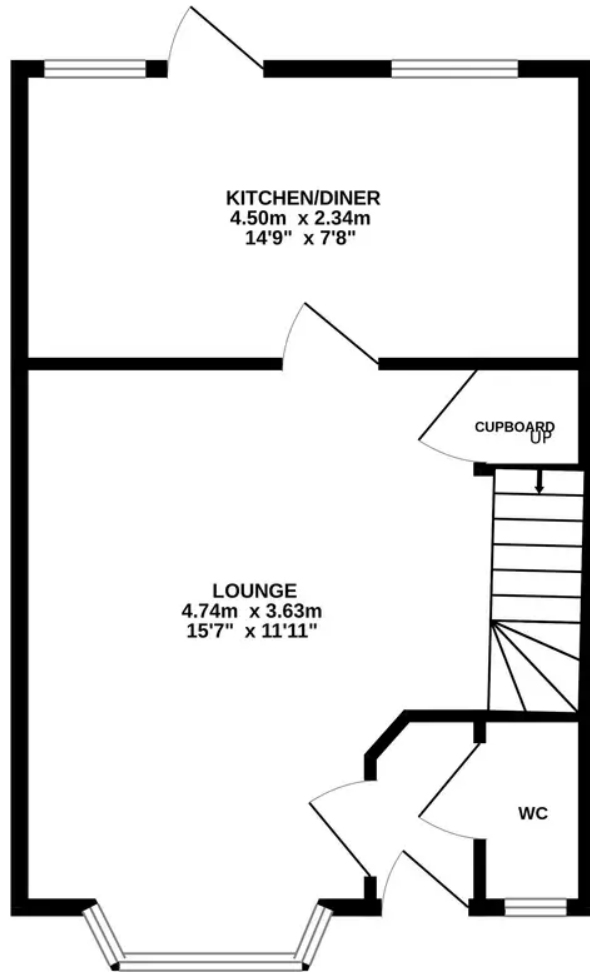

1ST FLOOR
29.1 sq.m. (313 sq.ft.) approx.

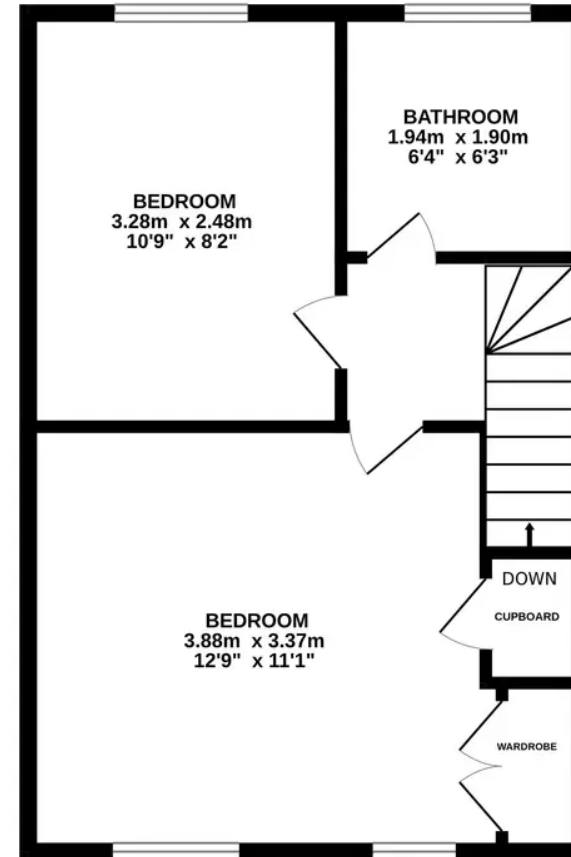

TOTAL FLOOR AREA : 59.8 sq.m. (643 sq.ft.) approx.

Whilst every attempt has been made to ensure the accuracy of the floorplan contained here, measurements of doors, windows, rooms and any other items are approximate and no responsibility is taken for any error, omission or mis-statement. This plan is for illustrative purposes only and should be used as such by any prospective purchaser. The services, systems and appliances shown have not been tested and no guarantee as to their operability or efficiency can be given.
Made with Metropix ©2024

