



GINGER COW
ESTATE AGENTS

01234 860215

West End Road, Silsoe

£550,000

3 2

Discover this enchanting Grade II listed thatched cottage, steeped in history since 1650 and tucked away on a tranquil lane in the sought-after village of Silsoe. Full of character and charm, the property beautifully fuses period features—like exposed beams, a bread oven, and cast iron fireplace—with modern comforts including a refitted kitchen, stylish bathrooms, and generous living spaces.

With three delightful bedrooms, stunning gardens, ample parking, and excellent commuter links via Flitwick station (just 4.5 miles away), this is countryside living at its finest. The picturesque Porcelain patio and peaceful surroundings offer the perfect escape from the everyday.

Heritage meets comfort – book your viewing today and experience the magic of Silsoe living.



Floor Area: 1389 sq. ft.

Tenure: Freehold

Service Charge: £0 per annum

Ground Rent: £0 per annum



Ground Floor
Floor area 61.0 sq.m. (657 sq.ft.)

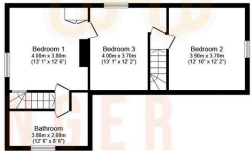

First Floor
Floor area 55.9 sq.m. (601 sq.ft.)

Total floor area: 116.9 sq.m. (1,258 sq.ft.)

This floor plan is for illustrative purposes only. It is not drawn to scale. Any measurements, floor areas (including any total floor area), openings and orientations are approximate. No details are guaranteed, they cannot be relied upon for any purpose and do not form any part of any agreement. No liability is taken for any error, omission or misstatement. A party must rely upon its own inspection(s). Powered by www.propertybox.co.uk



GINGER COW
ESTATE AGENTS

01234 860215