



GINGER COW
ESTATE AGENTS

01234 860215

35 Harrier Leys, Wixams

£350,000

3 3

This charming three-bedroom, two bathroom semi-detached property in a peaceful neighborhood offers a welcoming reception room, a modern kitchen, and a delightful garden, making it an ideal home for families and couples seeking comfort, community, and convenience near schools, amenities, and green spaces.



Floor Area: sq. ft.

Tenure: Freehold

Service Charge: £ per annum

Ground Rent: £ per annum

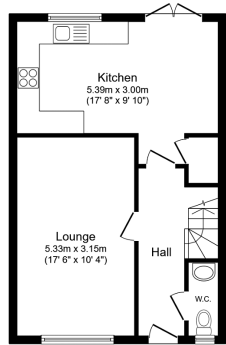

Ground Floor
Floor area 45.4 m² (489 sq.ft.)

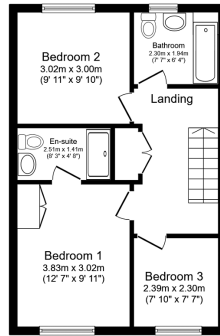

First Floor
Floor area 45.5 m² (490 sq.ft.)

TOTAL: 90.9 m² (979 sq.ft.)

This floor plan is for illustrative purposes only. It is not drawn to scale. Any measurements, floor areas (including any total floor area), openings and orientations are approximate. No details are guaranteed. Buyer advised to refer upon to any professional to verify form any part of any agreement. No liability is taken for any error, omission or misstatement. A party must rely upon its own inspections. Powered by www.hipmoby.com

