

## 32 Shetcliffe Road, Bradford, BD4 6DD

A quiet and spacious, semi-detached house for sale in Bierley, BD4.

A bright and well-presented hallway leads into a modern kitchen with a breakfast bar and dining area, looking out to the back garden. The living room has a feature fireplace and also accesses the hallway.

Upstairs, two double bedrooms are accompanied by a smaller single bedroom. The house bathroom contains a sink, WC and bath with shower over. Loft storage with added insulation is accessed from the landing.

A driveway for multiple cars is accompanied by a beautiful rear garden and patio seating area.

- Recently Renovated
- Off Street Parking
- Large Rear Garden
- Three Bedrooms
- Open Plan Kitchen
- Quiet Cul-de Sac

**£185,000**

GROUND FLOOR  
400 sq.ft. (37.1 sq.m.) approx.

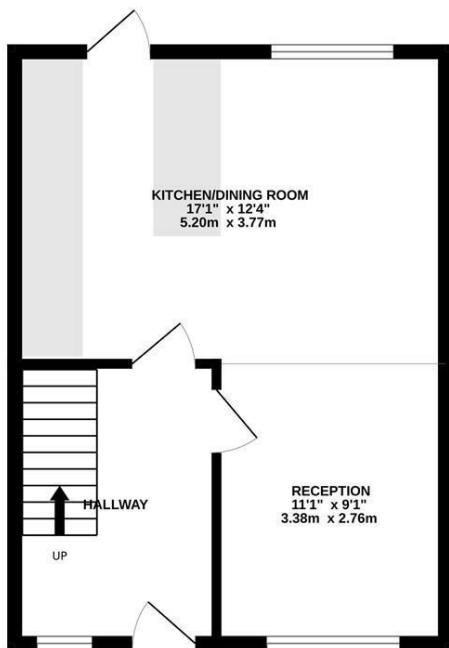

1ST FLOOR  
400 sq.ft. (37.1 sq.m.) approx.

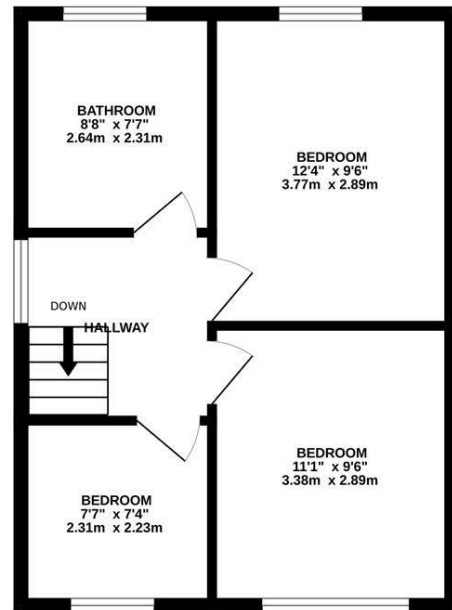

TOTAL FLOOR AREA : 799 sq.ft. (74.3 sq.m.) approx.

Whilst every attempt has been made to ensure the accuracy of the floorplan contained here, measurements of doors, windows, rooms and any other items are approximate and no responsibility is taken for any error, omission or mis-statement. This plan is for illustrative purposes only and should be used as such by any prospective purchaser. The services, systems and appliances shown have not been tested and no guarantee as to their operability or efficiency can be given.  
Made with Metropix ©2024

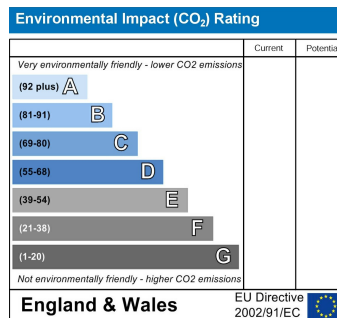
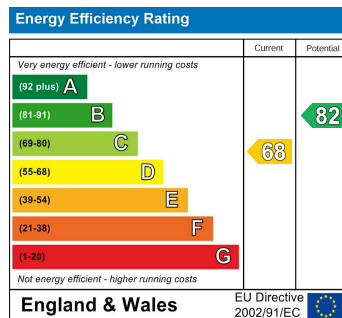

Tel: