



Seaview Estate, Southwick, BN42 4AS

Guide Price £475,000

🛏 3 🚿 1 🚗 1





- Newly renovated
- Port and sea views
- Dual aspect Lounge / Diner
- Parking and Detached Garage
- Wider plot with varied scope to extend STNC
- Three bedrooms
- Bright and airy
- Enclosed level rear garden
- No Onward Chain
- Short walk to London linked Southwick Station

Seaview Estate, Southwick, Brighton, BN42

Approximate Area = 940 sq ft / 87.3 sq m
Garage = 171 sq ft / 15.8 sq m
Total = 1111 sq ft / 103.1 sq m
For identification only - Not to scale

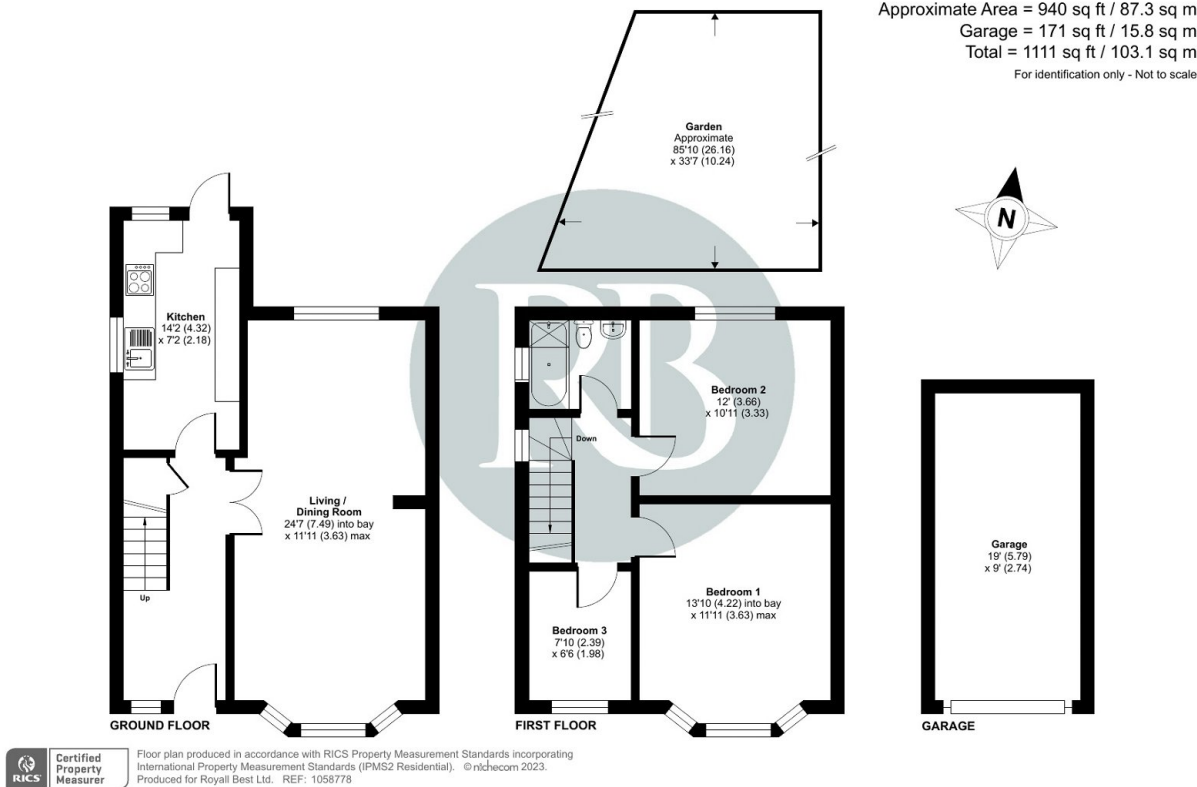

****Guide Price £475,000-£500,000****

A newly renovated three bedroom semi detached house with no onward chain, set on the coast road in Southwick.

Russ (Royall Best) says... 'The detached pitched roof garage together with the wider than average plot offer a variety of opportunities to extend (STNC)'



Lucie (Royall Best) says...'I'd love to wake up every morning to the sea views and on stormy nights watch the lightening roll in'