

# SIGNATURE

## NORTH EAST

OFFICIALLY RATED THE NO.1 ESTATE AGENT IN THE NORTH EAST







 Denwick Terrace, Tynemouth NE30 2SG



# Denwick Terrace, Tynemouth NE30 2SG

## Offers In The Region Of £520,000

Signature North East welcomes you to this fantastic five-bedroom terraced home, located in the ever-popular area of Tynemouth. Just a short walk from King Edward's Bay and the lively Tynemouth Front Street, this property offers a perfect mix of relaxed coastal living and easy access to shops, restaurants, and transport. With green spaces nearby and the Metro station close, commuting into Newcastle City Centre couldn't be easier.

Upon entering the central hallway, you're welcomed into a bright and spacious living room, highlighted by a stunning bay window which fills the room with natural light. The generous kitchen/diner features an excellent range of wall and base units, sleek worktops, and space for a dining table—perfect for everyday living and entertaining. From here, there is access to the private rear yard. A separate dining room with another large bay window offers further space for hosting, and a utility room adds practical convenience to the ground floor.

The first floor presents three well-proportioned bedrooms, two of which easily accommodate a double bed and furnishings. This level also includes a stylish bathroom complete with bathtub, shower, hand basin and W.C., as well as a separate W.C. room. On the second floor, you'll find bedroom four plus two handy loft rooms, ready to be styled to suit your needs, offering flexible living arrangements ideal for growing families and home working.

Externally, this lovely home boasts a neatly presented front garden laid with stone, adding charm and kerb appeal, and a private rear yard that provides a peaceful outdoor space to relax or entertain. The front garden allows for off-street parking of multiple cars and includes an electric car charging point. This fantastic property offers generous living space across three floors in one of the North East's most sought-after coastal locations—perfect for families or those looking to enjoy the vibrant Tynemouth lifestyle.



PLEASE NOTE THAT THE VENDOR HAS CERTIFIED THE PROPERTY INFORMATION AND IMAGES.

# PROPERTY FLOORPLAN

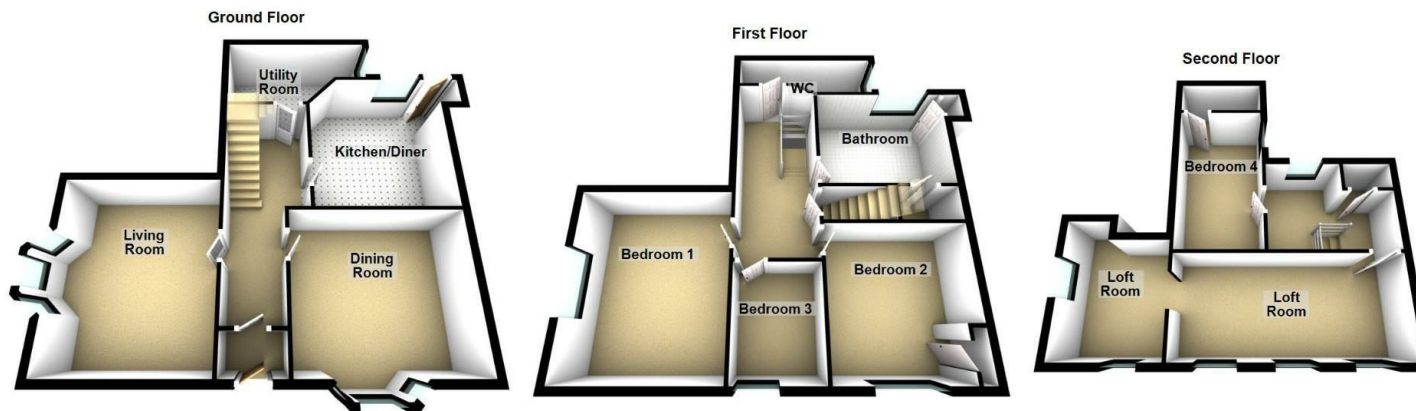

## Measurements:

Living Room  
15'3" x 14'11"

Dining Room  
15'0" x 14'0"

Kitchen / Diner  
12'5" x 11'11"

Utility Room  
12'2" x 6'5"

Bedroom One  
13'8" x 12'7"

Bedroom Two  
12'5" x 11'11"

Bedroom Three  
8'11" x 6'6"

Bathroom  
11'10" x 9'9"

WC  
12'7" x 4'5"

## Energy Efficiency Rating

	Current	Potential
Very energy efficient - lower running costs		
(92 plus) <b>A</b>		
(81-91) <b>B</b>		
(69-80) <b>C</b>		
(55-68) <b>D</b>	59	
(39-54) <b>E</b>		
(21-38) <b>F</b>		
(1-20) <b>G</b>		
Not energy efficient - higher running costs		
<b>England &amp; Wales</b> EU Directive 2002/91/EC		

77









More 5 Star Customer Reviews than any other Agent based in the North East on [allAgents.co.uk](https://allagents.co.uk)



**SALES**

**LETTINGS**

**FINANCE**

**LAW**

**WE COVER THE WHOLE OF THE NORTH EAST**

Whitley Bay  
0191 251 3344

Cramlington  
01670 897 213

Tynemouth  
0191 296 6689

Morpeth  
01670 513 966

Ponteland  
01661 820 082

Wallsend  
0191 432 4151

Alnwick  
01665 511 800

Heaton  
0191 432 4275

Forest Hall  
0191 266 9966

Other locations  
0191 640 3523

Newcastle  
0191 640 2284

Durham  
0191 303 8252

Gosforth  
0191 640 3523

Sunderland  
0191 543 6390

Whickham  
0191 432 5102

Gateshead  
0191 432 4294

Jesmond  
0191 281 1037

Killingworth  
0191 640 3602

Ryton  
0191 413 9845

Head Office &  
Lettings  
0191 253 4815

\*Highest recommended 5-star reviews than any other Estate Agent based in the North East on [allAgents.co.uk](https://allagents.co.uk) - The UK's Largest Customer Review Website for the Property Industry & Awarded Best Estate Agency 2018 & 2019 - North East England by SME News