

# SIGNATURE

## NORTH EAST

OFFICIALLY RATED THE NO.1 ESTATE AGENT IN THE NORTH EAST





📍 St. Anselm Crescent, North Shields NE29 8BL



# St. Anselm Crescent, North Shields NE29 8BL

**Guide Price £235,000**

Signature North East welcomes you to St. Anselm Crescent, North Shields. This charming two-bedroom semi-detached bungalow is nestled within a vibrant and welcoming community, making it an ideal choice for families or those looking to downsize. The area boasts highly regarded schools, beautiful parks, and green spaces, providing ample opportunities for outdoor activities and relaxation. A variety of local shops, including grocery stores, cater to daily necessities, ensuring a balanced and convenient lifestyle. Excellent transport links serve the area, with public transport options readily available. Additionally, the A1058 coastal road offers easy access to both the stunning North East coastline and Newcastle city centre, making commuting effortless to surrounding towns.

The bungalow is accessed via a side entrance, leading into a spacious and inviting hallway. The thoughtful layout ensures ease of navigation, with all rooms conveniently situated on a single level. The living quarters are positioned at the front of the property, offering a sense of separation, while the open-plan living spaces towards the rear provide seamless access to the garden—perfect for entertaining or simply enjoying the tranquil outdoor views. The heart of the home is the beautifully designed open-plan kitchen and living area. Recently renovated to a high standard, the modern kitchen boasts sleek countertops and an abundance of wall and base units for ample storage. Flowing effortlessly into the living area, this space features a stylish media wall, an elegant fireplace, and large sliding doors that open onto the rear garden, flooding the room with natural light and providing uninterrupted views. The kitchen also offers convenient internal access to the garage.

On the opposite side of the bungalow, two generously sized double bedrooms provide versatile living options. Whether used as a guest room, a child's bedroom, or a home office, these rooms offer ample space to suit your needs.

The centrally positioned family bathroom is finished to an exceptional standard, exuding a spa-like atmosphere complete with a bathtub for ultimate relaxation.

Externally, the rear garden is designed for low maintenance, featuring a neatly maintained lawn, a flower border, and a patio area ideal for outdoor furniture. A charming picket-fenced front garden enhances the property's kerb appeal. For parking, a private driveway accommodates one off-road vehicle, while the single garage provides additional space for another vehicle or extra storage.

This delightful bungalow offers a perfect blend of comfort, convenience, and modern living—schedule your viewing today!



# PROPERTY FLOORPLAN

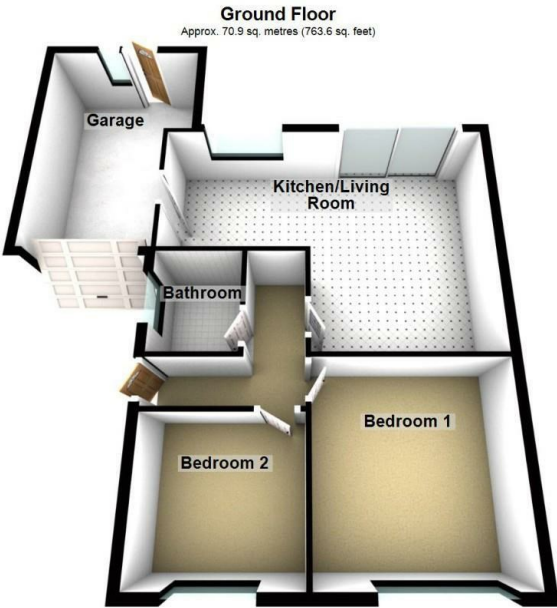

Total area: approx. 70.9 sq. metres (763.6 sq. feet)  
Please be advised the floorplans are not drawn to scale and are to be used to give an idea of the layout of the property.  
Plan produced using PlanUp.

## Measurements:

Kitchen / Living Room  
21'6" x 15'8"

Bedroom One  
12'3" x 11'8"

Bedroom Two  
9'5" x 9'1"

Bathroom  
6'6" x 5'5"

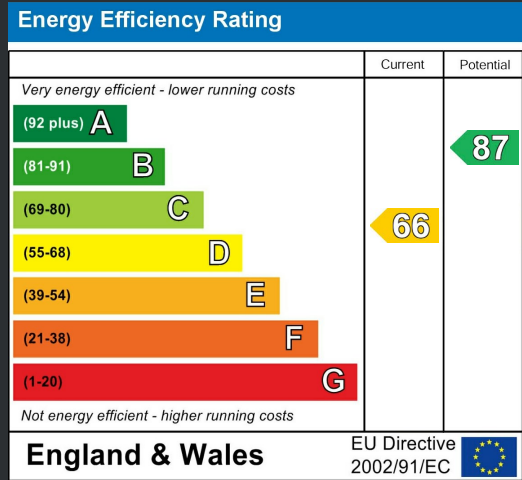







More 5 Star Customer Reviews than any other Agent based in the North East on [allAgents.co.uk](https://allAgents.co.uk)



**SALES**

**LETTINGS**

**FINANCE**

**LAW**

**WE COVER THE WHOLE OF THE NORTH EAST**

Whitley Bay  
0191 251 3344

Cramlington  
01670 897 213

Tynemouth  
0191 296 6689

Morpeth  
01670 513 966

Ponteland  
01661 820 082

Wallsend  
0191 432 4151

Alnwick  
01665 511 800

Heaton  
0191 432 4275

Forest Hall  
0191 266 9966

Other locations  
0191 640 3523

Newcastle  
0191 640 2284

Durham  
0191 303 8252

Gosforth  
0191 640 3523

Sunderland  
0191 543 6390

Whickham  
0191 432 5102

Gateshead  
0191 432 4294

Jesmond  
0191 281 1037

Killingworth  
0191 640 3602

Ryton  
0191 413 9845

Head Office &  
Lettings  
0191 253 4815

\*Highest recommended 5-star reviews than any other Estate Agent based in the North East on [allAgents.co.uk](https://allAgents.co.uk) - The UK's Largest Customer Review Website for the Property Industry & Awarded Best Estate Agency 2018 & 2019 - North East England by SME News