

SIGNATURE

NORTH EAST

OFFICIALLY RATED THE NO.1 ESTATE AGENT IN THE NORTH EAST





Wallsend Road, North Shields NE29 7AF

Wallsend Road, North Shields NE29 7AF

Asking Price
£180,000

Signature North East welcomes you to Wallsend Road, North Shields. This four-bedroom semi-detached home is situated in a vibrant area that perfectly blends urban convenience with natural beauty. The location is easily accessible, thanks to excellent transport links. The A19 dual carriageway is just a short drive away, providing quick access to Newcastle city centre to the north and Sunderland to the south. Additionally, the nearby Metro system enhances commuting options. Families will appreciate the proximity to quality educational institutions, while being at the heart of North Shields means an array of local amenities caters to daily life, ensuring convenience and easy living. The picturesque North Shields Quayside is also within close reach, offering scenic riverside walks and a charming atmosphere.

Stepping inside, the spacious hallway leads to the inviting living room on the right, where a feature fireplace serves as a cosy focal point—perfect for spending time with loved ones. A boxed bay window allows plenty of natural light to fill the space. The open-plan kitchen and dining area form the heart of the home, offering a wealth of wall and base units, ample counter space for meal preparation, and a designated dining area that accommodates both formal and informal gatherings. The space also features a family area and benefits from French doors that open directly onto the rear garden—ideal for keeping an eye on children or seamlessly extending entertaining spaces outdoors. A downstairs WC and additional outdoor access to the side of the property complete the ground floor.

On the first floor, four generously sized double bedrooms provide the perfect retreat at the end of the day. Bedrooms one and two are particularly spacious, allowing ample room for your preferred furnishings. The versatile layout ensures space for hosting guests, a home office, or a growing family. The family bathroom completes the first floor, featuring both a separate walk-in shower and a bathtub for added relaxation.

Externally, the rear garden can be accessed via a back gate, providing a private outdoor space. A patio area is ideal for outdoor furniture, while a driveway offers convenient off-street parking. This fantastic home in a prime location offers both comfort and convenience—an excellent choice for modern family living.



PLEASE NOTE THAT THE VENDOR HAS CERTIFIED THE PROPERTY INFORMATION AND IMAGES.

PROPERTY FLOORPLAN

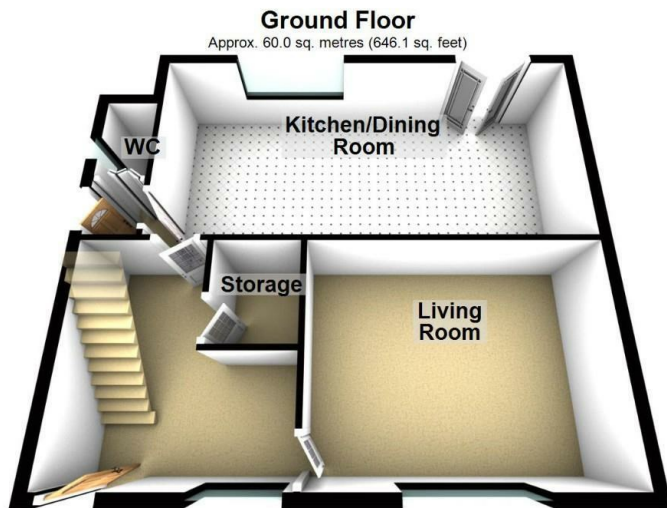

Total area: approx. 121.2 sq. metres (1305.0 sq. feet)

Please be advised the floorplans are not drawn to scale and are to be used to give an idea of the layout of the property.
Plan produced using PlanUp.

Measurements:

Living Room
15'8" x 12'0"

Kitchen / Dining Room
24'1" x 11'5"

WC
4'10" x 2'10"

Bedroom One
13'2" x 12'0"

Bedroom Two
11'11" x 10'8"

Bedroom Three
11'8" x 9'10"

Bedroom Four
8'10" x 8'4"

Bathroom
8'4" x 8'1"

Energy Efficiency Rating

	Current	Potential
Very energy efficient - lower running costs		
(92 plus) A		85
(81-91) B		
(69-80) C	70	
(55-68) D		
(39-54) E		
(21-38) F		
(1-20) G		
Not energy efficient - higher running costs		

England & Wales

EU Directive
2002/91/EC







More 5 Star Customer Reviews than any other Agent based in the North East on allAgents.co.uk



SALES

LETTINGS

FINANCE

LAW

WE COVER THE WHOLE OF THE NORTH EAST

Whitley Bay
0191 251 3344

Cramlington
01670 897 213

Tynemouth
0191 296 6689

Morpeth
01670 513 966

Ponteland
01661 820 082

Wallsend
0191 432 4151

Alnwick
01665 511 800

Heaton
0191 432 4275

Forest Hall
0191 266 9966

Other locations
0191 640 3523

Newcastle
0191 640 2284

Durham
0191 303 8252

Gosforth
0191 640 3523

Sunderland
0191 543 6390

Whickham
0191 432 5102

Gateshead
0191 432 4294

Jesmond
0191 281 1037

Killingworth
0191 640 3602

Ryton
0191 413 9845

Head Office &
Lettings
0191 253 4815

*Highest recommended 5-star reviews than any other Estate Agent based in the North East on allAgents.co.uk - The UK's Largest Customer Review Website for the Property Industry & Awarded Best Estate Agency 2018 & 2019 - North East England by SME News