

SIGNATURE

NORTH EAST

OFFICIALLY RATED THE NO.1 ESTATE AGENT IN THE NORTH EAST





JAMES TCE

📍 James Terrace, Wallsend NE28 6RU

James Terrace, Wallsend NE28 6RU

£80,000

A fantastic opportunity has arisen to acquire this beautifully presented, two-bedroom first floor flat situated on James Terrace Wallsend, this property benefits from luxuriously tall ceilings, an excellent feature seen throughout. It is located just a stone's throw from Wallsend where you will find a wealth of shops and amenities. Excellent schooling options for all age groups are easily accessible, and the property benefits from excellent transport links, including the nearby metro and bus interchange.

Upon entering, an inviting entrance hallway greets us, granting access to the spacious living room, two bedrooms, and a well-appointed bathroom. The living area boasts a remarkable expanse, providing ample room for various furniture arrangements. Complementing this generous space, a beautiful large window bathes the room in an abundance of natural light, fostering a delightful and airy ambiance. Leading from the living room we find a well-designed kitchen adorned with a variety of wall and base units, ensuring plentiful storage capacity. The kitchen is thoughtfully equipped with integrated appliances, such as an electric oven and a gas hob. Additionally there is also room for a family dining table and other desired furnishings.

Both of the generously proportioned bedrooms offer ample space to comfortably accommodate a double bed. The main bedroom presents an additional highlight with its charming bow window, allowing an abundance of natural light to fill the room, creating a bright and inviting atmosphere. With its generous size, the main bedroom provides abundant space to arrange desired furnishings.

Adjacent to the bedrooms, we find the neutral tone bathroom. The bathroom is equipped with an over bath shower, and clean finish.

Externally, the property on offer benefits from a welcoming back garden



PLEASE NOTE THAT THE VENDOR HAS CERTIFIED THE PROPERTY INFORMATION AND IMAGES.

PROPERTY FLOORPLAN

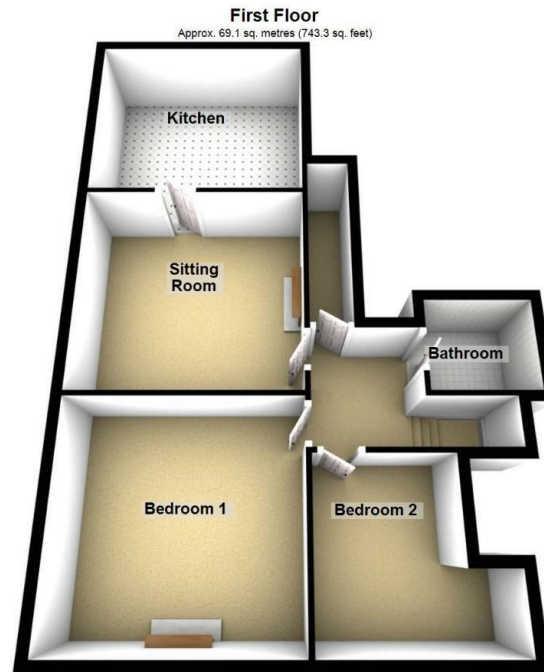

Measurements:

Energy Efficiency Rating

	Current	Potential
<i>Very energy efficient - lower running costs</i>		
(92 plus) A		
(81-91) B		
(69-80) C		
(55-68) D		
(39-54) E		
(21-38) F		
(1-20) G		
<i>Not energy efficient - higher running costs</i>		
England & Wales	EU Directive 2002/91/EC 	





More 5 Star Customer Reviews than any other Agent based in the North East on allAgents.co.uk



SALES

LETTINGS

FINANCE

LAW

WE COVER THE WHOLE OF THE NORTH EAST

Whitley Bay
0191 251 3344

Cramlington
01670 897 213

Tynemouth
0191 296 6689

Morpeth
01670 513 966

Ponteland
01661 820 082

Wallsend
0191 432 4151

Alnwick
01665 511 800

Heaton
0191 432 4275

Forest Hall
0191 266 9966

Other locations
0191 640 3523

Newcastle
0191 640 2284

Durham
0191 303 8252

Gosforth
0191 640 3523

Sunderland
0191 543 6390

Whickham
0191 432 5102

Gateshead
0191 432 4294

Jesmond
0191 281 1037

Killingworth
0191 640 3602

Ryton
0191 413 9845

Head Office &
Lettings
0191 253 4815

*Highest recommended 5-star reviews than any other Estate Agent based in the North East on allAgents.co.uk - The UK's Largest Customer Review Website for the Property Industry & Awarded Best Estate Agency 2018 & 2019 - North East England by SME News