

SIGNATURE

NORTH EAST

OFFICIALLY RATED THE NO.1 ESTATE AGENT IN THE NORTH EAST





 Angerton Avenue, North Shields NE30 3QY

Angerton Avenue, North Shields NE30 3QY

Offers Over £370,000

We are delighted to introduce this charming property in the heart of North Shields, North Tyneside. Boasting four bedrooms, this semi-detached home enjoys a prime location with convenient access to a plethora of amenities, including shops, restaurants, excellent transportation links to Newcastle City Centre, and the stunning coast, with neighbouring Tynemouth just a stone's throw away.

Step inside to discover a central hallway providing access to the ground-floor rooms. The spacious living room welcomes you with a large window flooding the space with natural light and offering ample room for furnishings. Adjacent, the open plan kitchen/diner impresses with its generous size, featuring French doors leading to the rear garden, allowing light to stream through. The modern white gloss style units and wood finish worktops create a seamless and stylish environment.

Ascending to the first floor, you'll find four generously proportioned bedrooms, all of which are light and airy. The master bedroom spans the length of the property and boasts a beautifully refurbished en-suite, adding a touch of luxury to everyday living. Completing the upper level of this home, a family bathroom awaits, equipped with a bathtub, shower, and W.C., ensuring convenience for all residents.

Outside, the property continues to impress with a generous rear paved garden, providing the perfect setting for outdoor relaxation and entertaining. Off-street parking is readily available for two cars, along with a large garage, offering practicality and convenience for modern living. Don't miss the opportunity to make this delightful property your new home sweet home.



PLEASE NOTE THAT THE VENDOR HAS CERTIFIED THE PROPERTY INFORMATION AND IMAGES.

PROPERTY FLOORPLAN

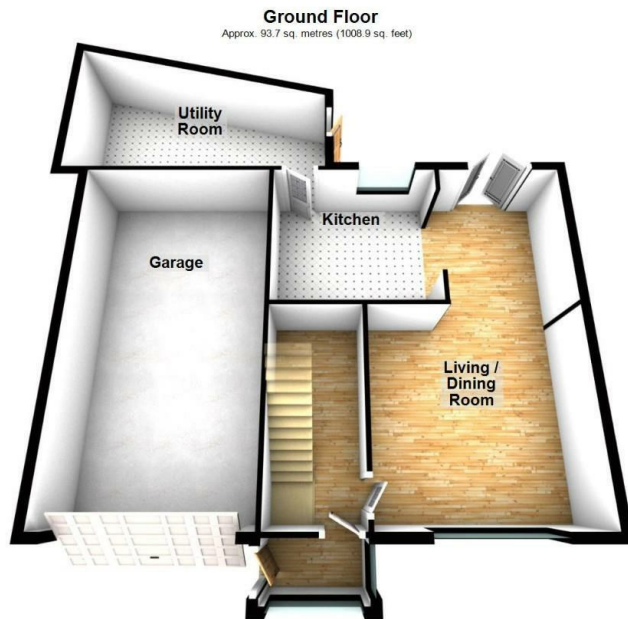

Ground Floor
Approx. 93.7 sq. metres (1008.9 sq. feet)

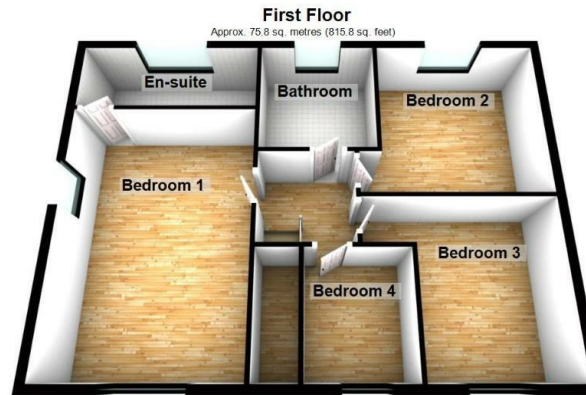

First Floor
Approx. 75.8 sq. metres (815.8 sq. feet)

Total area: approx. 169.5 sq. metres (1824.7 sq. feet)

Please be advised the floorplans are not drawn to scale and are to be used to give an idea of the layout of the property.
Plan produced using PlanUp.

Measurements:

Living/ Dining room
13'11" x 13'9"

Kitchen
11'6" x 10'0"

Utility room
8'7" x 19'0"

Bedroom 1
18'9" x 13'0"

Bedroom 2
11'9" x 13'3"

Bedroom 3
12'0" x 9'8"

Bedroom 4
8'9" x 7'1"

Bathroom
8'4" x 8'4"

En-suite
13'0" x 5'0"

Garage
24'2" x 13'0"

Energy Efficiency Rating

	Current	Potential
Very energy efficient - lower running costs		
(92 plus) A		
(81-91) B		84
(69-80) C	73	
(55-68) D		
(39-54) E		
(21-38) F		
(1-20) G		
Not energy efficient - higher running costs		
England & Wales	EU Directive 2002/91/EC 	





More 5 Star Customer Reviews than any other Agent based in the North East on allAgents.co.uk



SALES

LETTINGS

FINANCE

LAW

WE COVER THE WHOLE OF THE NORTH EAST

Whitley Bay
0191 251 3344

Cramlington
01670 897 213

Tynemouth
0191 296 6689

Morpeth
01670 513 966

Ponteland
01661 820 082

Wallsend
0191 432 4151

Alnwick
01665 511 800

Heaton
0191 432 4275

Forest Hall
0191 266 9966

Other locations
0191 640 3523

Newcastle
0191 640 2284

Durham
0191 303 8252

Gosforth
0191 640 3523

Sunderland
0191 543 6390

Whickham
0191 432 5102

Gateshead
0191 432 4294

Jesmond
0191 281 1037

Killingworth
0191 640 3602

Ryton
0191 413 9845

Head Office &
Lettings
0191 253 4815

*Highest recommended 5-star reviews than any other Estate Agent based in the North East on allAgents.co.uk - The UK's Largest Customer Review Website for the Property Industry & Awarded Best Estate Agency 2018 & 2019 - North East England by SME News