

SIGNATURE

NORTH EAST

OFFICIALLY RATED THE NO.1 ESTATE AGENT IN THE NORTH EAST





Willoughby Road, North Shields NE29 7NB

Willoughby Road, North Shields NE29 7NB

Asking Price
£185,000

Signature North East is thrilled to introduce to the market this delightful 3-bedroom semi-detached home situated in the heart of North Shields. Nestled in an excellent location, the property is close to a diverse range of useful amenities. This home presents a fantastic opportunity for restoring a well-loved family residence.

Upon entering this property, you are greeted by a welcoming hallway that provides access to the ground-floor rooms. The first stop is the dining room, bathed in natural light from a large bay window. This room features a gas fireplace and ample space for a family dining table and your preferred furnishings. Continuing through, you step into the living room where sunlight streams through elegant French doors that lead to the rear garden. Transitioning to the kitchen, you'll find an abundance of storage space provided by shaker-style units. This well-appointed kitchen also conveniently connects to the rear garden and a utility room.

Ascending to the first floor, you will find three generously sized bedrooms. Two of these bedrooms easily accommodate a king-size bed along with your preferred furnishings. The third single bedroom serves as a versatile space awaiting your personal touch. Completing the home is the bathroom, which features a bathtub, shower, hand basin, and W.C.

Externally, at the rear of the home, you will find a generous west-facing back garden, predominantly featuring a well-maintained lawn surrounded by three apple trees and mature plants. Additionally, there is a paved patio area, providing a delightful space. The property also includes off-street parking for one car through a convenient driveway.



PLEASE NOTE THAT THE VENDOR HAS CERTIFIED THE PROPERTY INFORMATION AND IMAGES.

PROPERTY FLOORPLAN

Ground Floor

Approx. 56.5 sq. metres (608.3 sq. feet)

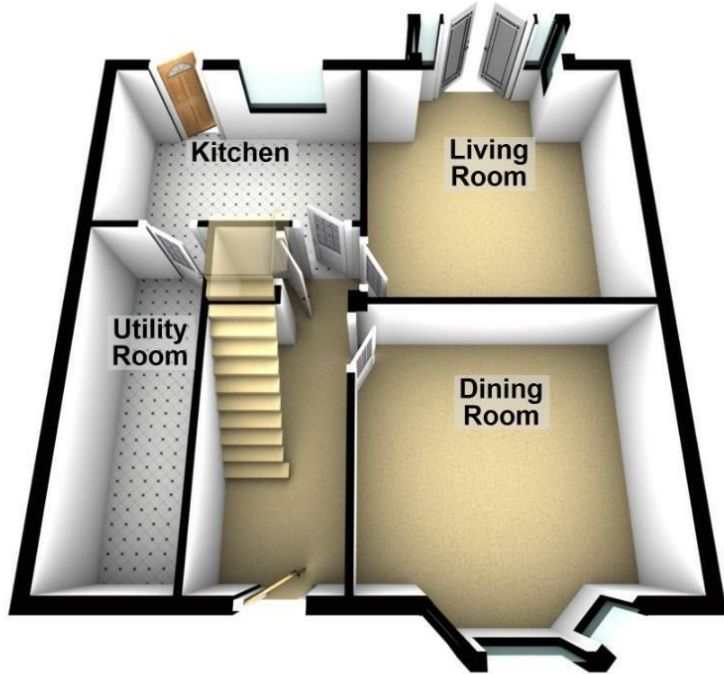

First Floor

Approx. 41.9 sq. metres (451.5 sq. feet)



Total area: approx. 98.5 sq. metres (1059.8 sq. feet)

Please be advised the floorplans are not drawn to scale and are to be used to give an idea of the layout of the property.
Plan produced using PlanUp.

Measurements:

Living Room
14'4" x 12'3"

Dining Room
13'4" x 12'9"

Kitchen
11'11" x 8'3"

Utility Room
15'1" x 5'2"

Bedroom One
11'8" x 11'0"

Bedroom Two
11'9" x 11'0"

Bedroom Three
7'3" x 7'1"

Bathroom
8'5" x 7'7"

Energy Efficiency Rating

	Current	Potential
Very energy efficient - lower running costs		
(92 plus) A		
(81-91) B		84
(69-80) C		
(55-68) D	59	
(39-54) E		
(21-38) F		
(1-20) G		
Not energy efficient - higher running costs		

England & Wales

EU Directive
2002/91/EC







More 5 Star Customer Reviews than any other Agent based in the North East on allAgents.co.uk



SALES

LETTINGS

FINANCE

LAW

WE COVER THE WHOLE OF THE NORTH EAST

Whitley Bay
0191 251 3344

Cramlington
01670 897 213

Tynemouth
0191 296 6689

Morpeth
01670 513 966

Ponteland
01661 820 082

Wallsend
0191 432 4151

Alnwick
01665 511 800

Heaton
0191 432 4275

Forest Hall
0191 266 9966

Other locations
0191 640 3523

Newcastle
0191 640 2284

Durham
0191 303 8252

Gosforth
0191 640 3523

Sunderland
0191 543 6390

Whickham
0191 432 5102

Gateshead
0191 432 4294

Jesmond
0191 281 1037

Killingworth
0191 640 3602

Ryton
0191 413 9845

Head Office &
Lettings
0191 253 4815

*Highest recommended 5-star reviews than any other Estate Agent based in the North East on allAgents.co.uk - The UK's Largest Customer Review Website for the Property Industry & Awarded Best Estate Agency 2018 & 2019 - North East England by SME News