

SIGNATURE

NORTH EAST

OFFICIALLY RATED THE NO.1 ESTATE AGENT IN THE NORTH EAST





 Evergreen Court, Crook DL15 8FA

Evergreen Court, Crook DL15 8FA

Offers Over £395,000

Signature North East is thrilled to introduce this exquisite 4-bedroom detached home situated in the serene Fir Tree area in Crook. The property boasts generously proportioned rooms, providing ample living space, along with breathtaking views of the surrounding countryside. This enviable location ensures convenient access to a plethora of amenities, including excellent restaurants, bars, and local shops.

Upon entering this charming property, you are greeted by a welcoming central hallway that provides access to the main principal rooms on the ground floor, as well as a conveniently located WC. The first space you encounter is the inviting living room, bathed in natural light streaming through elegant French doors that lead to the rear garden. This room offers generous space for your preferred furnishings. Progressing further, you'll discover the open-plan kitchen/dining area, illuminated by additional French doors leading to the rear garden. The dining area provides ample room for a family dining table and additional furnishings. In the well-equipped kitchen area, attractive shaker-style wall and base units offer abundant storage space. The kitchen comes complete with integrated appliances, including a dishwasher, grill, oven, and fridge/freezer. Additionally, there is a conveniently attached utility room.

Ascending to the first floor, you are welcomed by four generously sized bedrooms, each easily accommodating a double bed and your preferred furnishings. One of these bedrooms boasts its own ensuite, complete with a walk-in shower, basin, and a WC. The master bedroom reigns supreme, featuring a spacious walk-in wardrobe and an ensuite with a walk-in shower, hand basin, and WC. Completing this floor is the bathroom, offering a walk-in shower, bathtub, hand basin, and WC.

Externally, to the rear of the home, a generous back garden unfolds, predominantly adorned with a beautiful lawn. An ample paved patio area awaits, ideal for outdoor furniture, creating a perfect space for relaxation. The property offers picturesque views of serene countryside surroundings. At the front of the property, off-street parking for three cars is available, facilitated by a garage and a driveway.



PLEASE NOTE THAT THE VENDOR HAS CERTIFIED THE PROPERTY INFORMATION AND IMAGES.

PROPERTY FLOORPLAN

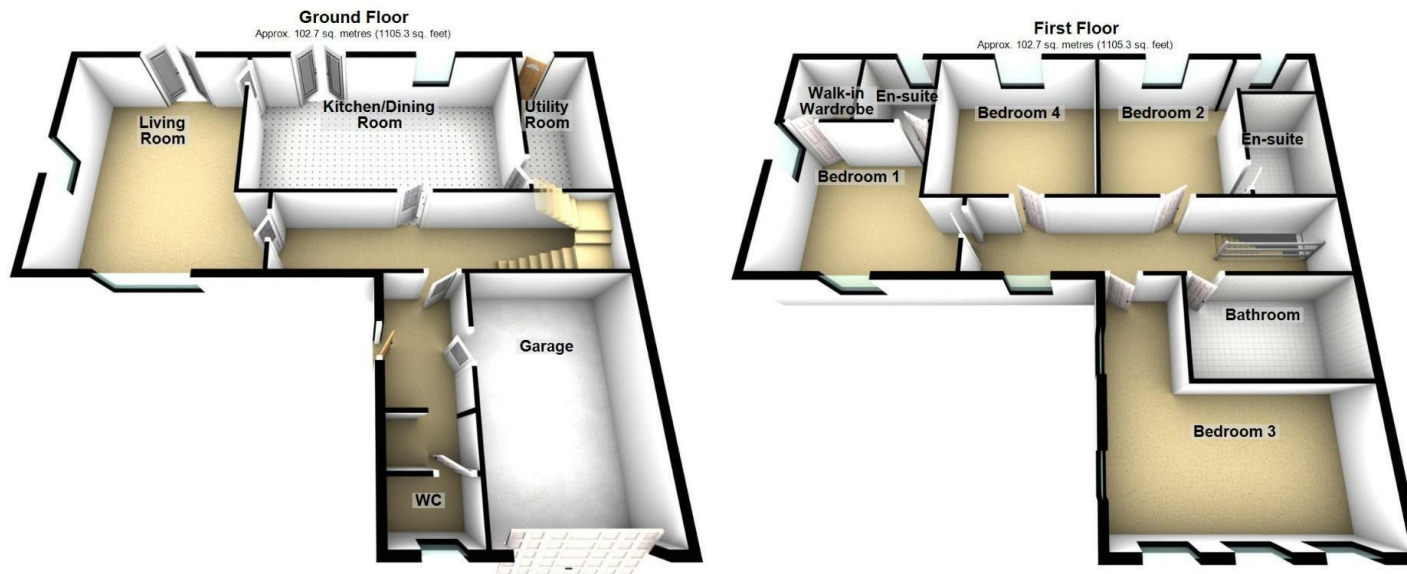

Total area: approx. 205.4 sq. metres (2210.7 sq. feet)
 Please be advised the floorplans are not drawn to scale and are to be used to give an idea of the layout of the property.
 Plan produced using PlanUp.

Measurements:

- Living Room
19'0" x 16'9"
- Kitchen / Dining Room
21'7" x 12'7"
- Utility Room
12'7" x 5'10"
- WC
5'7" x 3'10"
- Bedroom One
14'8" x 12'7"
- En Suite
6'1" x 5'11"
- Bedroom Two
12'10" x 11'1"
- En Suite
9'3" x 5'11"
- Bedroom Three
17'1" x 17'0"
- Bedroom Four
12'10" x 12'9"
- Bathroom
11'6" x 7'5"

Energy Efficiency Rating		
	Current	Potential
Very energy efficient - lower running costs		
(92 plus) A		
(81-91) B		
(69-80) C	75	82
(55-68) D		
(39-54) E		
(21-38) F		
(1-20) G		
Not energy efficient - higher running costs		
England & Wales	EU Directive 2002/91/EC	





More 5 Star Customer Reviews than any other Agent based in the North East on allAgents.co.uk



SALES

LETTINGS

FINANCE

LAW

WE COVER THE WHOLE OF THE NORTH EAST

Whitley Bay
0191 251 3344

Cramlington
01670 897 213

Tynemouth
0191 296 6689

Morpeth
01670 513 966

Ponteland
01661 820 082

Wallsend
0191 432 4151

Alnwick
01665 511 800

Heaton
0191 432 4275

Forest Hall
0191 266 9966

Other locations
0191 640 3523

Newcastle
0191 640 2284

Durham
0191 303 8252

Gosforth
0191 640 3523

Sunderland
0191 543 6390

Whickham
0191 432 5102

Gateshead
0191 432 4294

Jesmond
0191 281 1037

Killingworth
0191 640 3602

Ryton
0191 413 9845

Head Office &
Lettings
0191 253 4815

*Highest recommended 5-star reviews than any other Estate Agent based in the North East on allAgents.co.uk - The UK's Largest Customer Review Website for the Property Industry & Awarded Best Estate Agency 2018 & 2019 - North East England by SME News