

SIGNATURE

NORTH EAST

OFFICIALLY RATED THE NO.1 ESTATE AGENT IN THE NORTH EAST





📍 Wallsend Road, North Shields NE29 7BJ

Wallsend Road,
North Shields NE29 7BJ

Offers Over £49,950

Signature North East presents this two-bedroom first-floor flat, situated on Wallsend Road, North Shields. This property is conveniently located close to various amenities, including shops, restaurants, and public transportation options. The vibrant surroundings ensure you have everything you need within reach.

Upon entering the flat, you'll be greeted by a spacious hallway that starts with a landing. This area offers plenty of room for storage and provides easy access to all the rooms on the property. The living room is a true highlight, boasting a large bay window that fills the space with natural light. It offers ample space for desired furnishings and also features a fireplace, adding a cozy touch to the ambiance. Next is the kitchen, which offers storage space via the wall and base units as well as space for appliances.

There are two bedrooms which offer generous amounts of space. The first bedroom can comfortably accommodate a double bed and provides ample room for storage solutions. Similarly, bedroom 2 offers the same level of space and storage options, making it suitable for guests or as an additional bedroom. The bathroom is equipped with a bath, sink, and w.c., providing all the essentials for your daily routines.

Additionally, the property benefits from a spacious shared yard, which provides a pleasant outdoor space.

PROPERTY FLOORPLAN

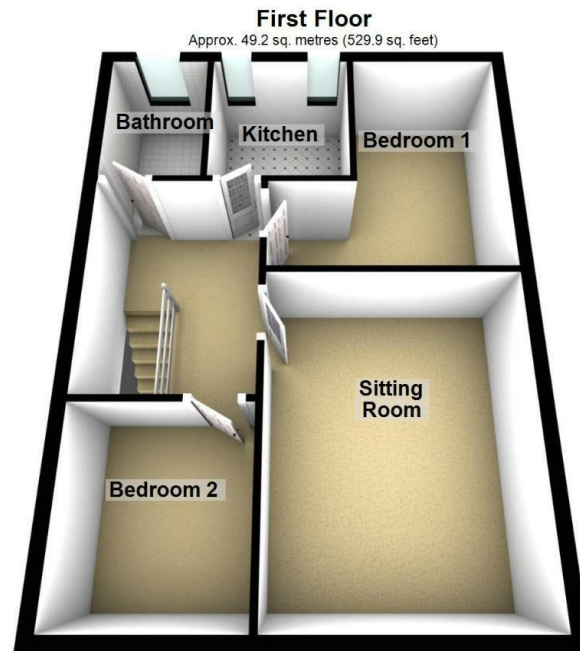

Measurements:

Energy Efficiency Rating

	Current	Potential
<i>Very energy efficient - lower running costs</i>		
(92 plus) A		
(81-91) B		
(69-80) C		
(55-68) D		
(39-54) E		
(21-38) F		
(1-20) G		
<i>Not energy efficient - higher running costs</i>		

England & Wales

EU Directive
2002/91/EC



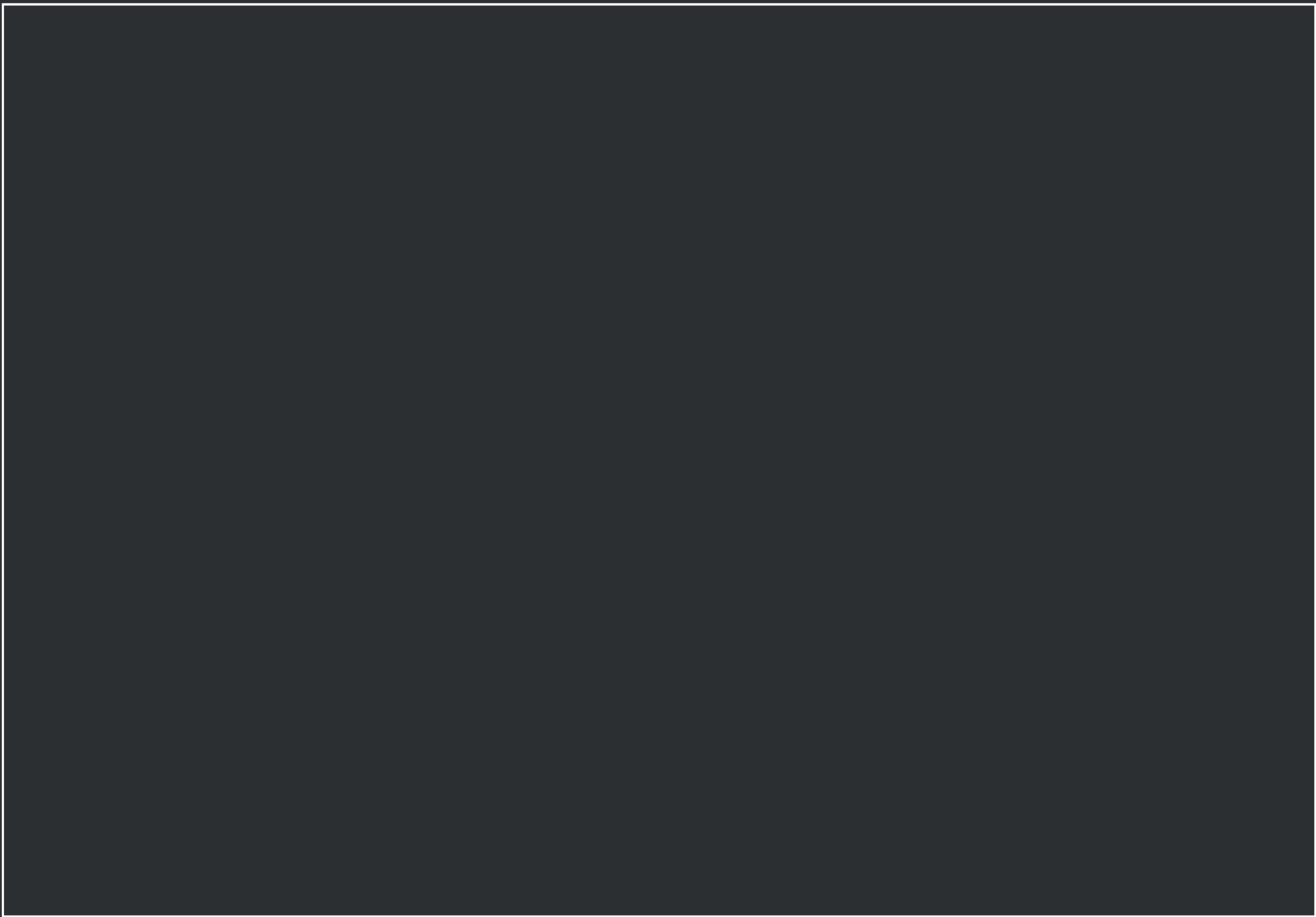



More 5 Star Customer Reviews than any other Agent based in the North East on allAgents.co.uk



SALES

LETTINGS

FINANCE

LAW

WE COVER THE WHOLE OF THE NORTH EAST

Whitley Bay
0191 251 3344

Cramlington
01670 897 213

Tynemouth
0191 296 6689

Morpeth
01670 513 966

Ponteland
01661 820 082

Wallsend
0191 432 4151

Alnwick
01665 511 800

Heaton
0191 432 4275

Forest Hall
0191 266 9966

Other locations
0191 640 3523

Newcastle
0191 640 2284

Durham
0191 303 8252

Gosforth
0191 640 3523

Sunderland
0191 543 6390

Whickham
0191 432 5102

Gateshead
0191 432 4294

Jesmond
0191 281 1037

Killingworth
0191 640 3602

Ryton
0191 413 9845

Head Office &
Lettings
0191 253 4815

*Highest recommended 5-star reviews than any other Estate Agent based in the North East on allAgents.co.uk - The UK's Largest Customer Review Website for the Property Industry & Awarded Best Estate Agency 2018 & 2019 - North East England by SME News