

# SIGNATURE

## NORTH EAST

OFFICIALLY RATED THE NO.1 ESTATE AGENT IN THE NORTH EAST







📍 The Orchard, Morpeth NE61 6HT



# The Orchard, Morpeth NE61 6HT

**Offers Over £595,000**

Signature North East are delighted to welcome to the market this exquisite three-bedroom detached bungalow, ideally positioned in the peaceful village of Hepscott, just outside of Morpeth. This sought-after location offers the perfect balance of rural charm and convenient access to town amenities. Nearby Morpeth provides a vibrant selection of high street and independent shops, along with a variety of cafes, bars, restaurants, and leisure facilities. Excellent transport links are within easy reach, connecting the area to Newcastle, the East Coast Main Line, and major road networks.

Upon entering the home, you are greeted by a central hallway which includes access to a convenient W.C. The main living/dining room is particularly spacious, offering plenty of room for furnishings and enjoying a bright, airy atmosphere thanks to multiple windows and patio doors opening out to the rear garden. Just off this space, through an open archway, is a cosy sitting room complete with a fireplace, ideal for relaxing. The well-appointed kitchen features a generous range of wall and base units, complemented by stylish worktops and integrated appliances including a dishwasher, oven, American style fridge freezer and microwave. French doors lead from the kitchen into the rear garden, further enhancing the home's indoor-outdoor flow.

Continuing through the property, you will find three generously proportioned bedrooms, each capable of comfortably housing a double bed and additional furnishings. All bedrooms benefit from built-in wardrobes, providing excellent storage solutions. The principal bedroom also enjoys the added benefit of an en-suite shower room with W.C. and hand basin. A separate bathroom serves the remaining bedrooms and includes a shower, hand basin and W.C.

Externally, the property boasts impressive outdoor space. The large private rear garden, mainly laid to lawn with a patio area, is perfect for outdoor furniture and enjoying the warmer months. A charming summerhouse adds further appeal. The front garden complements the rear with additional green space, while a long, gated driveway provides ample off-road parking. The double garage, which can be accessed via a side door, offers further convenience and storage.

This lovely bungalow is a fantastic opportunity for those seeking a peaceful home with generous living space both inside and out.



PLEASE NOTE THAT THE VENDOR HAS CERTIFIED THE PROPERTY INFORMATION AND IMAGES.

# PROPERTY FLOORPLAN

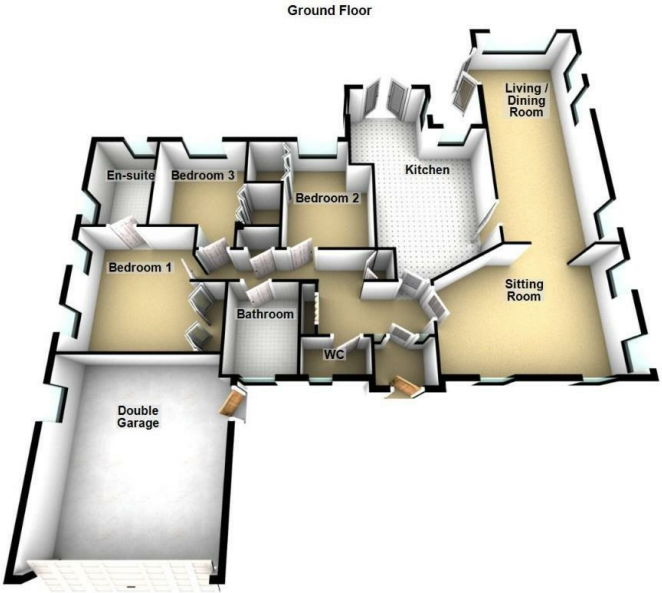

## Measurements:

Living / Dining Room  
28'3" x 11'10"

Sitting Room  
16'3" x 13'4"

Kitchen  
23'9" x 15'3"

Bedroom One  
13'1" x 12'11"

En Suite  
10'3". x 6'9"

Bedroom Two  
12'11" x 9'6"

Bedroom Three  
12'11" x 9'7"

Bathroom  
9'2" x 6'11"

WC  
6'8" x 3'6"

Energy Efficiency Rating		
	Current	Potential
Very energy efficient - lower running costs		
(92 plus) A		
(81-91) B		
(69-80) C		76
(55-68) D	65	
(39-54) E		
(21-38) F		
(1-20) G		
Not energy efficient - higher running costs		
England & Wales		EU Directive 2002/91/EC 









More 5 Star Customer Reviews than any other Agent based in the North East on [allAgents.co.uk](https://allAgents.co.uk)



**SALES**

**LETTINGS**

**FINANCE**

**LAW**

**WE COVER THE WHOLE OF THE NORTH EAST**

Whitley Bay  
0191 251 3344

Cramlington  
01670 897 213

Tynemouth  
0191 296 6689

Morpeth  
01670 513 966

Ponteland  
01661 820 082

Wallsend  
0191 432 4151

Alnwick  
01665 511 800

Heaton  
0191 432 4275

Forest Hall  
0191 266 9966

Other locations  
0191 640 3523

Newcastle  
0191 640 2284

Durham  
0191 303 8252

Gosforth  
0191 640 3523

Sunderland  
0191 543 6390

Whickham  
0191 432 5102

Gateshead  
0191 432 4294

Jesmond  
0191 281 1037

Killingworth  
0191 640 3602

Ryton  
0191 413 9845

Head Office &  
Lettings  
0191 253 4815

\*Highest recommended 5-star reviews than any other Estate Agent based in the North East on [allAgents.co.uk](https://allAgents.co.uk) - The UK's Largest Customer Review Website for the Property Industry & Awarded Best Estate Agency 2018 & 2019 - North East England by SME News