

# SIGNATURE

## NORTH EAST

OFFICIALLY RATED THE NO.1 ESTATE AGENT IN THE NORTH EAST







Turner Square, Morpeth NE61 2JA



# Turner Square, Morpeth NE61 2JA

## Offers In The Region Of £110,000

Signature North East proudly presents this stunning one-bedroom apartment in Turner Square, Morpeth. Ideally situated in the heart of Northumberland, this exceptional property offers the perfect blend of urban convenience and natural beauty, making it an attractive choice for those looking to downsize in a well-connected and scenic location.

Morpeth, a charming market town, boasts a vibrant community, picturesque landscapes, and a wealth of amenities to support a high-quality lifestyle. With excellent transport links, including convenient road networks providing easy access to surrounding areas and major cities, this sought-after location is ideal for those seeking a balanced way of life.

Positioned on the first floor, the apartment features an inviting open-plan living space, perfect for entertaining or everyday comfort. Upon entering, the spacious hallway provides access to all rooms. To the right, the heart of the home unfolds—an open-plan kitchen, living, and dining area with a private balcony offering serene views of mature trees. This outdoor space is perfect for relaxation, basking in the sun, or enjoying the tranquillity of nature. The kitchen is designed for both style and functionality, boasting a peninsula with a seating area, ample wall and base units for storage, and integrated appliances, including a washing machine, fridge freezer, oven, and hob. A window enhances the kitchen's brightness, creating a light and airy atmosphere.

The double bedroom serves as a peaceful retreat at the end of the day, benefiting from generous natural light and ample space for your preferred furnishings. Completing the apartment is a well-appointed three-piece bathroom, featuring a bathtub for relaxation and an overhead shower for convenience—perfect for both residents and visiting guests.

Externally, the beautifully maintained communal grounds provide a sense of rural tranquillity while being just moments from Morpeth town centre. For parking convenience, the property includes an allocated off-road parking space, with additional visitor bays available.

This stunning apartment offers a fantastic opportunity to enjoy the best of Morpeth's charm, with a prime location, modern living spaces, and breathtaking surroundings.



PLEASE NOTE THAT THE VENDOR HAS CERTIFIED THE PROPERTY INFORMATION AND IMAGES.

# PROPERTY FLOORPLAN

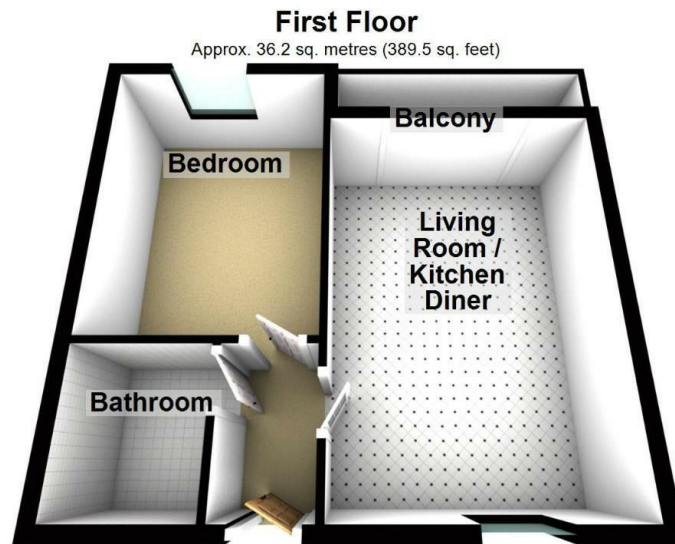

Total area: approx. 36.2 sq. metres (389.5 sq. feet)

Please be advised the floorplans are not drawn to scale and are to be used to give an idea of the layout of the property.  
Plan produced using PlanUp.

## Measurements:

Living Room / Kitchen Diner  
16'11" x 11'7"

Bedroom  
12'8" x 9'7"

Bathroom  
6'4" x 5'6"

## Energy Efficiency Rating

	Current	Potential
Very energy efficient - lower running costs		
(92 plus) <b>A</b>		
(81-91) <b>B</b>	<b>78</b>	<b>79</b>
(69-80) <b>C</b>		
(55-68) <b>D</b>		
(39-54) <b>E</b>		
(21-38) <b>F</b>		
(1-20) <b>G</b>		
Not energy efficient - higher running costs		
<b>England &amp; Wales</b>	EU Directive 2002/91/EC 	









More 5 Star Customer Reviews than any other Agent based in the North East on [allAgents.co.uk](https://allAgents.co.uk)



**SALES**

**LETTINGS**

**FINANCE**

**LAW**

**WE COVER THE WHOLE OF THE NORTH EAST**

Whitley Bay  
0191 251 3344

Cramlington  
01670 897 213

Tynemouth  
0191 296 6689

Morpeth  
01670 513 966

Ponteland  
01661 820 082

Wallsend  
0191 432 4151

Alnwick  
01665 511 800

Heaton  
0191 432 4275

Forest Hall  
0191 266 9966

Other locations  
0191 640 3523

Newcastle  
0191 640 2284

Durham  
0191 303 8252

Gosforth  
0191 640 3523

Sunderland  
0191 543 6390

Whickham  
0191 432 5102

Gateshead  
0191 432 4294

Jesmond  
0191 281 1037

Killingworth  
0191 640 3602

Ryton  
0191 413 9845

Head Office &  
Lettings  
0191 253 4815

\*Highest recommended 5-star reviews than any other Estate Agent based in the North East on [allAgents.co.uk](https://allAgents.co.uk) - The UK's Largest Customer Review Website for the Property Industry & Awarded Best Estate Agency 2018 & 2019 - North East England by SME News