

SIGNATURE

NORTH EAST

OFFICIALLY RATED THE NO.1 ESTATE AGENT IN THE NORTH EAST





 Cranford Court, Morpeth NE61 2GE

Cranford Court, Morpeth NE61 2GE

Asking Price
£535,000

Signature North East welcomes you to Cranford Court, St. George's Wood, Morpeth. This exquisite four-bedroom detached home is nestled in a vibrant neighbourhood in the heart of Northumberland, just a short distance from Morpeth's bustling town centre. Offering easy access to a variety of shops, restaurants, and local amenities, this prime location enhances everyday living. Perfect for a growing family, the area is served by reputable schools and is close to several parks and green spaces, including the popular Carlisle Park, which features scenic walking paths, playgrounds, and sports facilities. Commuters will appreciate the excellent transport links, including the nearby train station and the A1, ensuring seamless connections to surrounding towns and wider destinations.

Stepping inside, the welcoming central hallway provides access to all ground-floor areas. To the left, the family room offers a versatile space for relaxation, children's play, or entertaining, featuring a charming bay window that floods the room with natural light and offers a lovely outlook to the front of the property. Adjacent to this, the living room boasts elegant bifold doors, seamlessly connecting the indoor space with the private rear garden, perfect for blending indoor and outdoor living. At the heart of the home, the open-plan kitchen and dining area is ideal for hosting, meal preparation, and both informal and formal gatherings. The well-equipped kitchen includes a fridge freezer, oven, washing machine, and dishwasher, while the central island provides additional counter space and a seating area for casual dining. The adjoining dining area comfortably accommodates a formal dining table and enjoys direct access to the garden, maximising indoor-outdoor flow.

For added convenience, the utility room sits adjacent to the kitchen, offering extra storage and outdoor access. A dedicated study, complete with a bay window, provides a perfect workspace for those working from home. The ground floor is completed by a guest WC.

Upstairs, four generously sized double bedrooms await, each offering ample space and versatility for a growing family or hosting guests. Bedrooms one and two benefit from their own private en-suites, ensuring added comfort and privacy. Bedrooms three and four are situated on the opposite side of the property and share a stylish three-piece family bathroom, complete with a bathtub and overhead shower for ultimate relaxation.

The private rear garden has been designed for low-maintenance enjoyment, featuring a lush lawn and a patio area ideal for outdoor dining and entertaining. The property benefits from a double garage, providing secure parking and additional storage space, while the driveway can accommodate up to three vehicles.



PLEASE NOTE THAT THE VENDOR HAS CERTIFIED THE PROPERTY INFORMATION AND IMAGES.

PROPERTY FLOORPLAN

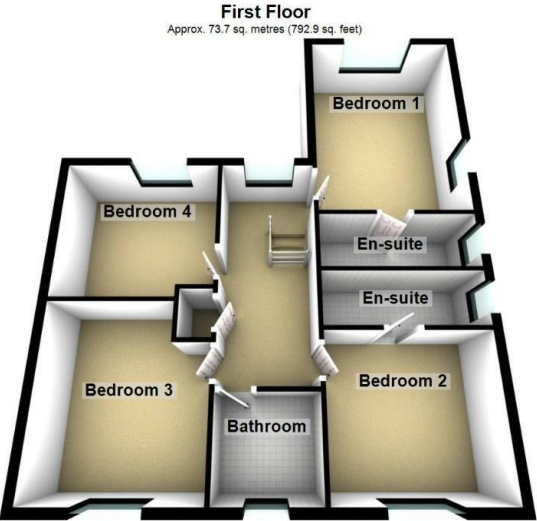
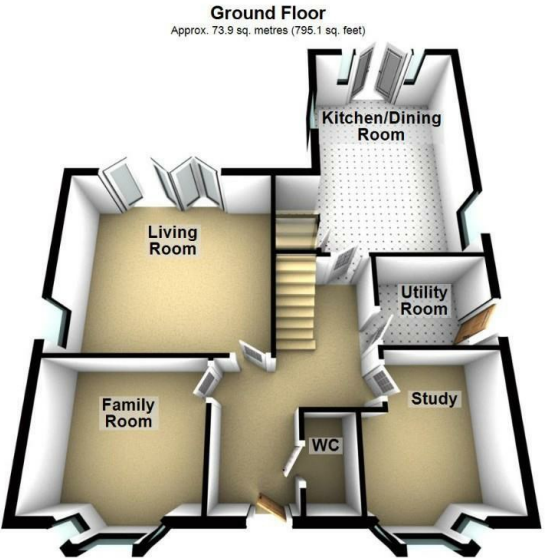

Total area: approx. 147.5 sq. metres (1588.0 sq. feet)
Please be advised the floorplans are not drawn to scale and are to be used to give an idea of the layout of the property.
Plan produced using PlanUp.

Measurements:

- Living Room
14'7" x 13'2"
- Family Room
10'7" x 9'1"
- Study
9'7" x 9'1"
- Kitchen / Dining Room
17'7" x 14'4"
- Utility Room
7'5" x 6'2"
- WC
5'8" x 3'1"
- Bedroom One
15'8" x 11'0"
- En Suite
11'0" x 3'11"
- Bedroom Two
11'0" x 10'4"
- En Suite
11'0" x 3'10"
- Bedroom Three
12'5" x 10'11"
- Bedroom Four
10'11" x 10'0"
- Bathroom
6'8" x 6'5"

Energy Efficiency Rating		
	Current	Potential
Very energy efficient - lower running costs		
(92 plus) A		93
(81-91) B	85	
(69-80) C		
(55-68) D		
(39-54) E		
(21-38) F		
(1-20) G		
Not energy efficient - higher running costs		
England & Wales		
EU Directive 2002/91/EC		





More 5 Star Customer Reviews than any other Agent based in the North East on allAgents.co.uk



SALES

LETTINGS

FINANCE

LAW

WE COVER THE WHOLE OF THE NORTH EAST

Whitley Bay
0191 251 3344

Cramlington
01670 897 213

Tynemouth
0191 296 6689

Morpeth
01670 513 966

Ponteland
01661 820 082

Wallsend
0191 432 4151

Alnwick
01665 511 800

Heaton
0191 432 4275

Forest Hall
0191 266 9966

Other locations
0191 640 3523

Newcastle
0191 640 2284

Durham
0191 303 8252

Gosforth
0191 640 3523

Sunderland
0191 543 6390

Whickham
0191 432 5102

Gateshead
0191 432 4294

Jesmond
0191 281 1037

Killingworth
0191 640 3602

Ryton
0191 413 9845

Head Office &
Lettings
0191 253 4815

*Highest recommended 5-star reviews than any other Estate Agent based in the North East on allAgents.co.uk - The UK's Largest Customer Review Website for the Property Industry & Awarded Best Estate Agency 2018 & 2019 - North East England by SME News