

SIGNATURE

NORTH EAST

OFFICIALLY RATED THE NO.1 ESTATE AGENT IN THE NORTH EAST





 Buteland Terrace, Newbiggin-By-The-Sea NE64 6PG

Buteland Terrace, Newbiggin-By-The-Sea NE64 6PG

£139,950

Signature North East welcomes you to Buteland Terrace, Newbiggin-By-The-Sea, a charming 4-bedroom terrace house in a desirable seaside location with a strong sense of community. Local shops and essential services are within easy reach, and the area boasts reputable schools. Well-connected by public transport, commuting to nearby towns and cities is convenient, enhancing accessibility for work and leisure. Nearby attractions and cultural sites offer diverse entertainment options.

Upon entering, the hallway leads to a spacious living room featuring a bay window and a fireplace, perfect for family gatherings. The adjacent dining area offers ample space with natural light streaming through the window. The well-equipped kitchen includes plenty of storage and counter space, along with a washing machine, dishwasher, NEF oven, gas hob, and fridge freezer. A door provides outdoor access to the backyard.

Upstairs, four bedrooms await. Bedrooms one and two are spacious doubles, while the third, also a double, is cosier. The fourth bedroom, is ideal as a home office or nursery. A three-piece shower room with underfloor heating completes this level.

Outside, the low-maintenance backyard is perfect for enjoying sunlight, with access to the single garage, which can be used for parking or storage. There is also direct road access and an available parking permit.



PROPERTY FLOORPLAN

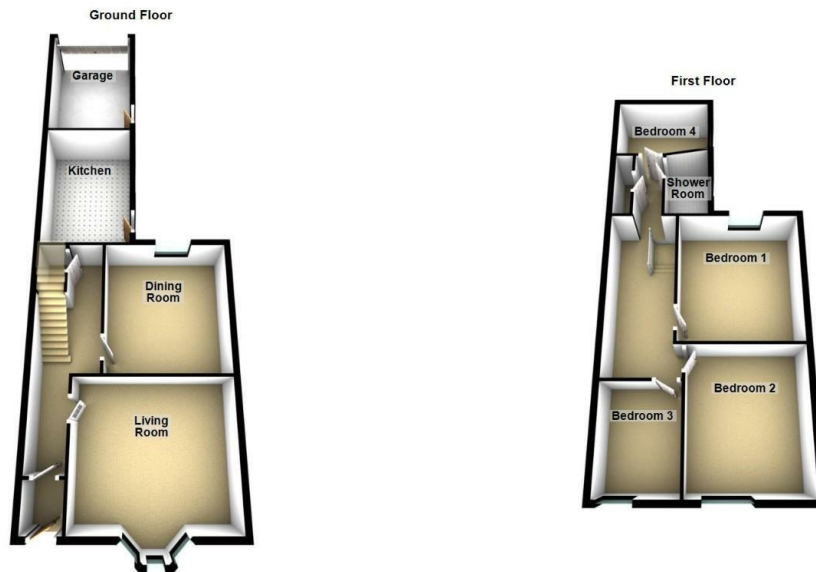

Please be advised the floorplans are not drawn to scale and are to be used to give an idea of the layout of the property.
Plan produced using PlanUp.

Measurements:

Living Room
15'2" x 13'5"

Dining Room
13'4" x 12'3"

Kitchen
14'2" x 9'4"

Bedroom One
13'4" x 12'2"

Bedroom Two
13'4" x 11'4"

Bedroom Three
9'11" x 7'6"

Bedroom Four
9'11" x 6'8"

Shower Room
7'2" x 4'6"

Energy Efficiency Rating

	Current	Potential
Very energy efficient - lower running costs		
(92 plus) A		
(81-91) B		85
(69-80) C	69	
(55-68) D		
(39-54) E		
(21-38) F		
(1-20) G		
Not energy efficient - higher running costs		
England & Wales	EU Directive 2002/91/EC 	





More 5 Star Customer Reviews than any other Agent based in the North East on allAgents.co.uk



SALES

LETTINGS

FINANCE

LAW

WE COVER THE WHOLE OF THE NORTH EAST

Whitley Bay
0191 251 3344

Cramlington
01670 897 213

Tynemouth
0191 296 6689

Morpeth
01670 513 966

Ponteland
01661 820 082

Wallsend
0191 432 4151

Alnwick
01665 511 800

Heaton
0191 432 4275

Forest Hall
0191 266 9966

Other locations
0191 640 3523

Newcastle
0191 640 2284

Durham
0191 303 8252

Gosforth
0191 640 3523

Sunderland
0191 543 6390

Whickham
0191 432 5102

Gateshead
0191 432 4294

Jesmond
0191 281 1037

Killingworth
0191 640 3602

Ryton
0191 413 9845

Head Office &
Lettings
0191 253 4815

*Highest recommended 5-star reviews than any other Estate Agent based in the North East on allAgents.co.uk - The UK's Largest Customer Review Website for the Property Industry & Awarded Best Estate Agency 2018 & 2019 - North East England by SME News