

SIGNATURE

NORTH EAST

OFFICIALLY RATED THE NO.1 ESTATE AGENT IN THE NORTH EAST





 Bertram Court, Morpeth NE65 9DW

Bertram Court, Morpeth NE65 9DW

Asking Price
£325,000

Signature North East is delighted to present Bertram Court, a charming property located in the picturesque village of Felton, Morpeth. This modern detached home features three generously sized bedrooms, making it an ideal choice for growing families or those seeking additional space. Situated in a peaceful neighbourhood, the property offers easy access to a variety of amenities, ensuring convenience for residents. Felton offers a serene rural lifestyle with a close-knit community feel, surrounded by stunning countryside. The area is well-connected to nearby towns, making commuting hassle-free. The location is perfect for anyone seeking a tranquil escape from the busy pace of city life.

Upon entering, you are greeted by a bright and spacious hallway. The living room features two windows that fill the space with natural light, creating a warm and inviting atmosphere. On the opposite side, the open-plan kitchen and dining room is perfect for entertaining, with French doors leading out to the back garden. The kitchen is equipped with a peninsula, integrated dishwasher, fridge freezer, and ample wall and base units for storage and counter space. The utility room complements the kitchen's stylish design and provides additional storage and work surfaces. A WC completes the ground floor.

Upstairs, three well-appointed bedrooms await. The master bedroom includes a three-piece en-suite with a walk-in shower. Bedroom two features a built-in closet and is currently used as a dressing room, while bedroom three, a single room, is set up as a home office. A three-piece family bathroom, complete with a bathtub, rounds off the first floor.

The easy-to-maintain back garden features a patio and lawn area, perfect for outdoor enjoyment. A single garage provides extra storage or space for a car, while the driveway offers an additional parking spot.

Bertram Court is the perfect blend of modern living and rural charm. Call Signature North East and book your viewing today.



PLEASE NOTE THAT THE VENDOR HAS CERTIFIED THE PROPERTY INFORMATION AND IMAGES.

PROPERTY FLOORPLAN

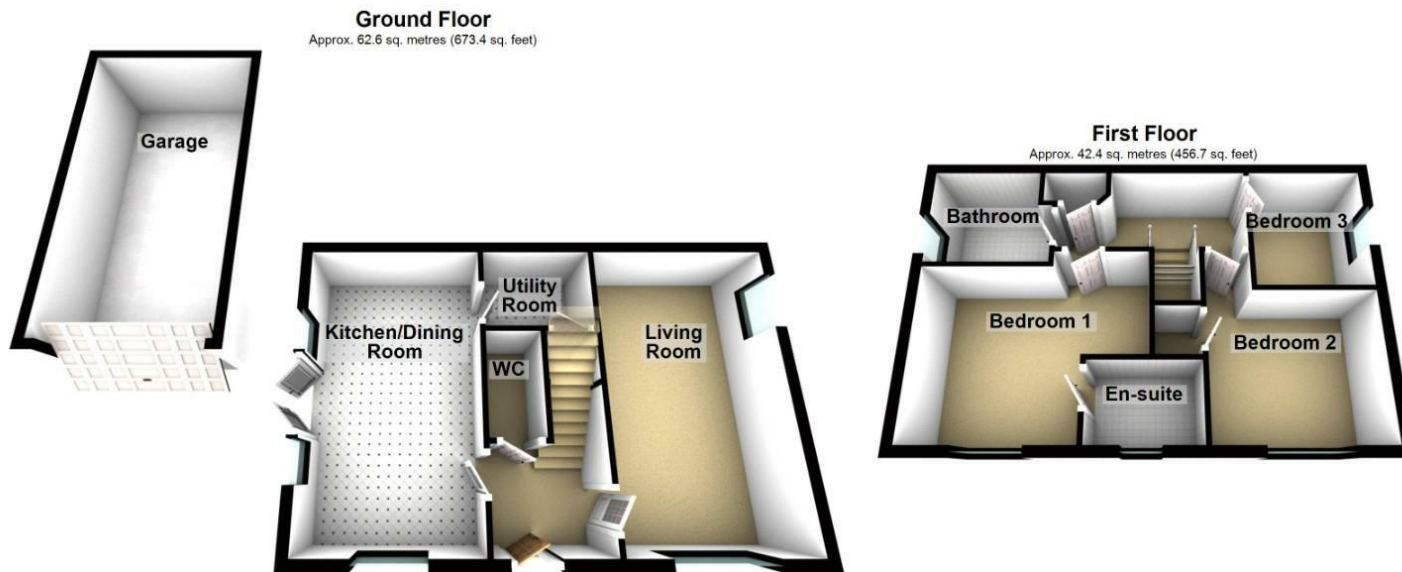

Total area: approx. 105.0 sq. metres (1130.1 sq. feet)

Please be advised the floorplans are not drawn to scale and are to be used to give an idea of the layout of the property.
Plan produced using PlanUp.

Measurements:

Living Room
16'10" x 10'0"

Kitchen / Dining Room
16'10" x 9'11"

Utility Room
6'3" x 4'7"

WC
5'11" x 3'1"

Bedroom One
13'6" x 11'4"

En Suite
6'6" x 4'8"

Bedroom Two
11'3" x 10'2"

Bedroom Three
7'8" x 6'11"

Bathroom
7'8" x 6'2"

Garage
20'4" x 10'8"

Energy Efficiency Rating

	Current	Potential
Very energy efficient - lower running costs		
(92 plus) A		95
(81-91) B	83	
(69-80) C		
(55-68) D		
(39-54) E		
(21-38) F		
(1-20) G		
Not energy efficient - higher running costs		
England & Wales		EU Directive 2002/91/EC 





More 5 Star Customer Reviews than any other Agent based in the North East on allAgents.co.uk



SALES

LETTINGS

FINANCE

LAW

WE COVER THE WHOLE OF THE NORTH EAST

Whitley Bay
0191 251 3344

Cramlington
01670 897 213

Tynemouth
0191 296 6689

Morpeth
01670 513 966

Ponteland
01661 820 082

Wallsend
0191 432 4151

Alnwick
01665 511 800

Heaton
0191 432 4275

Forest Hall
0191 266 9966

Other locations
0191 640 3523

Newcastle
0191 640 2284

Durham
0191 303 8252

Gosforth
0191 640 3523

Sunderland
0191 543 6390

Whickham
0191 432 5102

Gateshead
0191 432 4294

Jesmond
0191 281 1037

Killingworth
0191 640 3602

Ryton
0191 413 9845

Head Office &
Lettings
0191 253 4815

*Highest recommended 5-star reviews than any other Estate Agent based in the North East on allAgents.co.uk - The UK's Largest Customer Review Website for the Property Industry & Awarded Best Estate Agency 2018 & 2019 - North East England by SME News