

SIGNATURE

NORTH EAST

OFFICIALLY RATED THE NO.1 ESTATE AGENT IN THE NORTH EAST





📍 , Morpeth NE61 3SL

/ Morpeth NE61 3SL

Offers In Excess Of £500,000

Signature North East presents this charming detached house in the picturesque area of Dyke Neuk, Morpeth. This property features five spacious bedrooms, ideal for a growing family or those who enjoy hosting guests. Located just 3.5 miles from Mitford and 5.4 miles from Morpeth, this beautiful cottage combines rural charm with the convenience of nearby amenities. The area has excellent road connections, ensuring easy commuting to major cities and seamless movement within the community.

The house offers a well-designed layout with three reception rooms and a kitchen-dining room spread across different levels. Upon entering the spacious hallway, you're welcomed into the kitchen-dining area, which includes an island for extra counter space, a stone fireplace, and a spiral staircase leading to the first floor. French doors open to an outdoor patio, perfect for entertaining. The adjacent sitting room also features a fireplace and external doors to a veranda with stunning countryside views. The sunroom at the front of the property is bathed in natural light and offers panoramic views. The basement provides additional living space with bi-fold doors that blend indoor and outdoor living. The ground floor includes two well-appointed bedrooms, one of which has an en-suite bathroom with a bathtub and shower. A family bathroom with a corner bathtub and walk-in shower completes the ground floor.

On the first floor, a bright and spacious landing leads to the master bedroom, complete with an en-suite, dressing area, and balcony with scenic views. Bedroom four also features a balcony, while bedroom five is filled with natural light. A WC completes this level.

Outside, the house is situated on beautiful grounds with countryside views and ample patio space for outdoor living. The double garage includes extra storage space above.

Imagine waking up to the sound of birds chirping and enjoying your morning coffee in the peaceful surroundings of your own garden. Don't miss out on the chance to own this delightful detached house in Morpeth. Call Signature North East today and book your viewing.



PLEASE NOTE THAT THE VENDOR HAS CERTIFIED THE PROPERTY INFORMATION AND IMAGES.

PROPERTY FLOORPLAN

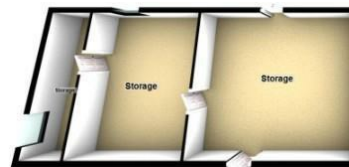
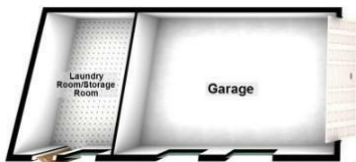
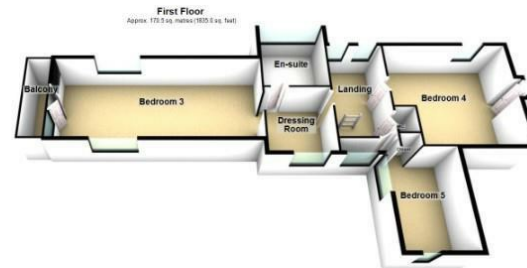
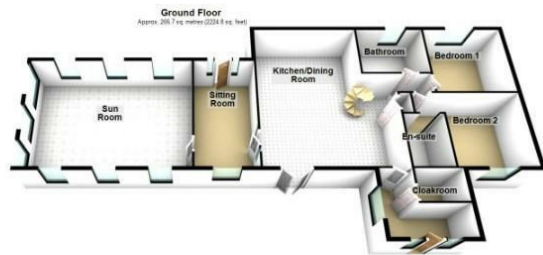

Total area approx. 414.7 sq. metres (4463.3 sq. feet)
Please be advised this floorplan is not drawn to scale and is for illustrative purposes only. It is not intended to be used as a guide to the layout of the property.
*Floor plan created using 3DMax

Measurements:

Kitchen/Dining Room
20'7" x 24'3"

Sitting Room
9'1" x 18'2"

Sun Room
24'5" x 18'2"

Bathroom
8'2" x 10'2"

Bedroom 1
11'8" x 11'10"

Bedroom 2
11'4" x 12'2"

En-suite
5'10" x 8'7"

Cloakroom
6'9" x 4'11"

Hallway
10'1" x 11'7"

Landing
8'2" x 10'9"

Bedroom 3
30'9" x 13'8"

Balcony
3'8" x 13'8"

En-suite
10'9" x 9'7"

Dressing Room
10'9" x 9'7"

Energy Efficiency Rating

	Current	Potential
Very energy efficient - lower running costs		
(92 plus) A		
(81-91) B		
(69-80) C		
(55-68) D		64
(39-54) E	29	
(21-38) F		
(1-20) G		
Not energy efficient - higher running costs		

England & Wales

EU Directive
2002/91/EC







More 5 Star Customer Reviews than any other Agent based in the North East on allAgents.co.uk



SALES

LETTINGS

FINANCE

LAW

WE COVER THE WHOLE OF THE NORTH EAST

Whitley Bay
0191 251 3344

Cramlington
01670 897 213

Tynemouth
0191 296 6689

Morpeth
01670 513 966

Ponteland
01661 820 082

Wallsend
0191 432 4151

Alnwick
01665 511 800

Heaton
0191 432 4275

Forest Hall
0191 266 9966

Other locations
0191 640 3523

Newcastle
0191 640 2284

Durham
0191 303 8252

Gosforth
0191 640 3523

Sunderland
0191 543 6390

Whickham
0191 432 5102

Gateshead
0191 432 4294

Jesmond
0191 281 1037

Killingworth
0191 640 3602

Ryton
0191 413 9845

Head Office &
Lettings
0191 253 4815

*Highest recommended 5-star reviews than any other Estate Agent based in the North East on allAgents.co.uk - The UK's Largest Customer Review Website for the Property Industry & Awarded Best Estate Agency 2018 & 2019 - North East England by SME News