

SIGNATURE

NORTH EAST

OFFICIALLY RATED THE NO.1 ESTATE AGENT IN THE NORTH EAST





 Dacre Street, Morpeth NE61 1HQ

Dacre Street, Morpeth NE61 1HQ

£145,000

Signature North East invites you to Dacre Street, Morpeth—a charming location ideal for those seeking a peaceful and picturesque retirement setting. This delightful flat, nestled in a tranquil retirement community, offers a serene environment for enjoying your golden years. Conveniently located within walking distance of local amenities, shops, and beautiful green spaces, it provides everything needed for a comfortable lifestyle.

Upon entering, you'll find an ample hallway leading to a bright and comfortable living/dining room, perfect for entertaining. The kitchen is well-equipped with wall and base units, a brand-new washer/dryer, and an under-counter fridge, providing seamless access to the dining area for effortless meal preparation.

The living quarters are thoughtfully positioned on the opposite side of the flat, ensuring full relaxation and privacy. There are two well-appointed double bedrooms, with the primary bedroom featuring a fitted wardrobe for added convenience. The bathroom, easily accessible for both family and guests, is fitted with a walk-in shower.

This flat features scenic views of the surrounding greenery, providing a tranquil atmosphere for residents. For added storage convenience, the hallway is equipped with two spacious cupboards. Furthermore, the property offers a dedicated parking bay and a visitor's bay, allowing space for up to two cars.

Don't miss this fantastic opportunity to own a retirement flat in Morpeth and embrace a relaxed lifestyle in this lovely property. Call Signature North East today to book your viewing!



PLEASE NOTE THAT THE VENDOR HAS CERTIFIED THE PROPERTY INFORMATION AND IMAGES.

PROPERTY FLOORPLAN

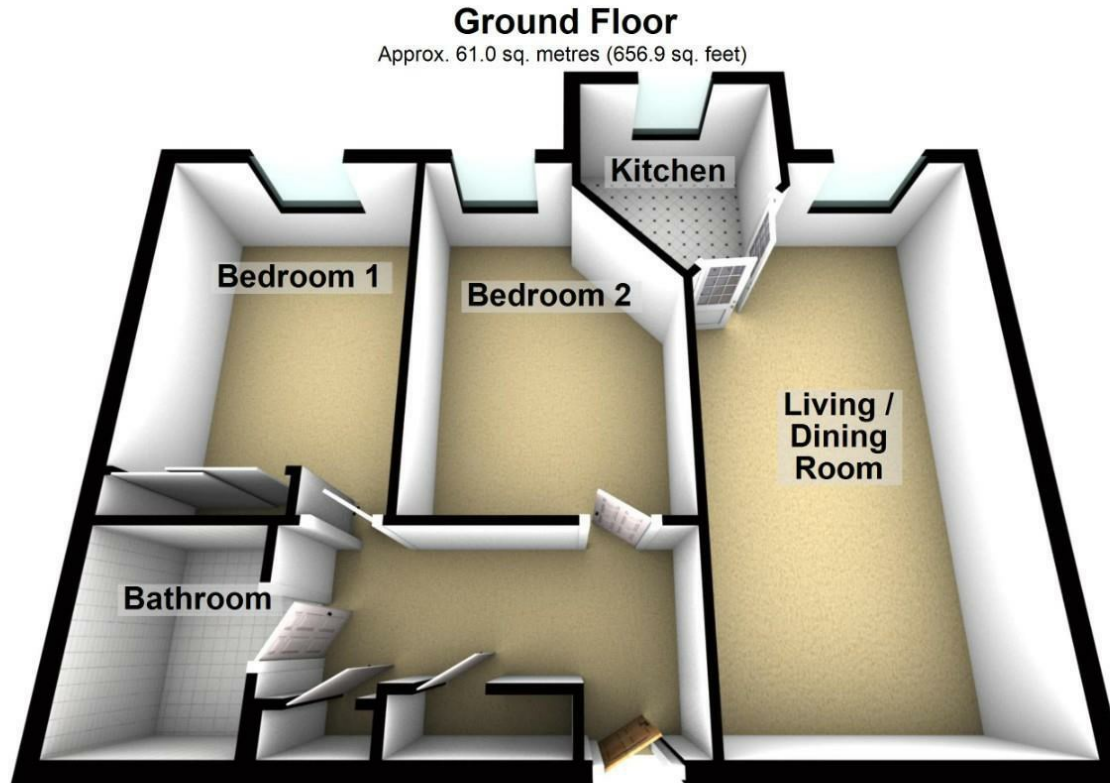

Total area: approx. 61.0 sq. metres (656.9 sq. feet)

Please be advised the floorplans are not drawn to scale and are to be used to give an idea of the layout of the property.

Plan produced using PlanUp.

Measurements:

Living / Dining Room
20'8" x 10'8"

Kitchen
8'7" x 7'7"

Bedroom One
13'8" x 9'3"

Bedroom Two
13'9" x 9'7"

Bathroom
6'10" x 5'6"

Energy Efficiency Rating

	Current	Potential
Very energy efficient - lower running costs		
(92 plus) A		
(81-91) B	78	81
(69-80) C		
(55-68) D		
(39-54) E		
(21-38) F		
(1-20) G		
Not energy efficient - higher running costs		
England & Wales		EU Directive 2002/91/EC 





More 5 Star Customer Reviews than any other Agent based in the North East on allAgents.co.uk



SALES

LETTINGS

FINANCE

LAW

WE COVER THE WHOLE OF THE NORTH EAST

Whitley Bay
0191 251 3344

Cramlington
01670 897 213

Tynemouth
0191 296 6689

Morpeth
01670 513 966

Ponteland
01661 820 082

Wallsend
0191 432 4151

Alnwick
01665 511 800

Heaton
0191 432 4275

Forest Hall
0191 266 9966

Other locations
0191 640 3523

Newcastle
0191 640 2284

Durham
0191 303 8252

Gosforth
0191 640 3523

Sunderland
0191 543 6390

Whickham
0191 432 5102

Gateshead
0191 432 4294

Jesmond
0191 281 1037

Killingworth
0191 640 3602

Ryton
0191 413 9845

Head Office &
Lettings
0191 253 4815

*Highest recommended 5-star reviews than any other Estate Agent based in the North East on allAgents.co.uk - The UK's Largest Customer Review Website for the Property Industry & Awarded Best Estate Agency 2018 & 2019 - North East England by SME News