

SIGNATURE

NORTH EAST

OFFICIALLY RATED THE NO.1 ESTATE AGENT IN THE NORTH EAST





📍 Back Mount Terrace, Morpeth NE65 7QY

Back Mount Terrace, Morpeth NE65 7QY

Guide Price £325,000

Signature North East proudly welcomes you to Back Mount Terrace in the picturesque village of Rothbury. Situated in the tranquil surroundings of Rothbury, this charming cottage offers a peaceful retreat and is currently serving as a holiday let. Rothbury, a serene market town at the heart of Northumberland's countryside, is known for its natural beauty, historic attractions like Craggside House, scenic walks, outdoor exploration, and plentiful local amenities.

Upon entering the property, you are greeted by a warm and inviting atmosphere, perfect for relaxing or entertaining guests. The welcoming hallway serves as the central artery of this comfortable cottage. To your right, the kitchen offers ample storage with numerous base units and shelves, and a window that lets in natural light. Sliding doors lead to the sun/living room, where glass walls provide stunning views of the property grounds. A set of French doors offers outdoor access. The formal living room, featuring French doors to an outside balcony/deck, seamlessly blends the indoors with the outdoors. For chilly nights, the fireplace provides cosy comfort.

Adjacent to this space, Bedroom One is a retreat decorated with soothing colours and countryside views. Bedroom Two offers another comfortable space for family or guests, and a tastefully decorated three-piece bathroom with a walk-in shower serves the ground floor. On the first floor, a third bedroom awaits, complete with a three-piece en-suite bathroom featuring a relaxing bathtub and breath-taking views of the Rothbury hills.

With tasteful decoration throughout, a modern feel, and a soothing colour palette, the indoor beauty of this cottage is matched by its outdoor charm. The beautifully landscaped grounds offer various levels for relaxation, including a fire pit, green grass with raised beds, and a tree swing. Parking is available for up to three cars, and there is an electric charging point.

Rothbury's landscape and history invite you to own a piece of this countryside haven. Don't miss the opportunity to relax in or continue the potential investment of this lovely property. Call Signature North East today to book your viewing.



PLEASE NOTE THAT THE VENDOR HAS CERTIFIED THE PROPERTY INFORMATION AND IMAGES.

PROPERTY FLOORPLAN

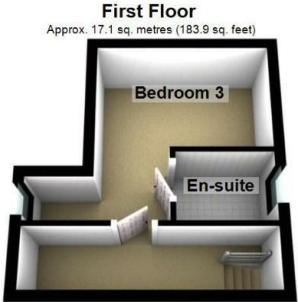
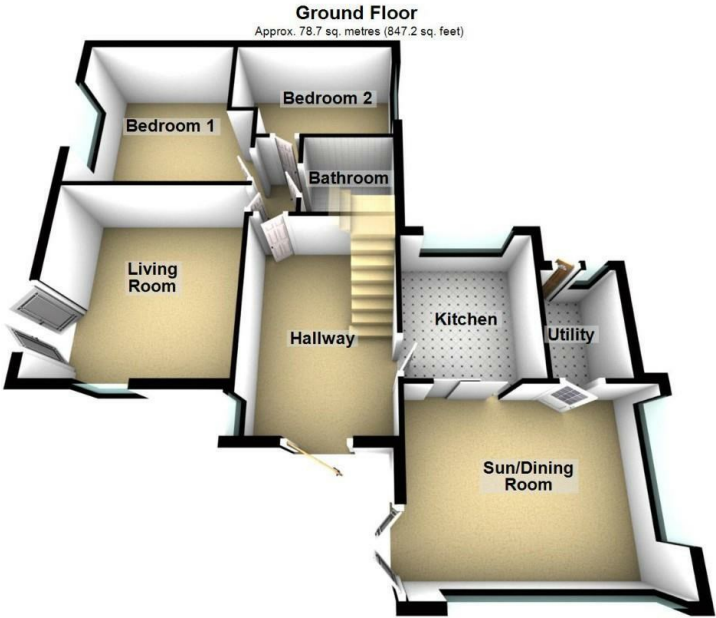

Total area: approx. 95.8 sq. metres (1031.1 sq. feet)
Please be advised the floorplans are not drawn to scale and are to be used to give an idea of the layout of the property.
Plan produced using PlanUp.

Measurements:

Living Room
12'11" x 12'2"

Bedroom 1
12'2" x 11'5"

Bedroom 2
11'3" x 7'8"

Bathroom
4'3" x 6'0"

Kitchen
8'3" x 9'3"

Sun/Dining Room
11'1" x 14'7"

Utility Room
4'7" x 6'9"

Bedroom 3
10'5" x 8'4"

En-Suite
5'1" x 5'1"

Energy Efficiency Rating		
	Current	Potential
Very energy efficient - lower running costs		
(92 plus) A		78
(81-91) B		
(69-80) C		
(55-68) D	59	
(39-54) E		
(21-38) F		
(1-20) G		
Not energy efficient - higher running costs		
England & Wales		EU Directive 2002/91/EC





More 5 Star Customer Reviews than any other Agent based in the North East on [allAgents.co.uk](https://allagents.co.uk)



SALES

LETTINGS

FINANCE

LAW

WE COVER THE WHOLE OF THE NORTH EAST

Whitley Bay
0191 251 3344

Cramlington
01670 897 213

Tynemouth
0191 296 6689

Morpeth
01670 513 966

Ponteland
01661 820 082

Wallsend
0191 432 4151

Alnwick
01665 511 800

Heaton
0191 432 4275

Forest Hall
0191 266 9966

Other locations
0191 640 3523

Newcastle
0191 640 2284

Durham
0191 303 8252

Gosforth
0191 640 3523

Sunderland
0191 543 6390

Whickham
0191 432 5102

Gateshead
0191 432 4294

Jesmond
0191 281 1037

Killingworth
0191 640 3602

Ryton
0191 413 9845

Head Office &
Lettings
0191 253 4815

*Highest recommended 5-star reviews than any other Estate Agent based in the North East on [allAgents.co.uk](https://allagents.co.uk) - The UK's Largest Customer Review Website for the Property Industry & Awarded Best Estate Agency 2018 & 2019 - North East England by SME News