

SIGNATURE

NORTH EAST

OFFICIALLY RATED THE NO.1 ESTATE AGENT IN THE NORTH EAST





 Ulgham Lane, Morpeth NE61 3NF

Ulgham Lane, Morpeth NE61 3NF

Guide Price £650,000

Signature North East is delighted to welcome to the market this stunning 4-bedroom detached property, ideally located between Longhirst and Ulgham, Morpeth. Nestled in a superb location, the property boasts generous rooms and is in close proximity to the gorgeous Druridge Bay, perfect for beach lovers. The town centre of Morpeth is nearby, providing excellent transport links across the country via its train station, with routes to Newcastle city centre, Edinburgh, and even London. This home is perfect for families, with Pegswood Primary School just a 5-minute drive away. Surrounded by abundant greenery and outdoor space, it offers a haven for outdoor enthusiasts.

Upon entering, you are greeted by a central hallway leading to a large living room, featuring ample space for your desired furnishings. A large window bathes the room in natural light, and a beautiful fireplace serves as a focal point. The open-plan kitchen and dining area can comfortably accommodate a dining table, with a handy adjacent pantry. The kitchen provides ample space with attractive wall and base units, complemented by sleek countertops, and is equipped with integrated appliances, including a range cooker with ceramic hob. Elegant French doors lead to the rear garden, enhancing the indoor-outdoor flow. Completing this floor is a convenient utility room and a bathroom featuring a bath, W.C., and hand basin.

Continuing your journey to the first floor, you will discover four bedrooms. Bedrooms 1 and 2 are generously sized and offer ample storage solutions, with Bedroom 1 and 2 feature fitted wardrobes. Bedrooms 3 and 4 provide versatile options, perfect as children's rooms, home offices, or dressing rooms. Completing this floor is a shower room, equipped with a walk-in shower, hand basin, and W.C.

Externally, this home boasts a large garden laid to lawn, perfect for outdoor furniture, and offers 6 acres of land. At the end of the garden, there is a let property, ideal for Airbnb and providing a consistent income. This fully kitted-out let property includes a kitchen area, sitting area, bedroom, and a convenient bathroom, ensuring privacy as it is far enough from the main house. The property also features parking on the driveway for four cars comfortably and a double garage. Adding an extra layer of privacy, the property is equipped with electric gates.



PLEASE NOTE THAT THE VENDOR HAS CERTIFIED THE PROPERTY INFORMATION AND IMAGES.

PROPERTY FLOORPLAN

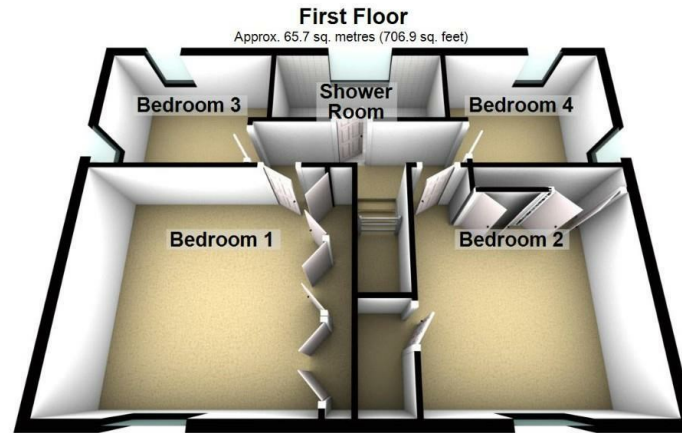
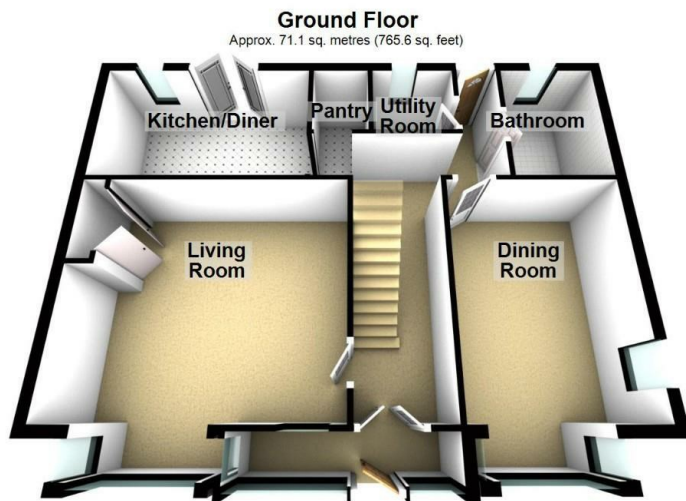

Total area: approx. 136.8 sq. metres (1472.5 sq. feet)
 Please be advised the floorplans are not drawn to scale and are to be used to give an idea of the layout of the property.
 Plan produced using PlanUp.

Measurements:

Living Room
13'11" x 15'10"

Dining Room
13'11" x 10'3"

Bathroom
6'0" x 8'0"

Utility Room
5'3" x 4'8"

Pantry
3'6" x 4'8"

Kitchen/Diner
13'3" x 8'0"

Bedroom 1
13'11" x 15'10"

Bedroom 2
13'11" x 12'8"

Bedroom 3
8'0" x 9'3"

Bedroom 4
8'0" x 10'0"

Shower Room
4'9" x 10'10"

Energy Efficiency Rating

	Current	Potential
Very energy efficient - lower running costs		
(92 plus) A		97
(81-91) B		
(69-80) C		
(55-68) D		
(39-54) E	34	
(21-38) F		
(1-20) G		
Not energy efficient - higher running costs		
England & Wales	EU Directive 2002/91/EC 	





More 5 Star Customer Reviews than any other Agent based in the North East on allAgents.co.uk



SALES

LETTINGS

FINANCE

LAW

WE COVER THE WHOLE OF THE NORTH EAST

Whitley Bay
0191 251 3344

Cramlington
01670 897 213

Tynemouth
0191 296 6689

Morpeth
01670 513 966

Ponteland
01661 820 082

Wallsend
0191 432 4151

Alnwick
01665 511 800

Heaton
0191 432 4275

Forest Hall
0191 266 9966

Other locations
0191 640 3523

Newcastle
0191 640 2284

Durham
0191 303 8252

Gosforth
0191 640 3523

Sunderland
0191 543 6390

Whickham
0191 432 5102

Gateshead
0191 432 4294

Jesmond
0191 281 1037

Killingworth
0191 640 3602

Ryton
0191 413 9845

Head Office &
Lettings
0191 253 4815

*Highest recommended 5-star reviews than any other Estate Agent based in the North East on allAgents.co.uk - The UK's Largest Customer Review Website for the Property Industry & Awarded Best Estate Agency 2018 & 2019 - North East England by SME News