

SIGNATURE

NORTH EAST

OFFICIALLY RATED THE NO.1 ESTATE AGENT IN THE NORTH EAST





 Cramond Way, Cramlington NE23 6LA

Cramond Way, Cramlington NE23 6LA

Offers Over £140,000

Welcome to Signature North East, where we proudly present this charming property now gracing the market. Nestled in the southern part of Cramlington, merely 6 miles from the vibrant heart of Newcastle, this semi-detached 3-bedroom, 1-bath house beckons young families and those seeking to downsize into a cosy, welcoming home. Cramlington, renowned for its tranquil ambience, offers an ideal setting, seamlessly blending the allure of Northumberland's countryside with the urban pulse of Newcastle. Notably, residents can revel in the unique land sculpture of Northumberlandia and indulge in leisurely pursuits at Manor Walks, a local haven boasting shopping, dining, cinema, and more.

Step through the threshold into the hallway, your gateway to the ground floor's principal spaces. The spacious Living/Dining room awaits, offering ample room for your preferred furnishings, while the kitchen beckons with abundant storage within its wall and base units, complemented by a hob and oven. Convenient outdoor access to the back garden is granted through a door, perfect for al fresco dining or leisurely moments outdoors.

Ascending to the first floor, discover three generously proportioned bedrooms, two of which easily accommodate double beds alongside additional furnishings. Completing this level is the well-lit family bathroom, featuring a bathtub, hand basin, and WC, ensuring comfort and convenience for the household.

Externally, this residence boasts a patio and laid-back garden, ideal for relaxation and outdoor gatherings. Further enhancing convenience are two off-street parking spaces and a garage located at the rear of the property, providing secure storage and ease of access.

This property eagerly awaits its new occupants, ready to envelop them in comfort and warmth. Contact Signature North East today to arrange your exclusive viewing and embark on the journey to making this house your cherished home.



PLEASE NOTE THAT THE VENDOR HAS CERTIFIED THE PROPERTY INFORMATION AND IMAGES.

PROPERTY FLOORPLAN

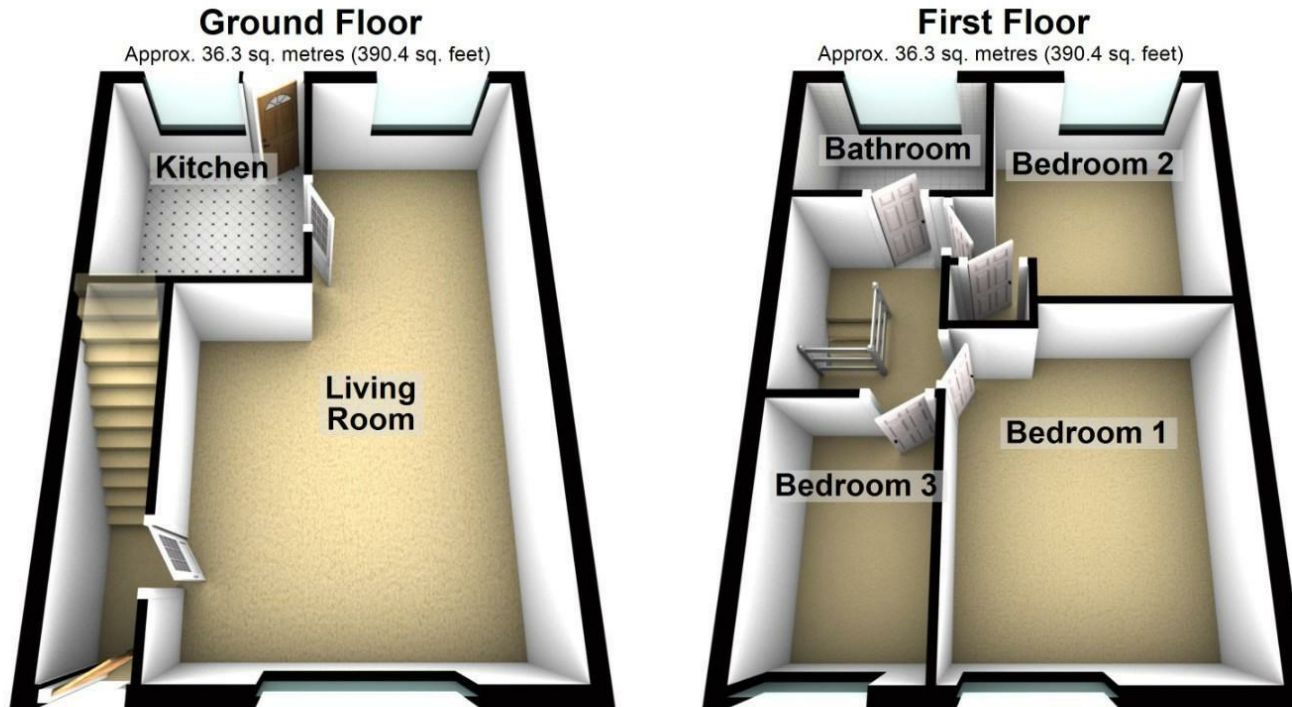

Total area: approx. 72.5 sq. metres (780.9 sq. feet)

Please be advised the floorplans are not drawn to scale and are to be used to give an idea of the layout of the property.
Plan produced using PlanUp.

Measurements:

Living Room
23'2" x 13'7"

Kitchen
9'2" x 8'0"

Bedroom One
12'11" x 10'6"

Bedroom Two
10'6" x 10'0"

Bedroom Three
9'1" x 6'0"

Bathroom
7'7" x 5'4"

Energy Efficiency Rating

	Current	Potential
Very energy efficient - lower running costs		
(92 plus) A		86
(81-91) B		
(69-80) C	72	
(55-68) D		
(39-54) E		
(21-38) F		
(1-20) G		
Not energy efficient - higher running costs		
England & Wales		EU Directive 2002/91/EC 





More 5 Star Customer Reviews than any other Agent based in the North East on allAgents.co.uk



SALES

LETTINGS

FINANCE

LAW

WE COVER THE WHOLE OF THE NORTH EAST

Whitley Bay
0191 251 3344

Cramlington
01670 897 213

Tynemouth
0191 296 6689

Morpeth
01670 513 966

Ponteland
01661 820 082

Wallsend
0191 432 4151

Alnwick
01665 511 800

Heaton
0191 432 4275

Forest Hall
0191 266 9966

Other locations
0191 640 3523

Newcastle
0191 640 2284

Durham
0191 303 8252

Gosforth
0191 640 3523

Sunderland
0191 543 6390

Whickham
0191 432 5102

Gateshead
0191 432 4294

Jesmond
0191 281 1037

Killingworth
0191 640 3602

Ryton
0191 413 9845

Head Office &
Lettings
0191 253 4815

*Highest recommended 5-star reviews than any other Estate Agent based in the North East on allAgents.co.uk - The UK's Largest Customer Review Website for the Property Industry & Awarded Best Estate Agency 2018 & 2019 - North East England by SME News