

SIGNATURE

NORTH EAST

OFFICIALLY RATED THE NO.1 ESTATE AGENT IN THE NORTH EAST





 Brookside Place, Hexham NE48 2AL

Brookside Place, Hexham NE48 2AL

Offers Over £165,000

Signature North East is delighted to present this charming 2-bedroom terraced cottage situated in the tranquil setting of Bellingham in Northumberland. This property not only provides a comfortable living space but also holds great potential for holiday letting, having been booked out for two consecutive years. Its enviable location offers proximity to cherished parks like Hareshaw Lin Waterfall, local shops, and restaurants, making it an excellent opportunity for those seeking a countryside home.

Upon stepping into this property, you are welcomed into the spacious living room, offering ample space for your preferred furnishings. The room features a beautiful log burner fireplace, creating an ideal cosy ambiance. Moving forward, you will discover the kitchen, which provides storage space through shaker-style wall and base units. The kitchen is also equipped with brand new integrated appliances, including a washing machine, oven, and hob.

Ascending to the first floor, you will discover two generously sized bedrooms, each easily accommodating a double bed along with furnishings. Completing the first floor is the bathroom, featuring a bathtub, hand basin, and WC.

Externally, to the rear of the property, you will discover a spacious back garden that offers ample space for outdoor living furniture.



PLEASE NOTE THAT THE VENDOR HAS CERTIFIED THE PROPERTY INFORMATION AND IMAGES.

PROPERTY FLOORPLAN

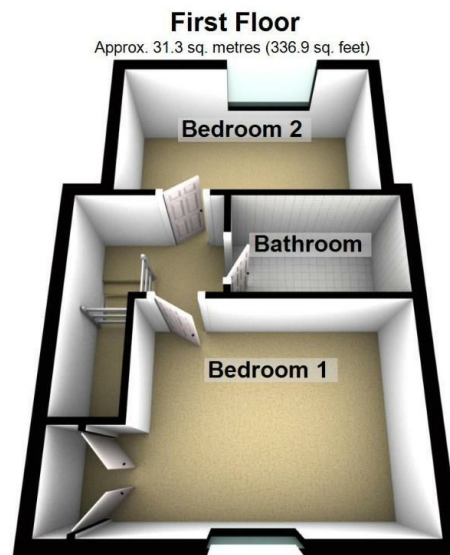
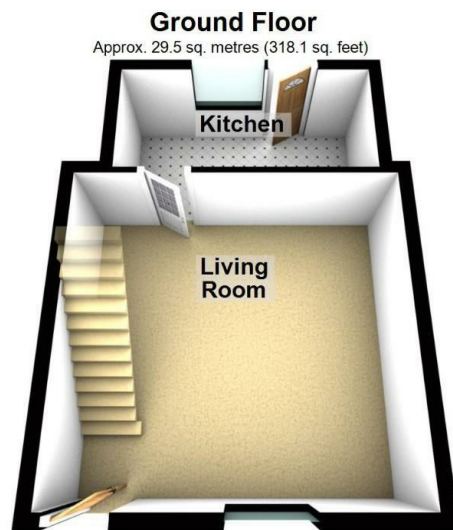

Total area: approx. 60.8 sq. metres (654.9 sq. feet)

Please be advised the floorplans are not drawn to scale and are to be used to give an idea of the layout of the property.
Plan produced using PlanUp.

Measurements:

Living Room
15'8" x 15'0"

Kitchen
12'11" x 5'11"

Bedroom One
15'8" x 9'10"

Bedroom Two
12'11" x 7'4"

Bathroom
8'1" x 4'11"

Energy Efficiency Rating

	Current	Potential
Very energy efficient - lower running costs		
(92 plus) A		
(81-91) B		77
(69-80) C		
(55-68) D	56	
(39-54) E		
(21-38) F		
(1-20) G		
Not energy efficient - higher running costs		

England & Wales

EU Directive
2002/91/EC







More 5 Star Customer Reviews than any other Agent based in the North East on allAgents.co.uk



SALES

LETTINGS

FINANCE

LAW

WE COVER THE WHOLE OF THE NORTH EAST

Whitley Bay
0191 251 3344

Cramlington
01670 897 213

Tynemouth
0191 296 6689

Morpeth
01670 513 966

Ponteland
01661 820 082

Wallsend
0191 432 4151

Alnwick
01665 511 800

Heaton
0191 432 4275

Forest Hall
0191 266 9966

Other locations
0191 640 3523

Newcastle
0191 640 2284

Durham
0191 303 8252

Gosforth
0191 640 3523

Sunderland
0191 543 6390

Whickham
0191 432 5102

Gateshead
0191 432 4294

Jesmond
0191 281 1037

Killingworth
0191 640 3602

Ryton
0191 413 9845

Head Office &
Lettings
0191 253 4815

*Highest recommended 5-star reviews than any other Estate Agent based in the North East on allAgents.co.uk - The UK's Largest Customer Review Website for the Property Industry & Awarded Best Estate Agency 2018 & 2019 - North East England by SME News