



## 9 Aldsworth Gardens

, Portsmouth, PO6 1QS

Offers in the region of £399,950





# 9 Aldsworth Gardens

, Portsmouth, PO6 1QS

Offers in the region of £399,950



## Welcome to Aldsworth Gardens...

Welcome to this beautifully presented semi-detached house located in the desirable Aldsworth Gardens, Portsmouth. This charming property boasts driveway suitable for multiple vehicles, a large garage and summer house, an open plan kitchen diner and three well-proportioned bedrooms, making it an ideal family home.

As you enter, you are greeted by a spacious hallway great for storing coats and shoes that leads into a comfortable living room, with ample space for multiple sofas and furnishings, complete with an electric fire, perfect for cosy evenings.

The kitchen diner is a highlight of the home, providing a wonderful space for family meals and entertaining guests. The kitchen is equipped with a range of floor and wall mounted units, an oven with induction hob, sink with drainer, dishwasher, with a breakfast bar style island. The dining area is suitable for a large family table, with double doors leading out onto the garden.

Upstairs, you will find three generously sized bedrooms. The master bedroom is complete with fitted wardrobes and offers space for a large king size bed and other furnishings. There is then a double room, and a single bedroom.

The family bathroom features a bath, with overhead shower, toilet, sink and radiator.

Set on a corner plot, this property benefits from a large garden, perfect for outdoor activities and summer gatherings. Additionally, there is a delightful summer house, complete with electricity, currently used as a home bar / office. The large garage offers ample storage space and is large enough to fit a vehicle, with plumbing for washing facilities, while the double driveway provides convenient off-road parking.

Situated in Aldsworth Gardens, you are within close proximity to a range of local amenities and good transport links. For families, there are excellent schools within walking distance, with Solent and Court Lane being in catchment.

This lovely home is well-presented throughout with many great features, making it a perfect choice for families or anyone seeking a peaceful retreat in Drayton, Portsmouth. Don't miss the opportunity to make this wonderful property your own. Please contact the office to arrange your viewing appointment.

- BEAUTIFULLY PRESENTED THROUGHOUT
- SEMI DETACHED CORNER PLOT
- LARGE DRIVEWAY & GARAGE
- OPEN PLAN KITCHEN DINER
- SUMMER HOUSE
- THREE BEDROOMS
- EXCELLENT FAMILY HOME
- GOOD SCHOOL CATHCMENT





Road Map



Hybrid Map



Terrain Map



Floor Plan

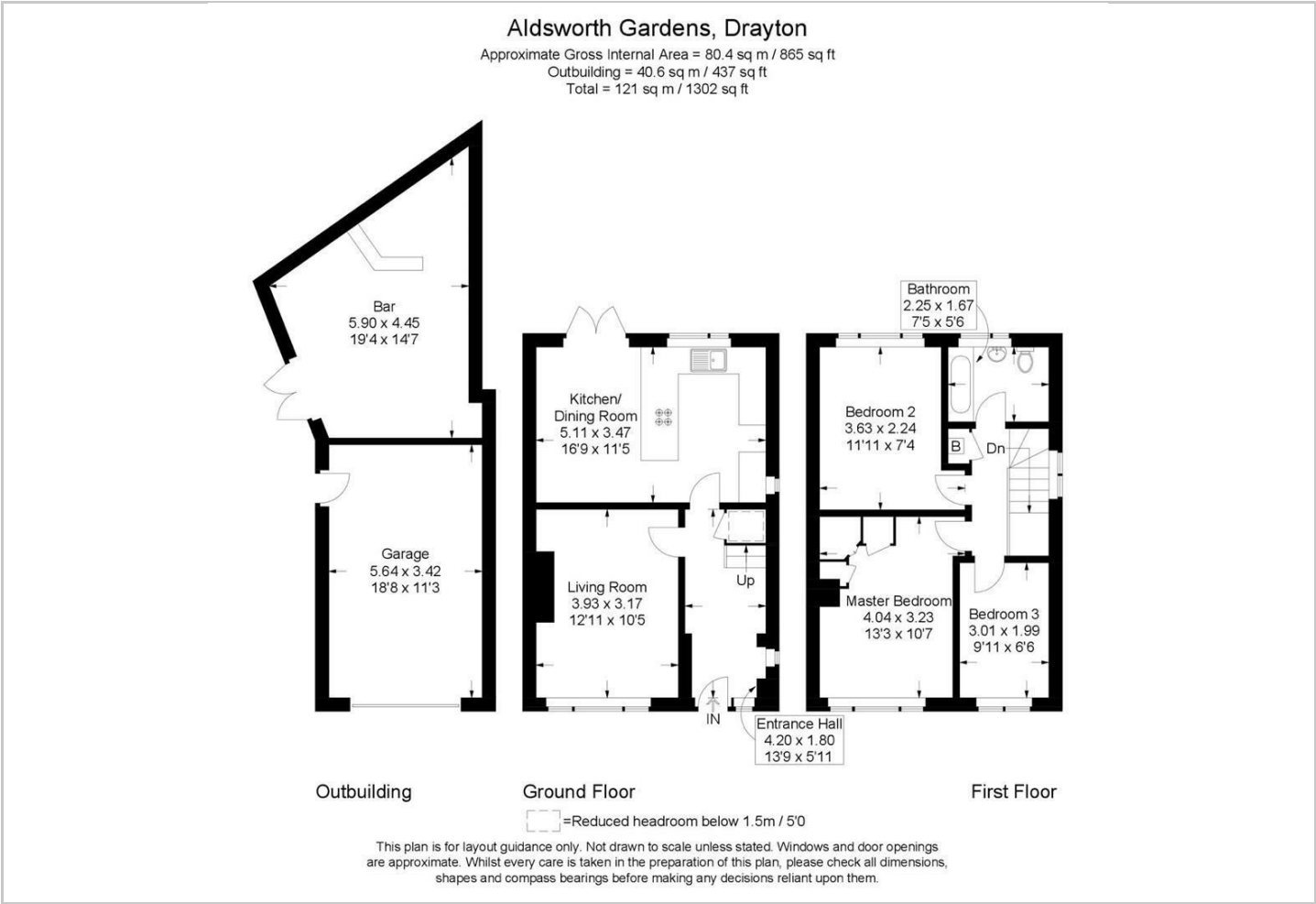

Viewing

Please contact our Central Office on 02394 217317 if you wish to arrange a viewing appointment for this property or require further information.

Energy Efficiency Graph

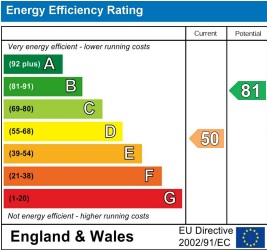

These particulars, whilst believed to be accurate are set out as a general outline only for guidance and do not constitute any part of an offer or contract. Intending purchasers should not rely on them as statements of representation of fact, but must satisfy themselves by inspection or otherwise as to their accuracy. No person in this firms employment has the authority to make or give any representation or warranty in respect of the property.