



81 Mitchell Road

Bedhampton, Havant, PO9 3QA

Offers in excess of £390,000



81 Mitchell Road

Bedhampton, Havant, PO9 3QA

Offers in excess of £390,000



Welcome to Mitchell Road...

This exceptionally presented, three bedroom semi-detached home in Bedhampton is welcomed to the market for sale. The detached garden room housing an impressive bar will no doubt be one of the most popular features, whilst the extension added to the kitchen diner to create a playspace/family room, is something most people only dream of! Perfectly positioned for the commuter with easy access to both the A3 and A27, this refurbished family home is a must view this weekend!

Entering via the front door, you arrive in the entrance hall which has stairs to the first floor and doors to the ground floor rooms. The entire ground floor is finished with stylish grey floor-tiling in a Herringbone style, giving a sleek and contemporary feel. The snug lounge occupies a position at the front of the home with a large double glazed window with views across the green to the front. The room is adorned with TV and power sockets.

The heart of the home is the spot-lit extended kitchen diner and family room, which gives ample dining and playspace. The kitchen itself is fitted with a range of wall and base units with a range of integrated appliances including double oven, dishwasher, fridge freezer and Butler sink. There are doors and windows on to the garden and a door to the side elevation also, which leads to the driveway and outbuildings housing a utility room and office space.

On the first floor there is a spacious landing, three good-sized bedrooms and a family bathroom. All three bedrooms have a double glazed window to the respective elevation, each has a built-in wardrobe and

the rooms are finished with carpet.

The family bathroom is fitted with a white suite comprising a P-shaped bath, Vanity sink and storage, low-level flush WC and heated towel rail. The walls are part tiled and the room is finished with floor tiling.

Externally the property boasts a landscaped rear garden which is low maintenance but an ideal space to entertain, have the kids play out and truly enjoy in the Summer! The detached bar is clad and has French Doors from the garden. The 'bar' itself has power and lighting and is finished with spotlights, wall-mounted panel heaters and floor tiling. This is a truly amazing space which could be used as a kids den, salon, office, music room or more!

To the front this property benefits from a resin driveway, with dropped kerb, providing off-road parking for at least 2 vehicles.

Viewings are strictly by appointment only... Weekends preferred.

Bedhampton...

Bedhampton is a charming village in Havant, Hampshire. It's a great mix of old and new, with cute, period cottages, an ancient church, and the lovely Hermitage Stream. This village has a long history, even mentioned in the Domesday Book. Today, Bedhampton is a lively community with local shops, schools, and parks, offering a peaceful but convenient lifestyle. Its close proximity to both the countryside and the coast makes it a great spot for those who want a bit of tranquility while still being near bigger towns like Portsmouth and Chichester. This property is

within 5 minutes drive of both junctions for the A27 and A3M - ideal for commuting.



Road Map



Hybrid Map



Terrain Map

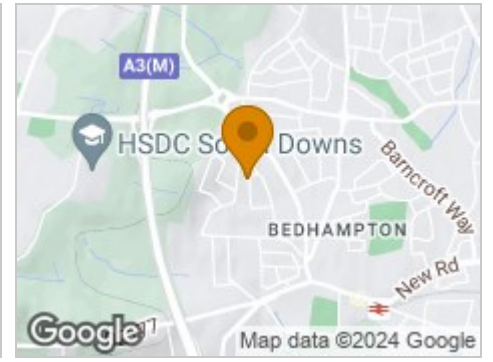

Floor Plan

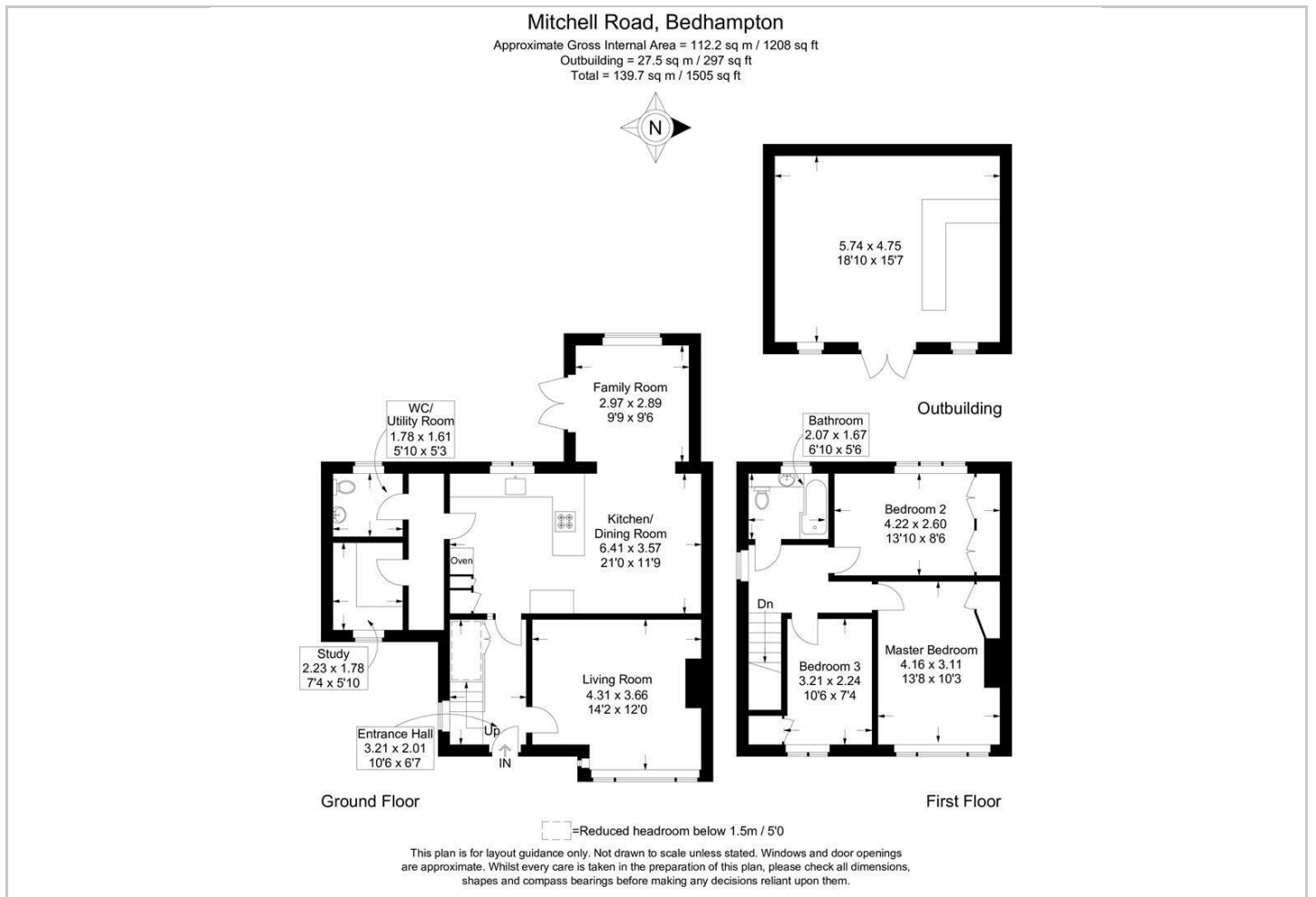

Viewing

Please contact our Central Office on 02394 217317 if you wish to arrange a viewing appointment for this property or require further information.

Energy Efficiency Graph

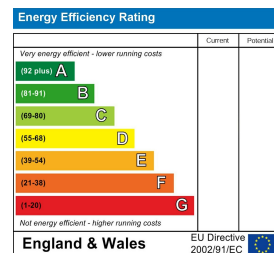

These particulars, whilst believed to be accurate are set out as a general outline only for guidance and do not constitute any part of an offer or contract. Intending purchasers should not rely on them as statements of representation of fact, but must satisfy themselves by inspection or otherwise as to their accuracy. No person in this firm's employment has the authority to make or give any representation or warranty in respect of the property.