



## 6 Blenheim Road

Horndean, Waterlooville, PO8 9TQ

Guide price £400,000



# 6 Blenheim Road

Horndean, Waterlooville, P08 9TQ

Guide price £400,000



£400,000 - £415,000 GUIDE PRICE...

Welcome to Blenheim Road... This four bedroom semi-detached chalet bungalow is situated in a quiet cul-de-sac location within the popular village of Horndean. Benefiting in brief from four bedrooms, two bathrooms, large reception areas and sizeable plot, this property could be improved throughout and your own stamp added, to create a fantastic home in an enviable location.

Entering via the front door you arrive in the spacious entrance hall which has doors to all ground floor rooms and turning stairs to the first floor. Occupying the front aspect of the home, is two ground floor bedrooms, each with a window to that elevation, overlooking the front garden. There is also a neighbouring family bathroom suite, fitted with a panel enclosed bath with shower over, wash hand basin and low-level flush WC. Having the layout arranged like this means the property can be used as a bungalow with living all on one floor if so required.

The living accommodation for this property occupies the back half of the home and is made up of a large lounge diner, with patio doors on to the garden and a large kitchen, which have been previously been extended to maximise the space in this home. The kitchen itself is fitted with a large range of wall and base units with roll-edge work surfaces over with an inset stainless steel sink and drainer and room for freestanding appliances. There are double aspect windows and a door to the side, providing access to the garden and garage.

The lounge diner is made up of two separate rooms

which has been knocked through to create a flowing open space but with plenty of room for a sofa suite, dining table and additional furniture. This room could easily accommodate a play space and/or office and is adorned with the necessary TV and telephone points.

On the first floor, there are two large double bedrooms and an additional bathroom. This bathroom is fitted with a stylish roll-top bath, and low-level flush WC and wash hand basin. There is a Velux skylight and additional storage shelving.

The two bedrooms on this floor are both large doubles, with a window to the respective elevation and one room enjoys fitted wardrobe storage space. There is also further eaves storage which is accessed via the bathroom.

Externally the property benefits from an L-shaped garden and in our opinion, a fair sized plot which is laid to lawn. Previous owners have brought an additional section of the garden which explains the larger than average garden. There is lots of room to landscape the garden, add a summerhouse or garden room, room for vegetable planters or even extend across (subject to necessary permissions).

To the front there is a garden with is largely laid to lawn with vehicular access to the concrete driveway and the garage, via the dropped kerb. The front garden could be made into a larger driveway if so required.

The garage has an up and over door and power.

VIEWINGS ARE STRICTLY BY APPOINTMENT ONLY  
BUT AVAILABLE 7 DAYS A WEEK WITH PRE-BOOKING...

Tel: 02394 217317

## Location

This property is situated in a small cul-de-sac separate from the main part of Blenheim Road. Easy access to the A3 can be made via Keydell Avenue and Portsmouth Road.



## Road Map

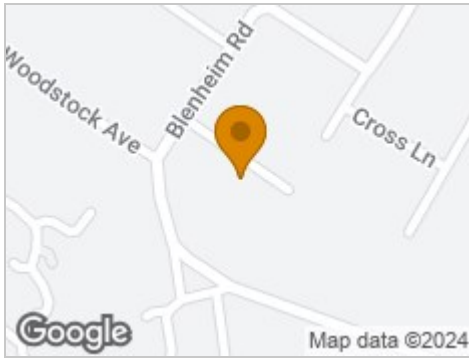

## Hybrid Map



## Terrain Map



## Floor Plan

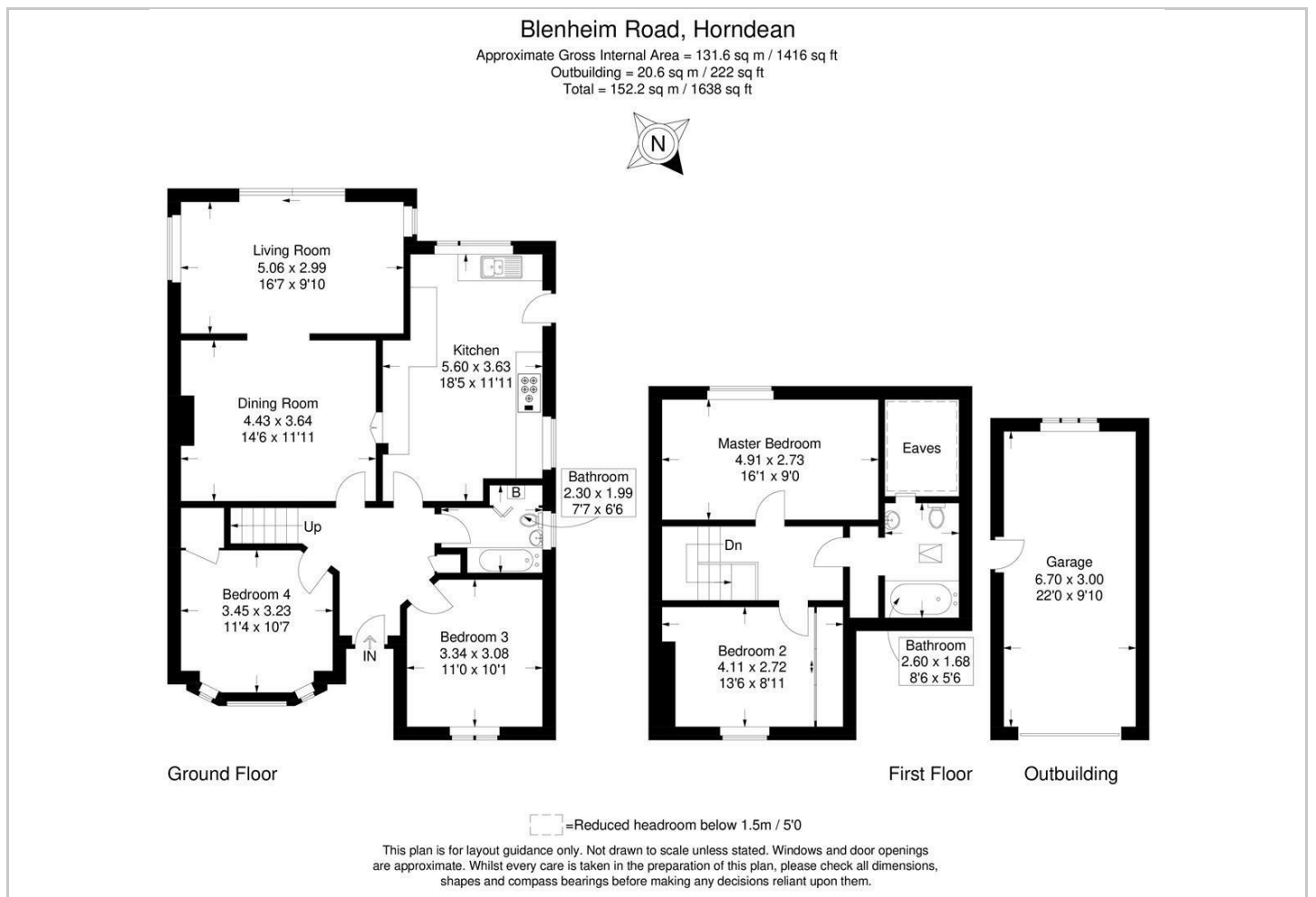

## Viewing

Please contact our Central Office on 02394 217317 if you wish to arrange a viewing appointment for this property or require further information.

## Energy Efficiency Graph

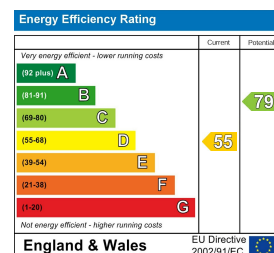

These particulars, whilst believed to be accurate are set out as a general outline only for guidance and do not constitute any part of an offer or contract. Intending purchasers should not rely on them as statements of representation of fact, but must satisfy themselves by inspection or otherwise as to their accuracy. No person in this firm's employment has the authority to make or give any representation or warranty in respect of the property.