



51 SOUTH AUDLEY STREET

Mayfair, London, W1K 2AA

AVAILABLE TO RENT

51 South Audley Street is situated in the heart of Mayfair and is a well connected address with easy access to Bond Street station.

Plug & Play Offices Available in Prime Mayfair. The building provides a range of suites, accommodating anything from 2 to 8 desks.

Features include:

- Manned reception desk
- High ceilings
- Communal areas to be refurbished and modernised
- Plug and Play
- Access to meeting room
- Close proximity to Bond Street Station

51 South Audley Street, Mayfair, W1K 2AA

JOHN D WOOD

Location

51 South Audley Street is located on the western side of the street close to its junction with Mount Street, just south of Grosvenor Square and a 5 minutes walk away from Oxford Street. The surrounding streets offer superb local amenities with members clubs, restaurants, coffee shops, bars and gyms. South Audley Street runs north to south from Grosvenor Square to Curzon Street and is one of Mayfair's most sought after addresses. Bond Street Station is easily accessible and provides access to the Jubilee, Central and Elizabeth lines.

Local Stations

Bond Street Station - 5 minute walk (Central, Jubilee, Elizabeth lines)

Green Park Station - 10 minute walk (Victoria, Piccadilly, Jubilee lines)

Description

Plug & Play Offices Available in Prime Mayfair. The building provides a range of suites, accommodating anything from 2 to 8 desks. There are 6 suites available, with rents of £750 + VAT per desk per month. The suites have recently been refurbished and benefit from good natural light.

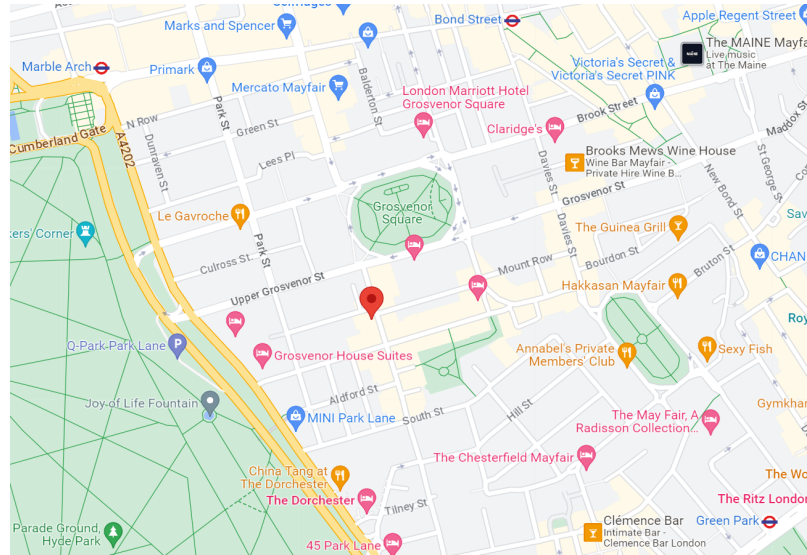

Terms

Available by way of flexible licence, on a per desk or per suite basis.

Further information

For further information, or to arrange an inspection of the property, please contact:

Craig Van Straten

John D Wood

07763 928238

craigvanstraten@johndwood.com

George Cracknell

John D Wood

07384 897647

georgecracknell@johndwood.com



51 South Audley Street, W1

Approximate Gross Internal Area

321 sq m/ 3457 sq ft

Not to Scale, for identification only

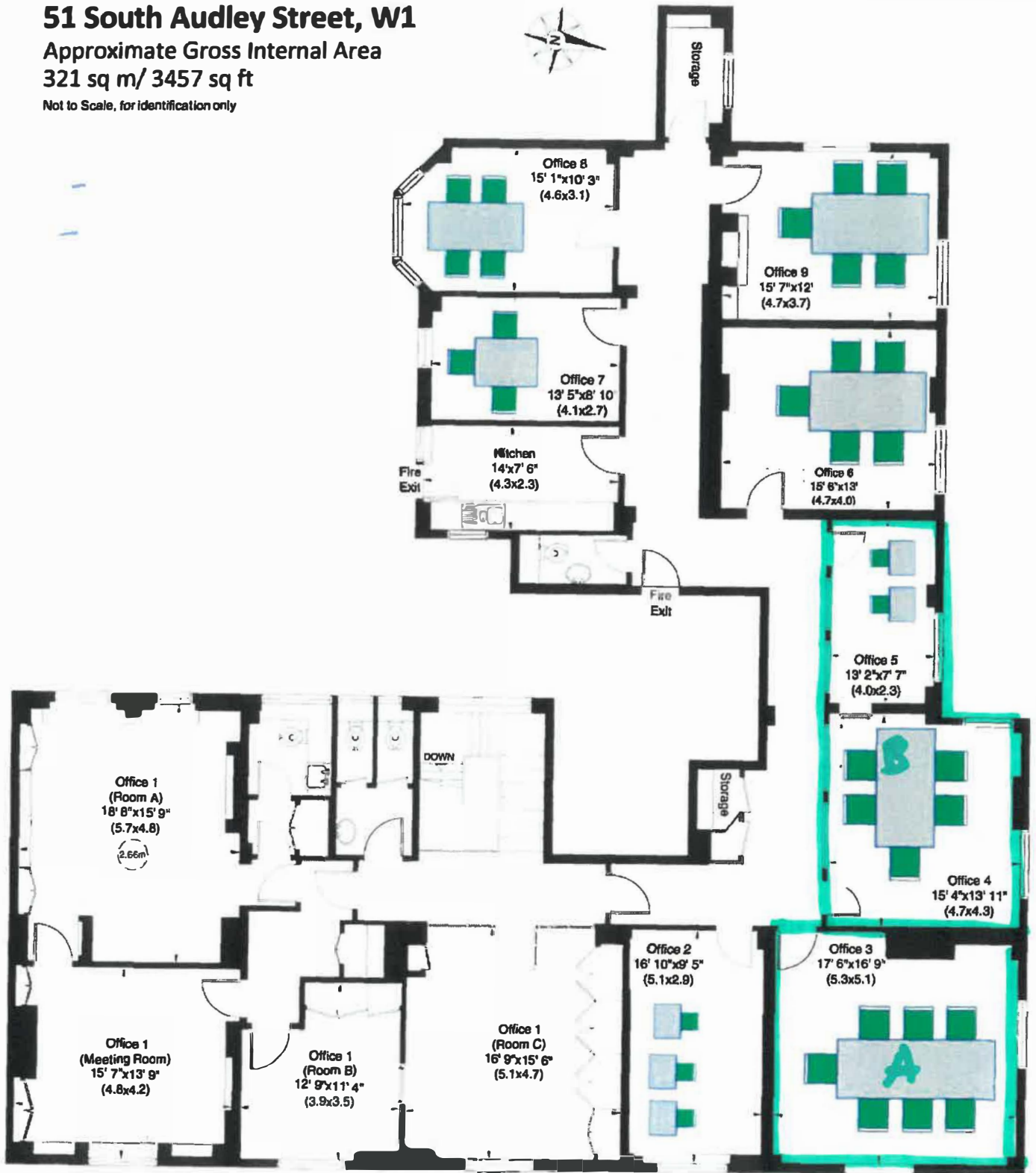

First Floor

07/11/2017 Misrepresentation Act 1967: Conditions under which particulars are issued: Castleplus Ltd trading as John D Wood for themselves and for the vendor of this property, whose agents they are give notice that: 1. These particulars do not constitute, nor constitute any part of, an offer or contract. 2. None of the statements contained in these particulars as to this property is to be relied on as a statement or representation of fact. 3. Any intending purchaser must satisfy himself by inspection or otherwise as to the correctness of each of the statements contained in these particulars. 4. The vendor does not make or give, and neither Castleplus Ltd trading as John D Wood nor any person in their employment has any authority to make or give, any representation or warranty whatever in relation to this property. Property. Misdescription Act 1991: These details are believed to be correct at the time of compilation but may be subject to subsequent amendment. May 2023.