



Forge Cottage, Easby

Price



Here to help you move.

Forge Cottage, Easby

Forge Cottage, a charming rustic gem nestled in the heart of open countryside, stands as a testament to history, dating back to the 1700s. The cottage shares its idyllic location with the adjoining Easby Methodist Chapel, creating a quaint and peaceful atmosphere.

This grade-listed cottage unfolds over three levels, each exuding its own unique charm and character. The bottom floor, once the old forge room, has been transformed into a cosy sitting room. The echoes of its past linger, creating an ambiance that transports you to a bygone era.

Ascending to the middle floor, you'll find a spacious living room with a spiral staircase leading down to the sitting room below. The architectural details and period features seamlessly blend the old with the new, offering a comfortable and inviting space to relax.

The kitchen, a testament to craftsmanship, graces the middle floor. Handcrafted with attention to detail, it adds a touch of rustic elegance to the cottage. The top floor boasts three bedrooms, each with its own unique character, and a convenient shower room for modern comfort.

As you explore the surroundings, panoramic views of the Cleveland Hills unfold, showcasing landmarks like Captain Cook's Monument, The Wainstones, and Carlton Bank in the distance. Nature's beauty becomes a part of everyday life, creating a serene backdrop for this historic dwelling.

Externally, an easy-maintenance garden, allows residents to enjoy the outdoors without the hassle of extensive upkeep. A charming summer house provides a perfect spot to soak in the tranquillity of the surroundings. Completing the ensemble, a practical garage stands ready to accommodate the needs of rural living, offering storage for tools, equipment, and perhaps a vehicle or two.

Forge Cottage is a haven for those yearning to experience the simplicity and charm of rural life, providing a perfect blend of history and modern comfort.





Ground floor

Sitting room

Front aspect secondary glazed Yorkshire sash window and a feature fireplace (previously the furnace to the old forge room) provides an impressive focal point to the room. A spiral staircase provides access to the middle floor living room.

Middle floor

Dining Kitchen

Comprising a range of fitted base and wall units with matching work surfaces. Appliances to include: Belfast sink with mixer tap, "Smeg" electric oven with six ring gas hob (via calor gas) dishwasher and plumbing for washing machine. Front aspect secondary glazed window and a single stable door provides access to the rear garden.

Living room

Dual aspect secondary glazed Yorkshire sash windows and a log burning stove providing a cosy focal point to the room.





Top floor

Bedroom one

Front aspect secondary glazed Yorkshire sash window.

Bedroom two

Front aspect secondary glazed Yorkshire sash window.

Bedroom three

Rear aspect secondary glazed Yorkshire sash window.

Shower room

Traditional style white suite comprising: Shower enclosure with wall mounted electric shower, pedestal wash hand basin and WC.

Externally

A garage and workshop is situated towards the side and rear of the property and provides a very useful storage area.

Rear garden

An easy maintenance rear garden provides a wonderful outside space to relax and enjoy the fabulous countryside surroundings of North Yorkshire. The summerhouse is also included.

General information

Local authority: Hambleton

Council tax band: E Tenure: Freehold



Approx Gross Internal Area
135 sq m / 1457 sq ft

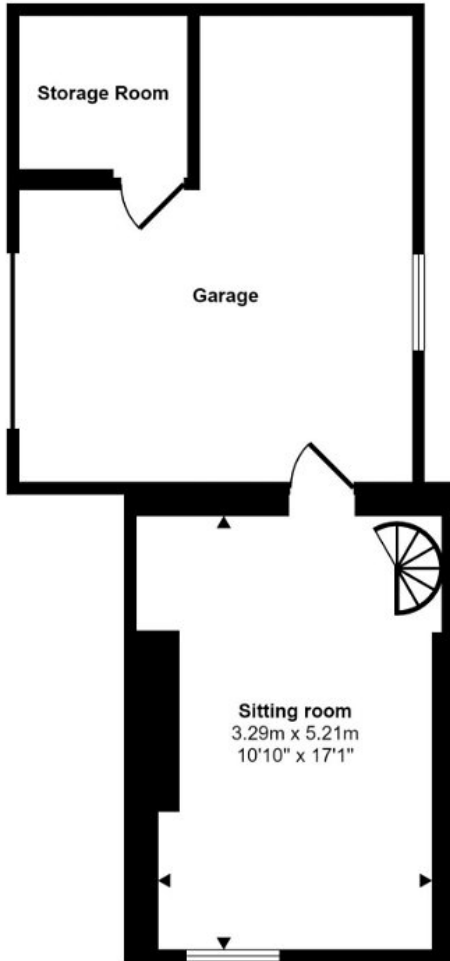

Lower Ground Floor
Approx 47 sq m / 507 sq ft

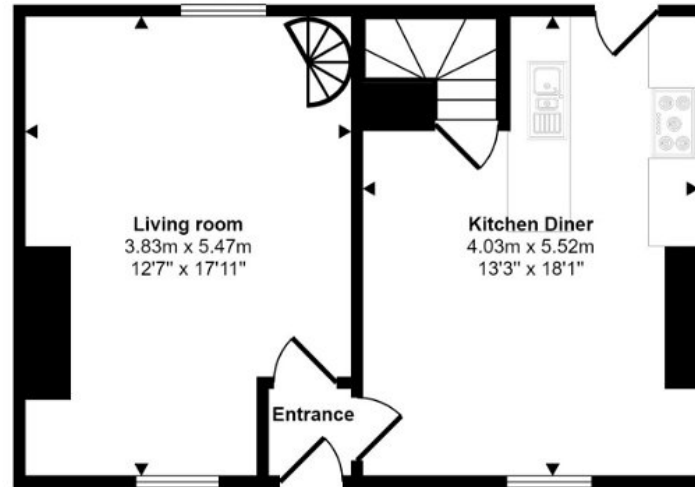

Ground Floor
Approx 44 sq m / 476 sq ft

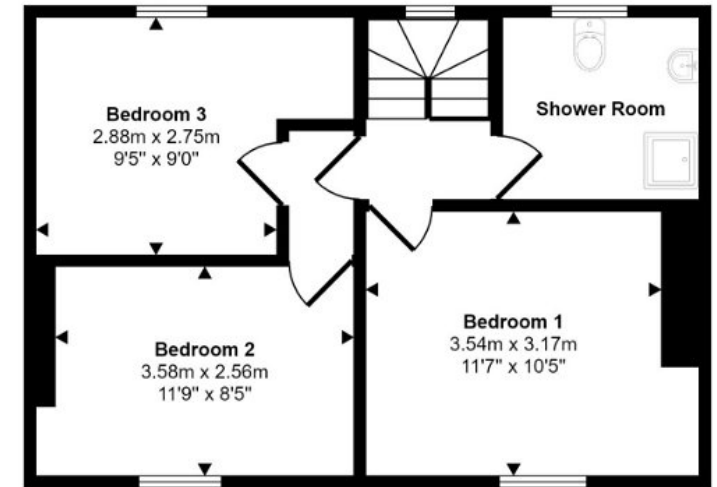

First Floor
Approx 44 sq m / 474 sq ft

This floorplan is only for illustrative purposes and is not to scale. Measurements of rooms, doors, windows, and any items are approximate and no responsibility is taken for any error, omission or mis-statement. Icons of items such as bathroom suites are representations only and may not look like the real items. Made with Made Snappy 360.

📍 26-28 High Street, Stokesley, Middlesbrough, TS9 5DQ

✉️ stokesley@harveybrooks.com

☎️ (01642) 687 223

🌐 www.harveybrooks.com

