



Bankside
Southall, UB1 1NH

- 🏠 Huge Investment/Development Potential (STPP)
- 🏠 Spacious 4-Bed Detached Bungalow
- 🍳 2 Reception Rooms + Fitted Kitchen
- 🛀 Family Bathroom + Separate WC

REDUCED: Offers In Region Of

£649,950

EPC Rating '55'





Property Description

INVESTMENT / DEVELOPMENT OPPORTUNITY - Hiltons Estates brings to the market this Very Spacious Detached Bungalow located in Southall, UB1! The property comprises an entrance porch, 2 living rooms, 4 bedrooms, family bathroom, WC and fitted kitchen. Outside there is a driveway to the front and gardens to the rear and side. Development Opportunity (STPP). This property is an ideal opportunity for large families, INVESTORS and DEVELOPERS! Walking distance to Crossrail, Southall Waterside Development, Southall Broadway and Major Transport links! Call NOW for further details! Not to be missed! Viewings Available! Highly Recommended!





Energy Efficiency Rating		Current	Potential
Very energy efficient - lower running costs			
(92-100)	A		
(81-91)	B		
(69-80)	C		75
(55-68)	D	55	
(39-54)	E		
(21-38)	F		
(1-20)	G		
Not energy efficient - higher running costs			
England, Scotland & Wales		EU Directive 2002/91/EC	

GROUND FLOOR
1039 sq.ft. (96.5 sq.m.) approx.

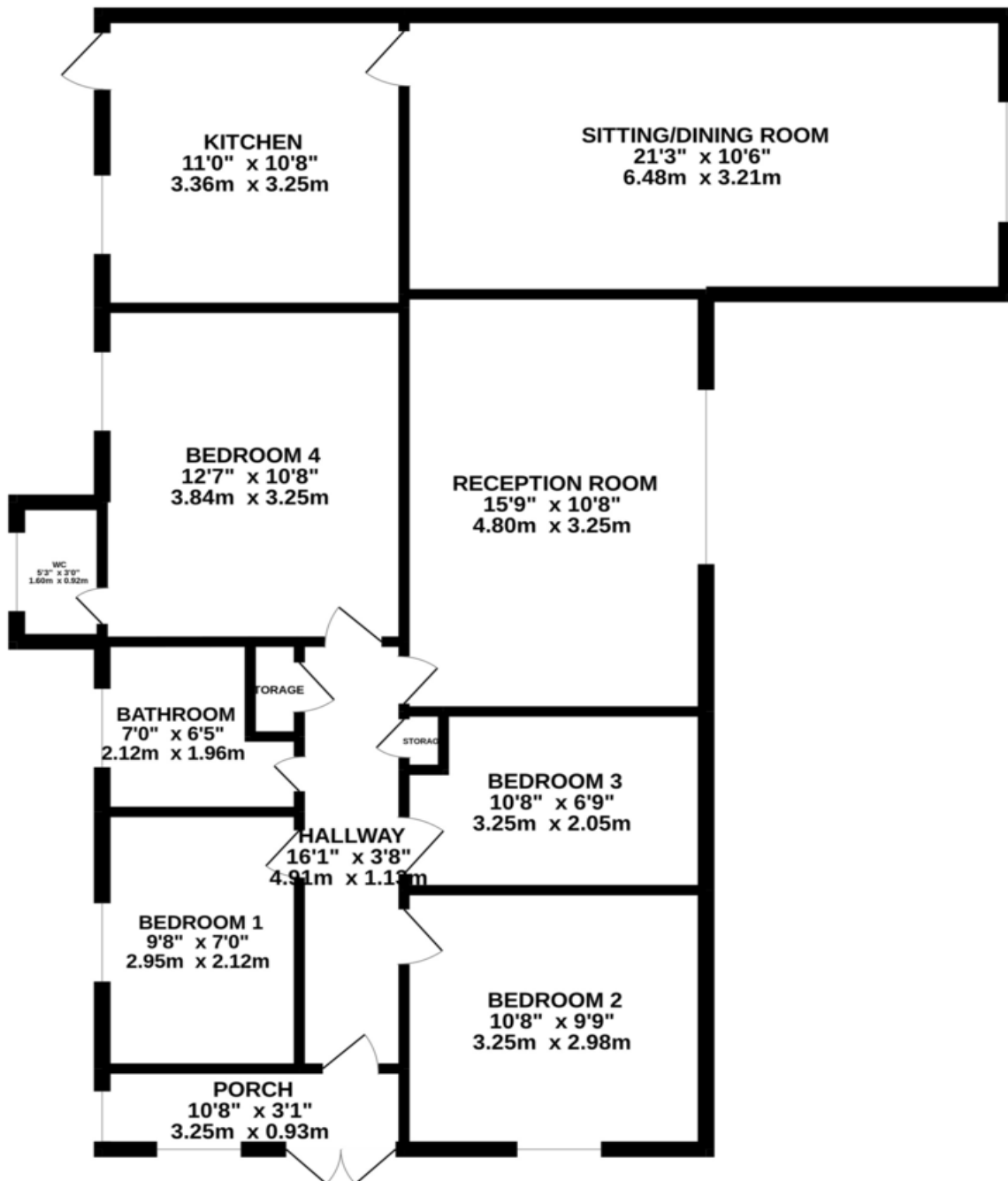

TOTAL FLOOR AREA : 1039 sq.ft. (96.5 sq.m.) approx.

Whilst every attempt has been made to ensure the accuracy of the floorplan contained here, measurements of doors, windows, rooms and any other items are approximate and no responsibility is taken for any error, omission or mis-statement. This plan is for illustrative purposes only and should be used as such by any prospective purchaser. The services, systems and appliances shown have not been tested and no guarantee as to their operability or efficiency can be given.

Made with Metropix ©2022

243 The Broadway
Southall
Middlesex
UB1 1NF

www.hiltons-estates.com
Rajneev@hiltons-estates.com
02085 741 999

Agents Note: Whilst every care has been taken to prepare these sales particulars, they are for guidance purposes only. All measurements are approximate and for general guidance purposes only and whilst every care has been taken to ensure their accuracy, they should not be relied upon and potential buyers are advised to recheck the measurements