



Woodlands Road | Southall | UB1 1EF

£530,000

Hiltons Estates brings to the market this Ideally located 3 bedroom End Of Terrace property in the popular location of Southall, UB1. The property comprises an entrance hallway 2 reception rooms, fitted kitchen with access to the private rear garden. Upstairs, there are 3 Well sized bedrooms and family bathroom. There is further Opportunity to Extend and Develop (STPP). Walking distance to Southall Broadway and Crossrail. Great transport and bus links to Heathrow, Central London, M4, M25 and M40. Call NOW for further details, viewings available. Highly Recommended.



TOTAL APPROX FLOOR AREA 1119.98 SQ. FT. (AREA 104.05 SQ. M)
 Whilst every attempt has been made to ensure the accuracy of the floor plan contained here, measurements of doors, windows, rooms and any other items are approximate and no responsibility is taken for any error, omission or mis-statement. This plan is for illustrative purposes only and should be used as such by any prospective purchaser.

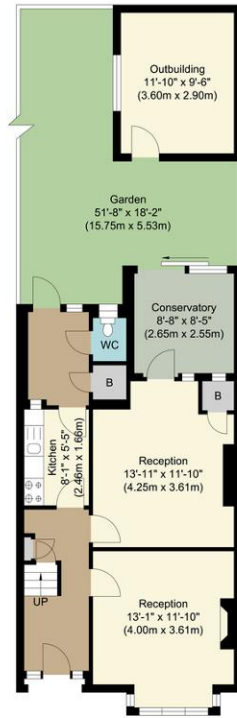

Ground Floor
 Approximate Floor Area
 696.74 sq. ft.
 (64.73 sq. m)

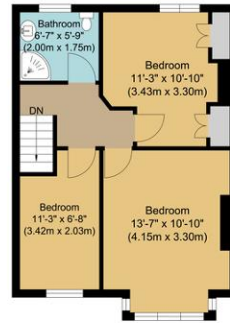

First Floor
 Approximate Floor Area
 423.23 sq. ft.
 (39.32 sq. m)

Contact Details

243 The Broadway

Southall

Middlesex

UB1 1NF

www.hiltons-estates.com

Rajneev@hiltons-estates.com

02085741999

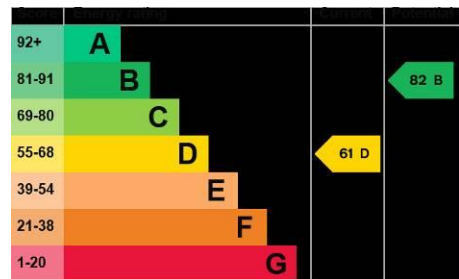

Agents Note: Whilst every care has been taken to prepare these sales particulars, they are for guidance purposes only. All measurements are approximate and for general guidance purposes only and whilst every care has been taken to ensure their accuracy, they should not be relied upon and potential buyers are advised to recheck the measurements