



RESIDE
STOCKPORT



Apt 7 189 Wellington Road North
Heaton Chapel, Stockport, SK4 2PB
Guide Price £220,000



Apt 7 189 Wellington Road North

Heaton Chapel, Stockport, SK4
2PB

Reside Stockport are delighted to present this beautifully appointed top-floor apartment, featuring two generous double bedrooms, a private rear-facing balcony, allocated parking, and a garage.

Ideally situated within easy reach of excellent local amenities and superb transport links, this property offers a perfect blend of comfort and convenience — ideal for commuters travelling into Manchester.

The apartment briefly comprises: a welcoming entrance hall, a spacious open-plan lounge and dining area with sliding doors opening onto the balcony, a stylish modern kitchen, two well-presented double bedrooms, and a contemporary four-piece bathroom suite.

Early viewing is highly recommended to avoid disappointment!

- Top Floor Apartment
- Balcony To The Bar
- Two Double Bedrooms
- Beautifully Presented





- 1 Car Parking Space
- Garage Included To Rear
- Modern Kitchen
- Spacious Lounge

Floor Plan

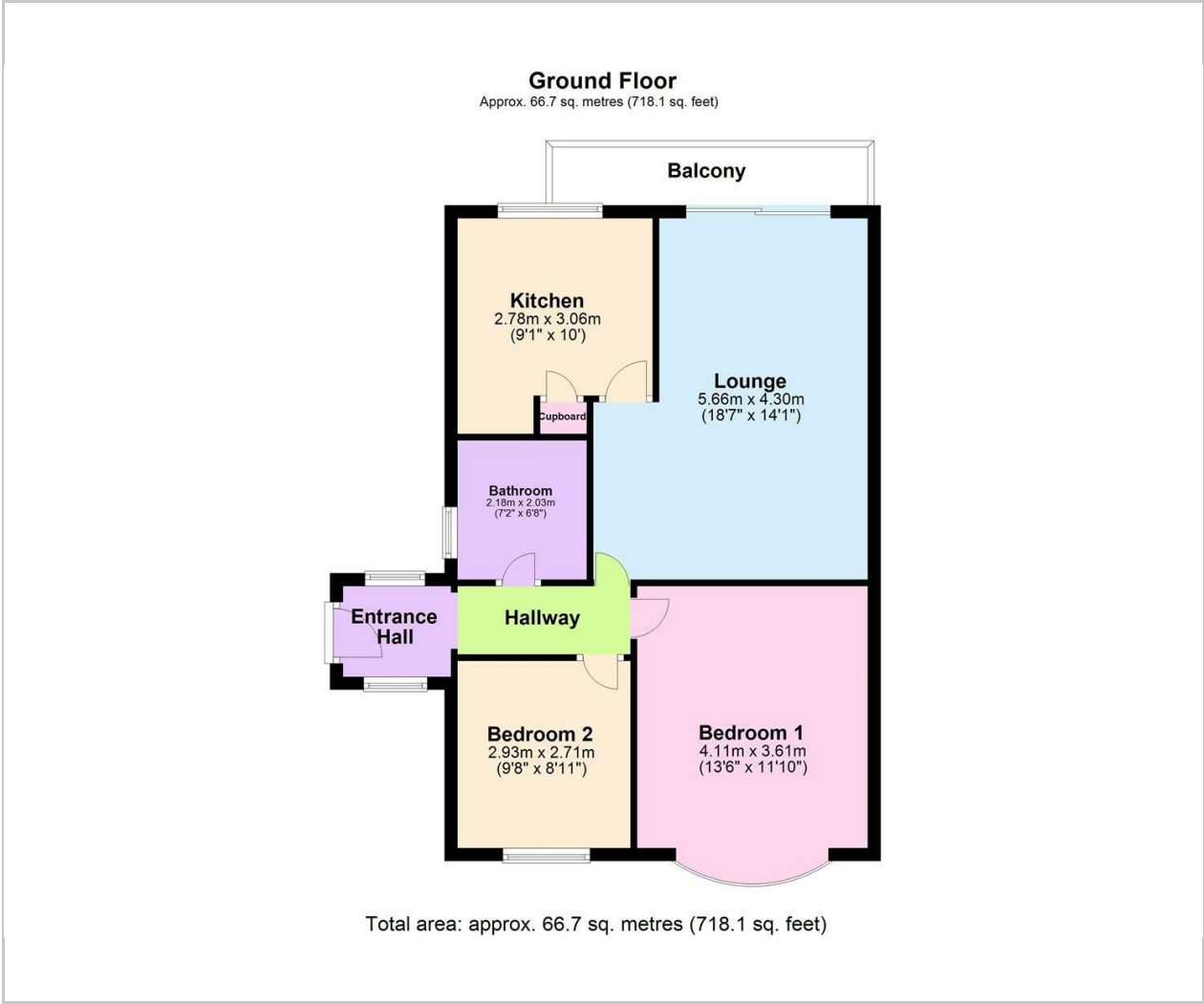

Viewing

Please contact our Reside Stockport Office on 0161 808 0660 if you wish to arrange a viewing appointment for this property or require further information.

These particulars, whilst believed to be accurate are set out as a general outline only for guidance and do not constitute any part of an offer or contract. Intending purchasers should not rely on them as statements of representation of fact, but must satisfy themselves by inspection or otherwise as to their accuracy. No person in this firms employment has the authority to make or give any representation or warranty in respect of the property.

Area Map

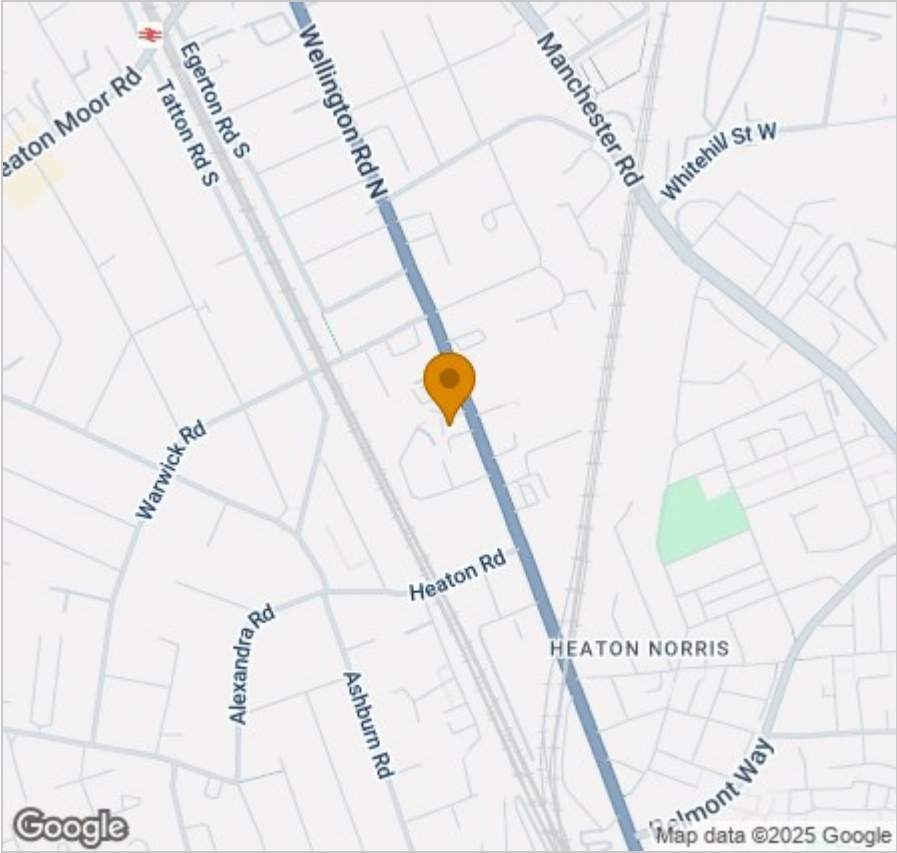

Energy Efficiency Graph

