



Middlefield Lane, Henlow, Bedfordshire, SG16 6PJ

£1,250,000

🛏 5 🚿 4 🛋 4



Introducing Cedar Cottage, an exquisite and generously proportioned family home nestled in the idyllic and highly sought-after village of Henlow. This distinguished five-bedroom, four-bathroom detached residence spans over 2,795 square feet of light-filled, contemporary living space. Set on an expansive plot, it features a collection of substantial outbuildings offering exceptional potential for additional development or business ventures.





Key Features

- Five Double Bedrooms
- Desirable Village Location
- Countryside Views
- Wine Cellar
- Substantial Plot With Scope For Development Opportunities STPP
- Two En-Suite Bathrooms
- Private Balcony
- Must See Property
- Multiple Outbuildings Ideal for Business Ventures
- Home Office, Entertainment Rooms And Private Bar

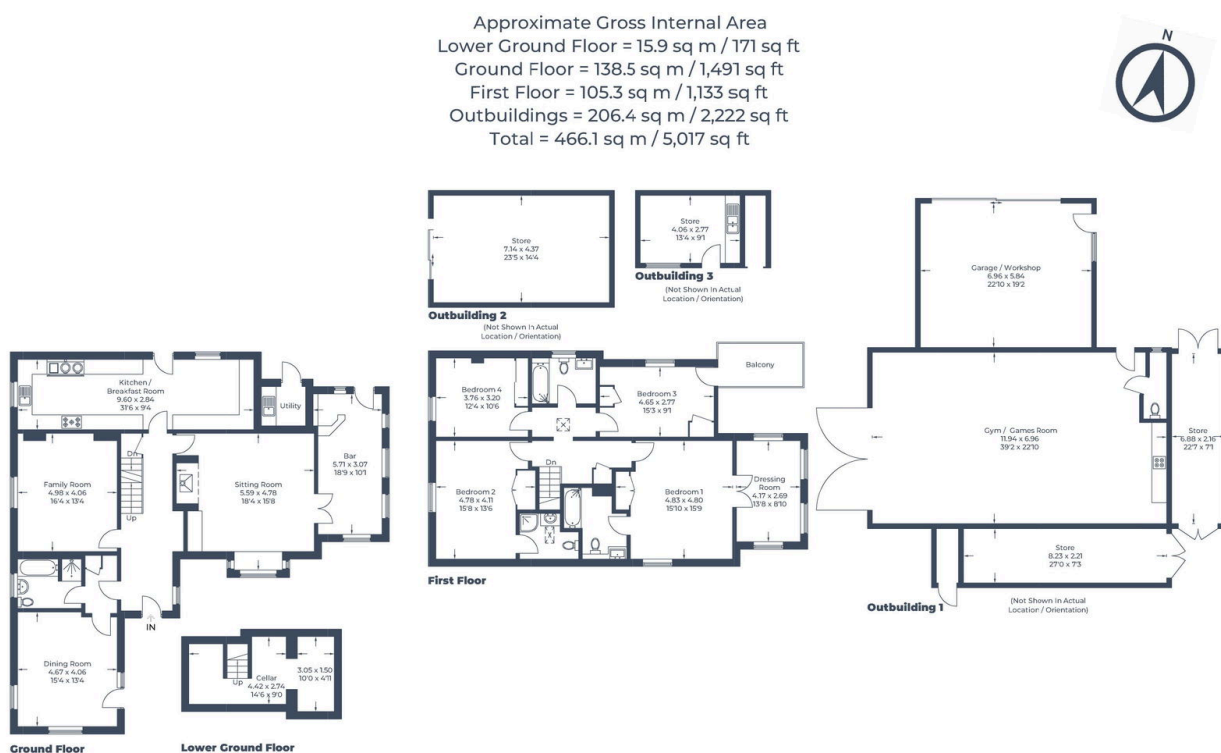

Illustration for identification purposes only,
 measurements are approximate, not to scale.
 © CJ Property Marketing Produced for Signature Property Partners

