

# THE ROCHESTER

Camden



2,400 - 8,750 SQ FT.



The Rochester







## DESCRIPTION

The Rochester offers tranquil workspace within walking distance to the vibrancy of Camden. Benefitting from a shared landscaped rear garden as well as secure underground parking. The Rochester offers a great working environment for any business looking for a Central location with ease of access. The first floor office benefits from good proportions and being fitted with 2 meeting rooms as well as a phone booth and fitted kitchen.

## HIGHLIGHTS

- Best In Class Offices In Camden
- Modern Building with Impressive Entrance
- Private Underground Parking
- Fitted With Meeting Rooms
- Tranquil Communal Landscaped Garden
- Bike Storage
- Passenger Lift
- Air-Conditioning
- Demised Kitchens
- Excellent Ceiling Height
- Communal Shower Facilities
- Phone Booth (First Floor)
- Potential For Dedicated Private Entrances (Ground Floor Units)
- Communal BBQ
- Car Parking In Secure Underground Basement with EV Charging Points

## CONNECTIVITY

Fibre is already installed in each demise.

## LEASE

New lease(s) are available.

## USE

Class E - Suitable for offices, medical and educational uses.

## VIEWINGS

We believe a property is best seen in person - contact us for a viewing, so we can walk you through how great this space is.

## WHEN CAN YOU MOVE IN?

Immediately, subject to contract.

## VAT

The building is elected for VAT.

## DDA COMPLIANCE

If you have any questions about disabled access suitability, please do reach out to us.

## PHOTOGRAPHY

Our marketing includes virtual furnishing to help visualise a fitted and occupied second floor office. This is for indicative purposes only.

## COMMUTE

Camden Road - 2 mins

Camden Town - 9 mins

Kentish Town West - 11 mins

Kentish Town - 12 mins

## PARKING

Car parking is available in the secure underground basement with EV charging Points

## FOODIE HOTSPOTS

- Casa Tua - De Gusto

- Camden Market - Albion's

## LIQUID LUNCH

- Old Eagle Pub - Bucks Head

- The Hawley Arms - Tapping The Admiral

## A STRETCH AWAY

- Pure Gym Camden - F45 Camden

- RUMBLE Primrose - Yoga Base

## FURTHER INFORMATION

EPC & other reports are available upon request.



Schedule of Accommodation

Demise	sq ft	Rent	Rates Payable	Service charge	Total month	Total year	Availability
1st	2,400	£105,000 /annum	£49,525 /annum	£18,000 /annum	£14,377.08	£172,525	Available
Ground - Suite 1	3,650	-	On Application	On Application	-	-	Coming Soon
Ground - Suite 2	2,700	-	On Application	On Application	-	-	Coming Soon
<b>Total</b>	<b>8,750</b>				<b>£14,377.08</b>	<b>£172,525</b>	



**HARRISON  
EAGLES**

DD: 0207 290 0599  
M: 07940 930 930  
E: harrison@ldg.co.uk



**DANIEL  
CASTLE**

DD: 0207 290 0590  
M: 07502 224 861  
E: daniel@ldg.co.uk



**HARRY  
ISAACS**

DD: 0207 291 0993  
M: 07756 873 842  
E: harry.i@ldg.co.uk



**PAUL  
STONE**

DD: 0207 482 1203  
M: 07973 845 462  
E: paul.stone@christo.co.uk

Ready to talk?

© Copyright  
 This drawing is the Copyright of FIDUCIA INTERIORS LIMITED. It may not be reproduced in part or in whole without written permission. DO NOT SCALE FROM THIS DRAWING. All dimensions to be checked on site before work commences. SUBJECT TO BUILDING REGULATIONS, FIRE REGULATIONS AND STATUTORY APPROVALS. This drawing is only to be used in conjunction with drawing notes & specification prepared by FIDUCIA INTERIORS LTD to be in keeping with the C.D.M. regulations 1994.

- STATUS**
- Preliminary/Info.
  - Contract
  - Construction
  - Approval
  - As-Built
  - Building Control

**DRAWING APPROVAL**

Client Sign	
Print name	
Fiducia name	
Date	
Spec Ref	

**REVISION DETAIL**

REV	DETAIL	BY	DATE

**CLIENT**  
 Rochester Mews

**PROJECT DETAIL**  
 26-28 Rochester Place  
 London, NW1 9JR  
**DRAWING TITLE**  
 PROPOSED FIRST FLOOR  
 GA LAYOUTS

DATE	DRW BY
06.08.2020	BL
SCALE	CHK BY
1:100@A3	SR
PROJECT REF	REV
0230	F

DRAWING No  
**0230 - 002 PR GA**

Fiducia Interiors Ltd  
 28 Bolton Street  
 LONDON  
 W1J 8BP

TEL : 020 7751 9966  
 WEB : www.fiduciainteriors.com

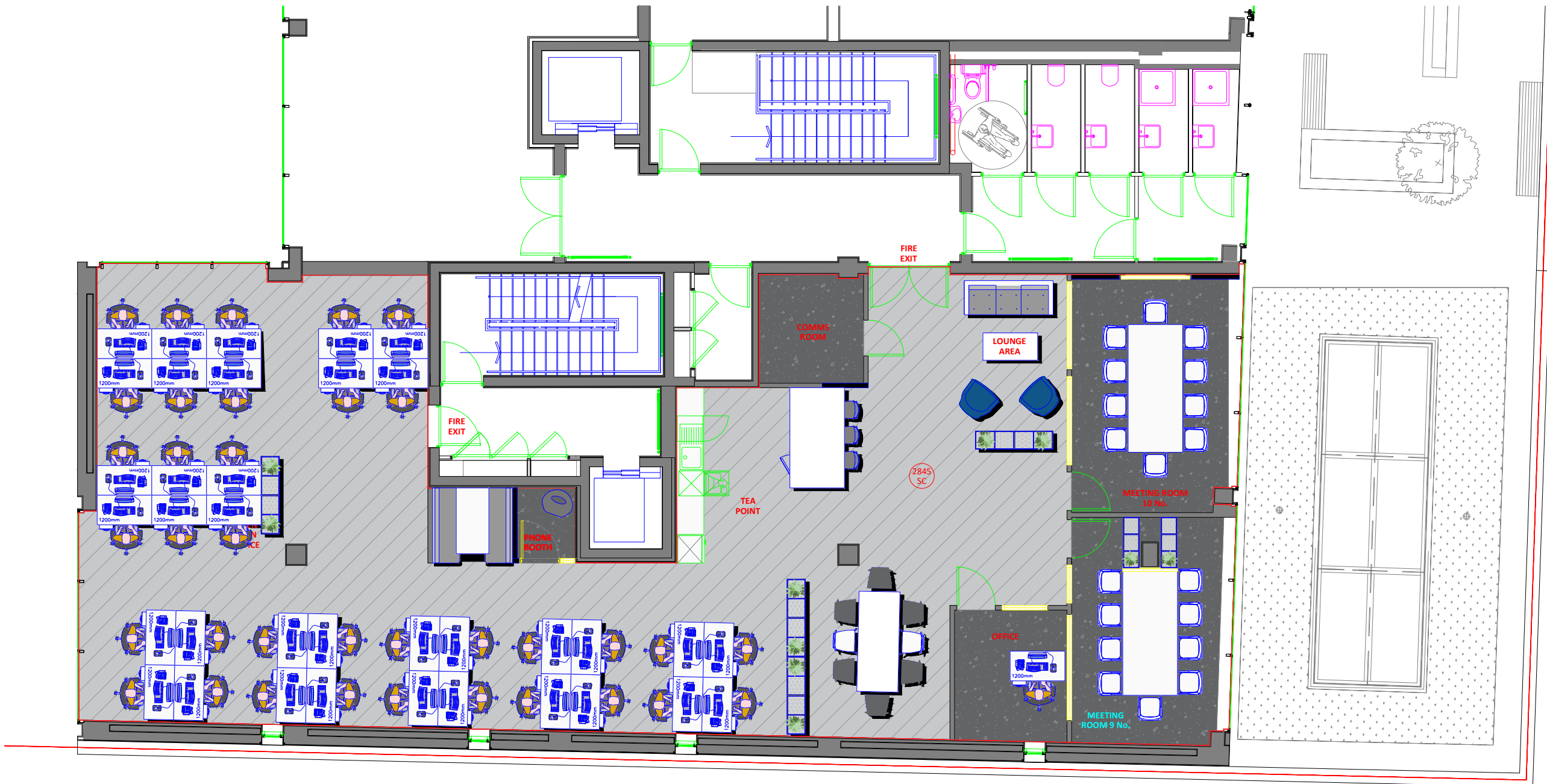

**1 FIRST FLOOR PROPOSED LAYOUT**  
 Scale: 1:100

