



Dreadnought Court

247 Lower Road, SE8

Asking Price £450,000

A stylish one-bedroom apartment set on the second floor of Dreadnought Court, a modern development built in 2015 by Asra Homes.

The property offers a bright open-plan living space with a contemporary fitted kitchen, a spacious double bedroom, sleek modern bathroom, and a private balcony. Residents also benefit from access to a communal rooftop terrace with stunning city views.

CHESTERTONS



Dreadnought Court

247 Lower Road, SE8

- One Bedroom
- Second Floor
- Leasehold
- Private Balcony
- Sleek, Modern
- Double Bedroom
- Communal Rooftop Facilities
- Local Transport Links
- Local Amenities



We are proud to present this elegant and contemporary one-bedroom apartment, ideally positioned within the striking Dreadnought Court development built in 2015 by Asra Homes and located on the historic site of the former Chestertons Estate Agents. Just 175 yards from Surrey Quays Overground Station, this second-floor residence offers a rare opportunity to enjoy modern city living with excellent connectivity and comfort.

Beautifully presented throughout, the property features a bright and spacious open-plan living area that seamlessly integrates a fully fitted modern kitchen, complete with sleek finishes and high-quality appliances. The generously sized double bedroom provides a peaceful retreat, while the stylish bathroom offers a calming, spa-like atmosphere. A private balcony extends the living space outdoors perfect for relaxing or enjoying the vibrant surroundings.

Tenure: Leasehold 115 years

Service Charge: £1644

Ground Rent: £0

Local Authority: London Borough of Southwark

Council Tax Band: B

Score	Energy rating	Current	Potential
92+	A		
81-91	B	87 B	87 B
69-80	C		
55-68	D		
39-54	E		
21-38	F		
1-20	G		

Chestertons Surrey Quays Sales

2 Plough Way

London

SE16 2EU

+44 (0)20 7378 0644

[chestertons.co.uk](https://www.chestertons.co.uk)

Dreadnought Court, SE8

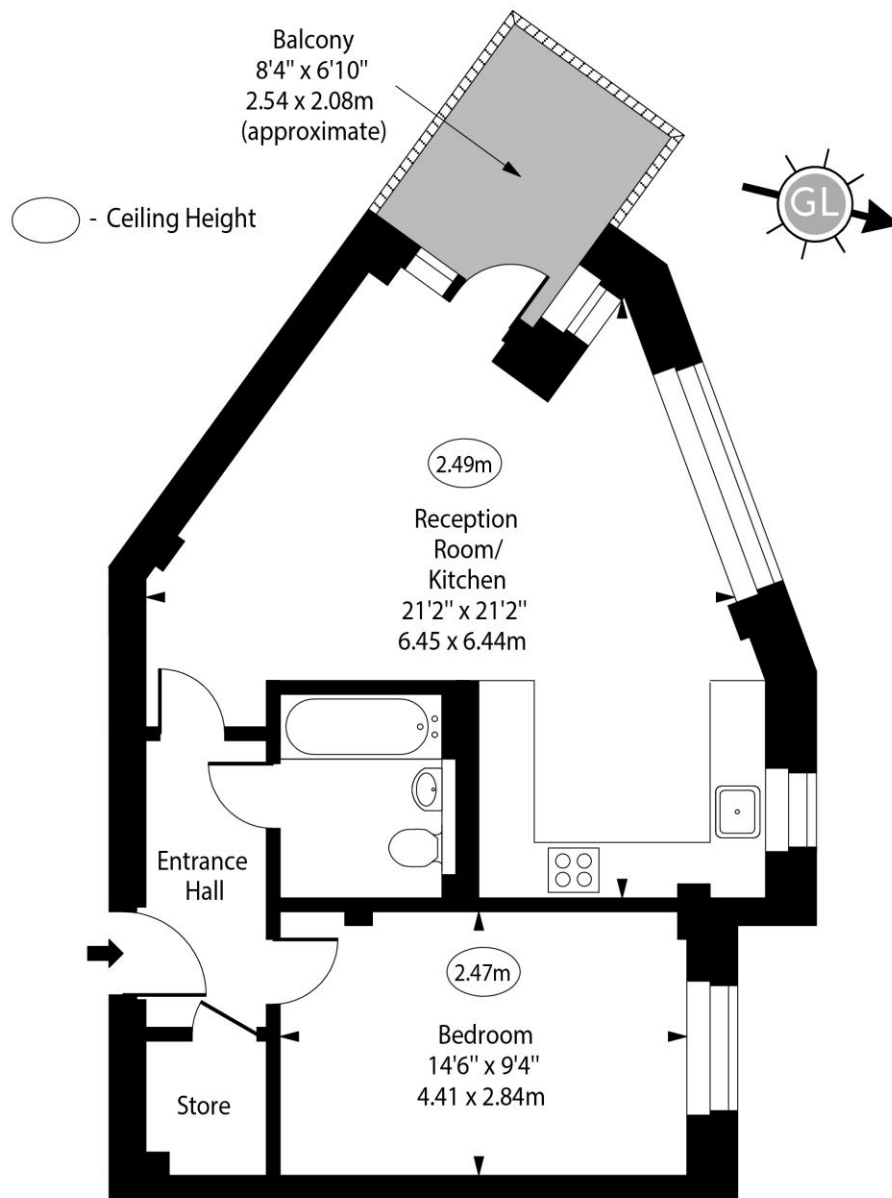

Second Floor

Approx Gross Internal Area 580 Sq Ft - 53.88 Sq M

Every attempt has been made to ensure the accuracy of the floor plan shown.
However, all measurements, fixtures, fittings, and data shown are approximate interpretations and
Measured according to the RICS

For Illustration Purposes Only - Not To Scale

www.goldlens.co.uk

Ref. No. 028623J

