

BRUNTON

RESIDENTIAL



ROTHBURY DRIVE, ASHINGTON, NE63

£159,950

BRUNTON

RESIDENTIAL





BRUNTON

RESIDENTIAL





THREE BEDROOMS – SEMI-DETACHED HOME – OFF-STREET PARKING

Brunton Residential are delighted to offer for sale this well-presented three-bedroom semi-detached home, located on Rothbury Drive in Ashington.

This property features three well-proportioned bedrooms, a spacious lounge, a well-equipped kitchen, a modern bathroom, and off-street parking for two vehicles.

Ashington is a well-connected town offering a range of amenities including shops, schools, parks, and leisure facilities, and excellent transport links to surrounding areas.

BRUNTON

RESIDENTIAL



BRUNTON

RESIDENTIAL

Upon entering the property, you are welcomed into a hallway with wood-effect flooring and stairs leading to the first floor landing. To the left, there is access to a convenient ground floor WC, while to the right, you enter a spacious lounge featuring a bay window and a useful understairs storage unit.

To the rear of the property, the kitchen/diner with sliding doors opening out onto the rear garden and laminate flooring underfoot. The kitchen is well-equipped with a range of floor and wall units, granite worktop surfaces, integrated appliances including an oven, hob, and extractor fan, as well as space for additional appliances. A window overlooking the rear garden and ample room for a dining table complete the space.

Upstairs, the first floor provides access to three well-proportioned bedrooms, two of which are comfortable double rooms. A family bathroom serves the floor, fitted with a bath, overhead shower, washbasin, and WC. There is also an additional storage on the landing.

Externally, the property offers off-street parking to the front. To the rear, there is an enclosed garden, mainly laid to lawn, with a raised decked seating area.



BRUNTON

RESIDENTIAL

TENURE : Freehold

LOCAL AUTHORITY : Northumberland
County Council

COUNCIL TAX BAND : B

EPC RATING : C

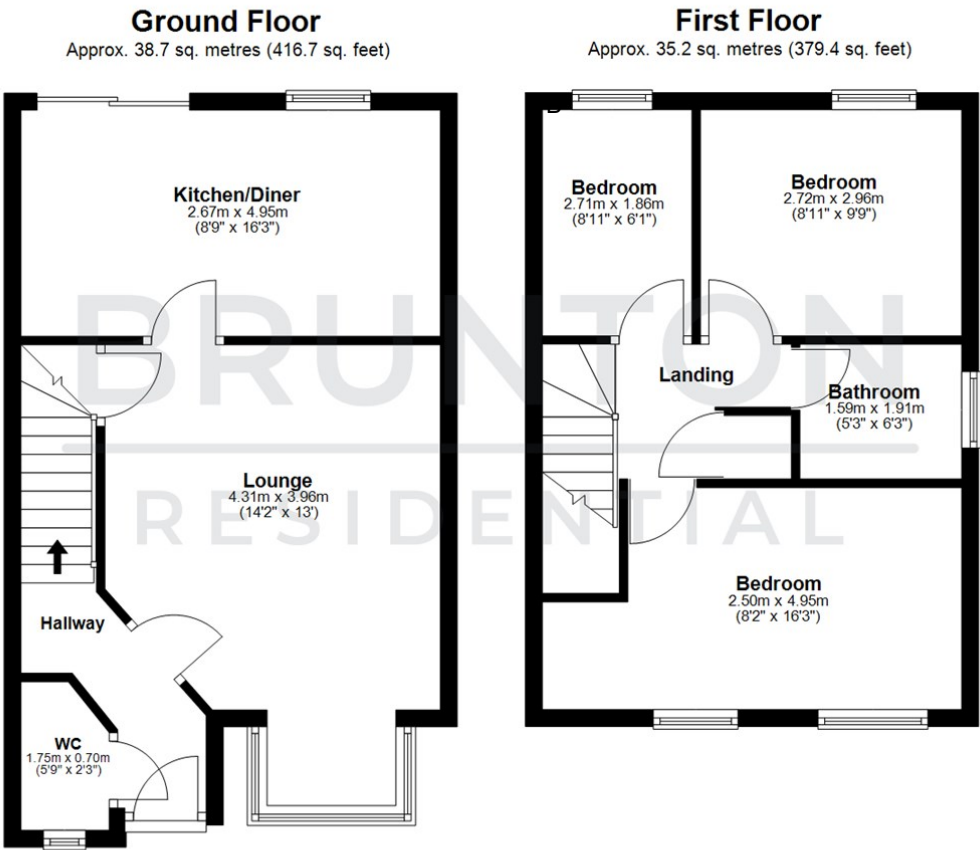

All measurements are approximate and are for illustration only.
Plan produced using PlanUp.

