



Northwick Avenue, Worcester, WR3 7AT

**SHELDON
BOSLEY
KNIGHT**

LAND AND
PROPERTY
PROFESSIONALS

Property Description

****DEPOSIT ALTERNATIVE OPTION AVAILABLE****

A property of timeless elegance, this property is located in the Barbourne Works complex. There is a spacious, open plan lounge/kitchen area, with the fully fitted kitchen benefitting from integrated washing machine, fridge/freezer, dishwasher and oven/hob. There are two double bedrooms and the bathroom with a three piece bathroom suit with shower over bath and heated towel rail. Externally the property offers an allocated parking space. Located close to Worcester City Centre and its amenities.





Key Features

- Close to Worcester City Centre
- Ground Floor Apartment
- Open Plan Living
- Modern Kitchen with Appliances
- Two Bedrooms
- Modern Bathroom
- Allocated Parking
- EPC Rating: D
- Council Tax Band: B

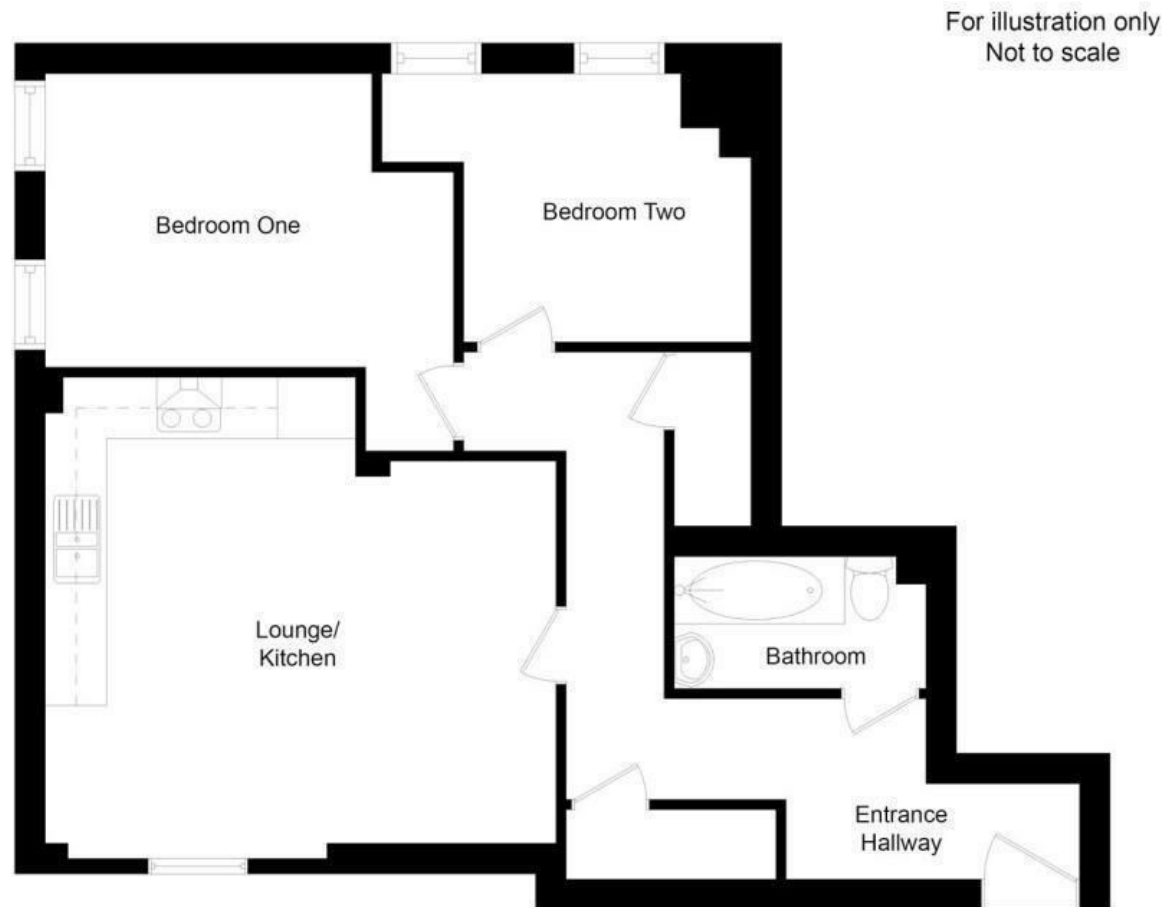

£850 PCM