



**Handley Street, Leicester, LE2 8RA**

**Asking price £230,000**

**Freehold**

---

**Taylors**

Est. 1992

---



Spacious and modern three-bedroom home  
Private rear courtyard  
Two reception rooms  
Close to local amenities  
Large master bedroom  
Three-piece family bathroom  
Please get in touch to arrange your visit

#### Property description

<b>Reception room</b>	11'9" x 11'5" (3.60 x 3.50)
<b>Living room</b>	11'11" x 11'9" (3.65 x 3.60)
<b>Kitchen</b>	12'9" x 5'10" (3.91 x 1.80)
<b>Master bedroom</b>	13'4" x 12'0" (4.08 x 3.66)
<b>Bedroom two</b>	12'2" x 6'0" (3.73 x 1.83)
<b>Bedroom three</b>	9'7" x 6'5" (2.93 x 1.96)
<b>Bathroom</b>	9'7" x 5'3" (2.93 x 1.61)

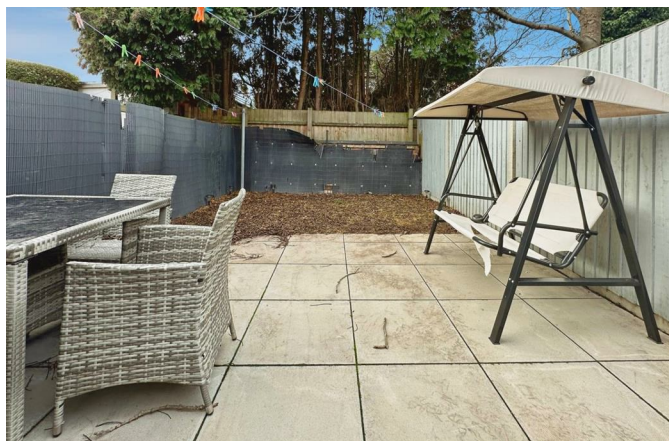



Spacious three-bedroom home | Private rear garden | Two reception rooms | Modern fitted kitchen | Ideal family home | Close to local amenities | Please get in touch to arrange your visit!

This charming three-bedroom home on Handley Street in Leicester offers a well-balanced layout, making it an excellent choice for first-time buyers. The ground floor features two generous reception spaces, providing flexibility for both living and dining arrangements. The front reception room leads

through to a bright and spacious living room, which in turn flows into a modern, efficiently arranged kitchen at the rear of the property. The overall layout creates a practical and inviting ground-floor living environment.

Upstairs, the home offers three bedrooms, making it suitable for couples, small families, or anyone needing additional space for guests or a home office. The main bedroom is particularly spacious, spanning the full width of the house, while the two additional bedrooms provide versatility. The

first floor also includes a well-appointed bathroom positioned conveniently off the landing.

Situated close to local amenities, shops, and transport links, the property combines comfort with everyday convenience. Its manageable size, practical layout, and sought-after location make it an ideal opportunity for first-time buyers looking to step onto the property ladder in a popular Leicester neighbourhood.







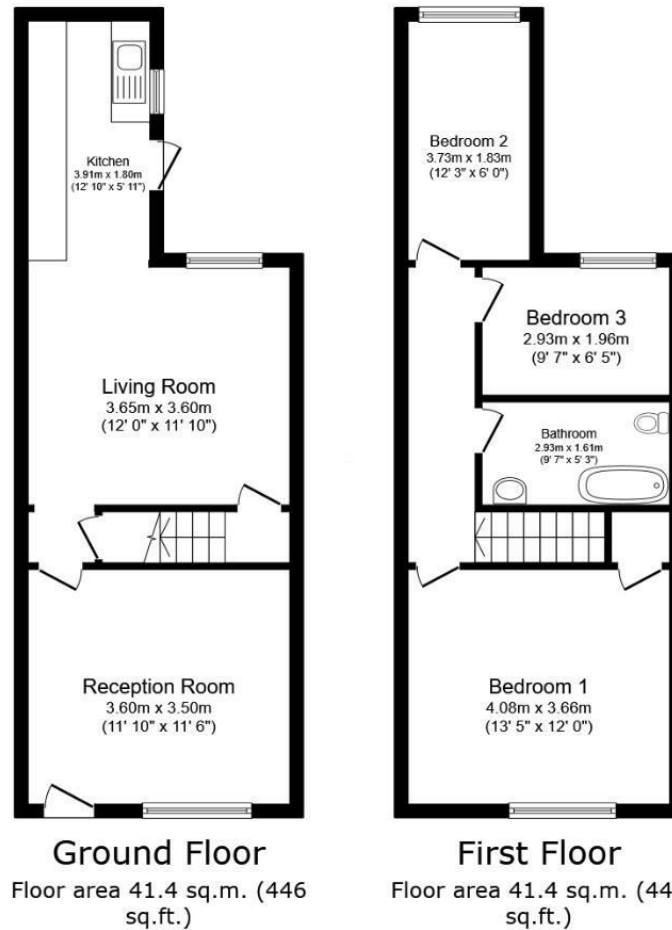

Total floor area: 82.8 sq.m. (892 sq.ft.)

This floor plan is for illustrative purposes only. It is not drawn to scale. Any measurements, floor areas (including any total floor area), openings and orientations are approximate. No details are guaranteed, they cannot be relied upon for any purpose and do not form any part of any agreement. No liability is taken for any error, omission or misstatement. A party must rely upon its own inspection(s). Powered by [www.Propertybox.io](http://www.Propertybox.io)

**Taylor's 1992 Ltd**  
**6 Grove Court, Grove Business Park, Enderby, LE19 1SA**  
**T: 0116 326 6464**  
**E: [hello@taylorsestate.agency](mailto:hello@taylorsestate.agency)**

Agents Note: Whilst every care has been taken to prepare these sales particulars, they are for guidance purposes only. All measurements are approximate and for general guidance purposes only and whilst every care has been taken to ensure their accuracy, they should not be relied upon and potential buyers are advised to recheck the measurements.

**Taylor's**  
 Est. 1992